



## St. Georges Grove, SW17

£425,000

A modern built two bedroom, two bathroom apartment with secure private parking.

- Two Bedrooms
- Two Bathrooms
- Modern Development
- Allocated Parking Space
- Ground Floor
- Sought After Location



Accommodation comprises: an entrance hall with spacious bathroom, two generous bedrooms, the master bedroom benefiting from an modern en-suite bathroom, kitchen open plan to a reception/dining room.

St Georges Grove is located within close proximity to Earlsfield Station as well as the popular bars and restaurants of Garratt Lane. Further benefits of the development include on site shopping facilities, allocated parking and bus links into Clapham Junction, and Tooting Broadway.



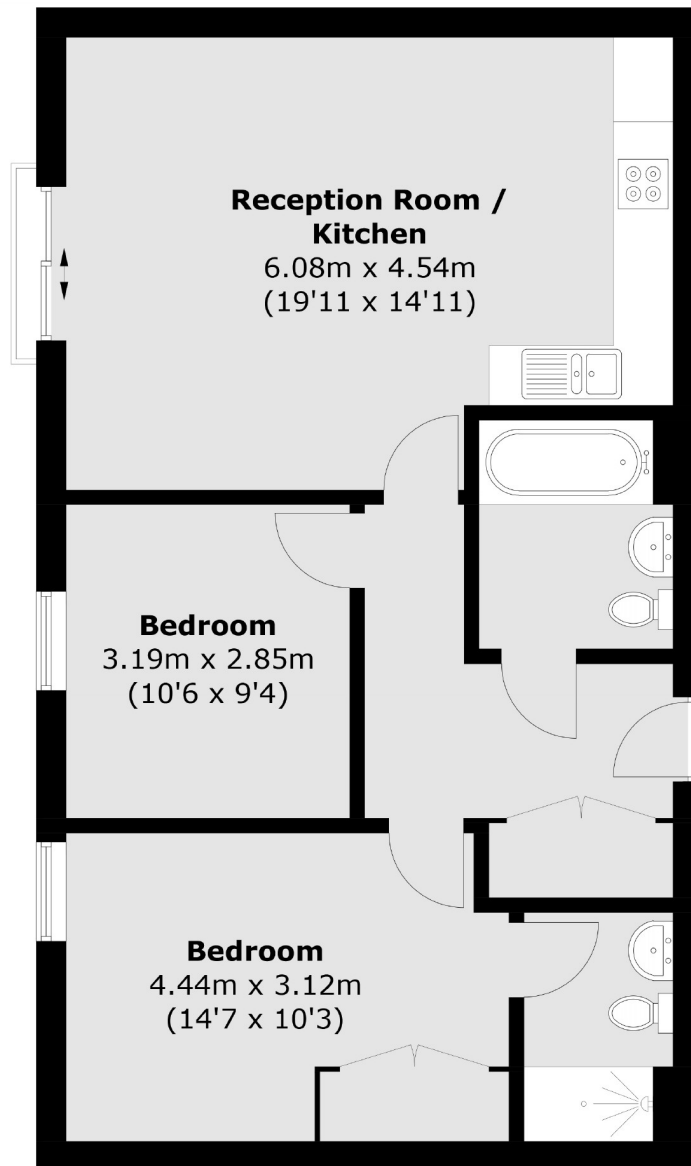

Total area (approx.): 68.1 sq. m (733.0 sq. ft)

Jacksons Earlsfield  
372-374 Garratt Lane  
Earlsfield  
London  
SW18 4ES  
020 8971 7979

Energy Rating: B We aim to make our particulars both accurate and reliable. However they are not guaranteed; nor do they form part of an offer or contract. If you require clarification on any points then please contact us, especially if you're traveling some distance to view. Please note that appliances and heating systems have not been tested and therefore no warranties can be given as to their good working order.