



Algarve Road, SW18

£675,000

A beautifully presented ground floor two double bedroom Victorian conversion flat with large private garden.

- Two Double Bedrooms
- Victorian Conversion Flat
- Ground Floor
- Large Private Garden
- Share of Freehold
- Sought After Location



Accommodation comprises; generous reception room with feature fireplace and double glazed sash windows, well presented double bedroom with built in storage, a large useful cellar, modern luxury bathroom, large master bedroom with built in wardrobes and double doors leading to a courtyard, stylish and superbly presented kitchen benefitting from abundance of light, bi fold doors lead out to a large low maintenance private garden. The property has a share of the freehold and is in excellent condition with a contemporary finish throughout.



Algarve Road is part of a grid of quiet residential roads of similar style of properties, which are consistently sought after being an extremely short distance of central Earlsfield. This location is very well served by excellent transport links, restaurants, bars, leisure and shopping facilities all within close proximity of the property. Earlsfield mainline station is a distance of 0.2 mile.





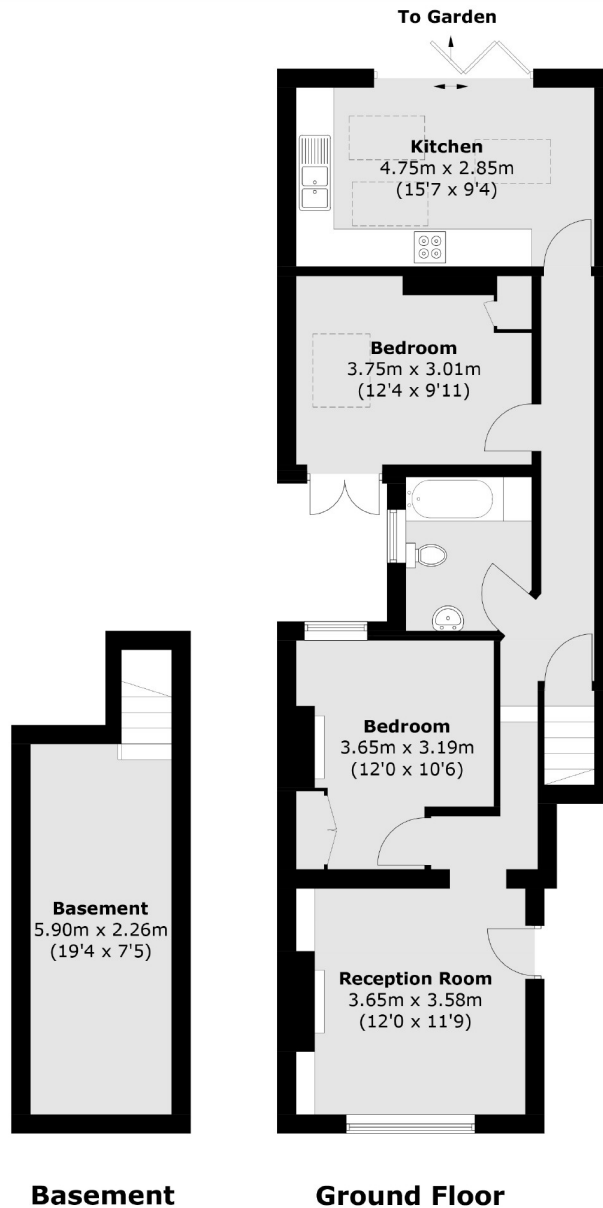

Total area (approx.): 82.4 sq. m (886.9 sq. ft)
(Including Basement)

Jacksons Earlsfield
372-374 Garratt Lane
Earlsfield
London
SW18 4ES
020 8971 7979

Energy Rating: We aim to make our particulars both accurate and reliable. However they are not guaranteed; nor do they form part of an offer or contract. If you require clarification on any points then please contact us, especially if you're traveling some distance to view. Please note that appliances and heating systems have not been tested and therefore no warranties can be given as to their good working order.