



Delia Street, SW18

£500,000

A well presented ground floor Victorian apartment with eat-in kitchen and modern bathroom.

- Two Bedrooms
- Eat-In Modern Kitchen
- Excellent Condition
- Ground Floor
- Shared Garden
- Sought After Location



The apartment is in very good condition with a contemporary finish throughout whilst retaining a wealth of character and period features. Accommodation comprises; an entrance hall, stylish and superbly presented reception room, large double bedroom, very useful second bedroom/study, a refitted kitchen with space for dining, modern bathroom and a well maintained and generous shared rear garden.

Delia Street is part of a grid of quiet residential roads of similar Victorian purpose built apartments, which are consistently sought after being equidistant from Earlsfield and Wandsworth Town. This location is very well served by excellent transport links, restaurants, bars, leisure and shopping facilities all within close proximity of the property.



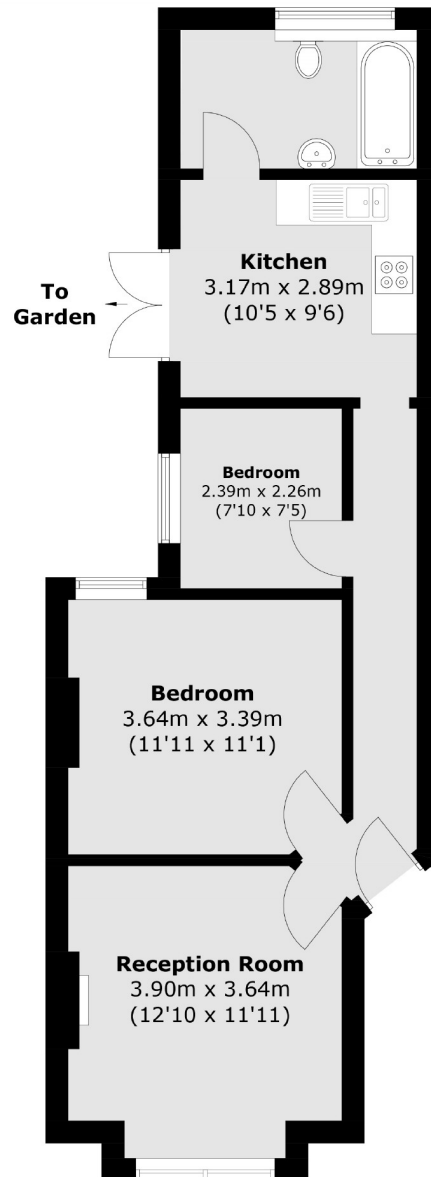

Total area (approx.): 54.4 sq. m (585.6 sq. ft)

Jacksons Earlsfield
372-374 Garratt Lane
Earlsfield
London
SW18 4ES
020 8971 7979

Energy Rating: C We aim to make our particulars both accurate and reliable. However they are not guaranteed; nor do they form part of an offer or contract. If you require clarification on any points then please contact us, especially if you're traveling some distance to view. Please note that appliances and heating systems have not been tested and therefore no warranties can be given as to their good working order.