



LOUISVILLE ROAD, SW17

£895,000

- Ground Floor
- Two Double Bedrooms
- Share Of Freehold

- Private Garden
- Open Plan
- Energy Rating: D



2



1



2





## ABOUT THE HOME

A stunning example of a Heaver estate, ground floor period garden flat with share of freehold. The property features two double bedrooms and an open plan reception leading to a full width south west facing garden.

Louisville Road is a lovely tree lined residential street which benefits from close proximity to some excellent bars and restaurants along Balham High Road, as well as the wide open spaces of Tooting Bec Common. Tooting Bec tube station (Northern Line) is situated within easy reach providing great transport links to the City and Balham Station is also within easy reach.







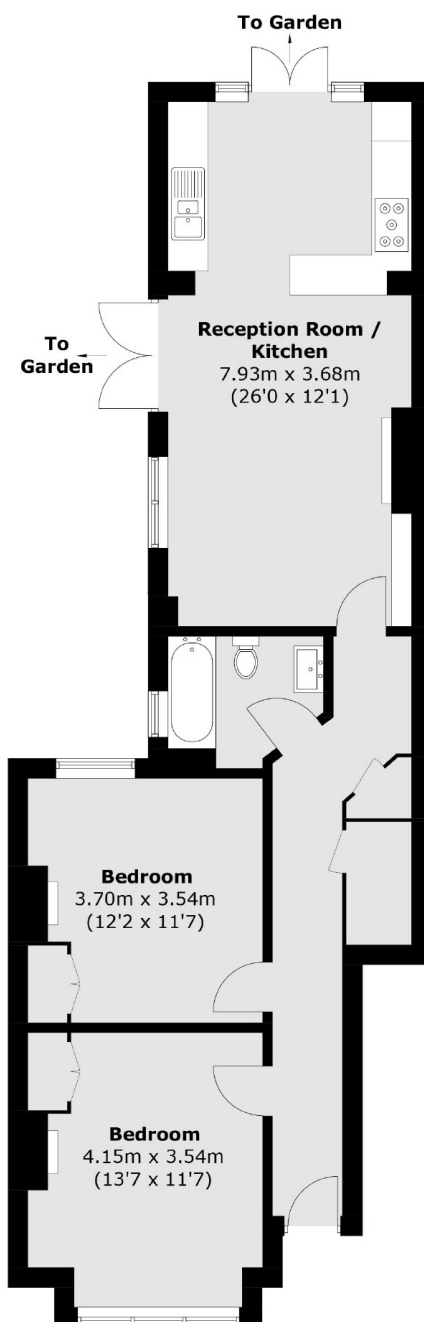

Total area (approx.): 76.6 sq. m (824.5 sq. ft)

#### JACKSONS BALHAM

8-11 Balham Station Road,  
London, SW12 9SG  
Sales: 020 8675 6555  
Lettings: 020 8675 6565

Energy Rating: We aim to make our particulars both accurate and reliable. However they are not guaranteed; nor do they form part of an offer or contract. If you require clarification on any points then please contact us, especially if you're traveling some distance to view. Please note that appliances and heating systems have not been tested and therefore no warranties can be given as to their good working order.