



Hydethorpe Road, SW12

£2,200 PCM

An immaculately presented two bedroom ground floor garden flat. This property would be an ideal home for a professional couple or two professional sharers.

- Open Plan Reception Room
- Two Double bedrooms
- Modern Fitted Bathroom
- Private Garden
- Close To Balham Station
- Unfurnished

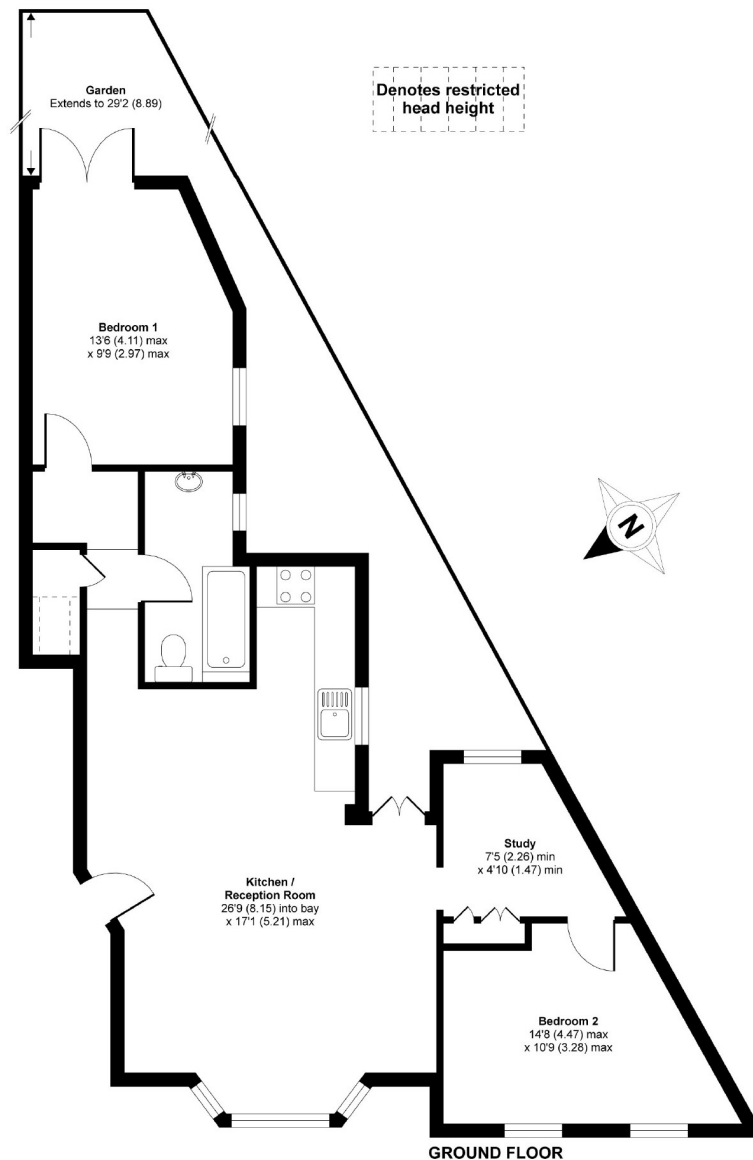

APPROX. GROSS INTERNAL FLOOR AREA 727 SQ FT 67.5 SQ METRES (EXCLUDES RESTRICTED HEAD HEIGHT)

Hydethorpe Road, London, SW12

Copyright nichecom.co.uk 2012 Produced for Jacksons the Independent Estate Agents REF : 223238

Jacksons Balham
8-11 Balham Station Road
London
SW12 9SG
020 8675 6555
balham.sales@jacksonsestateagents.com

Energy Rating: TBC We aim to make our particulars both accurate and reliable. However they are not guaranteed; nor do they form part of an offer or contract. If you require clarification on any points then please contact us, especially if you're traveling some distance to view. Please note that appliances and heating systems have not been tested and therefore no warranties can be given as to their good working order.