



BALHAM PARK ROAD, SW12

£575,000

- Three Bedrooms
- Close to Wandsworth Common
- Beautifully Presented
- Share of Freehold
- Central Balham Location
- Energy Rating C





ABOUT THE HOME

Located just moments from central Balham and a short distance from Wandsworth Common is this beautifully presented, three double bedroom flat. This property offers a bright reception room as well as a separate kitchen. This property is offered to the market with a share of the freehold.

Balham Park Road is a popular residential road located between Central Balham and Wandsworth Common. Balham mainline and underground stations are within easy reach as are the extensive array of shops, bars and restaurants local to the area. The green open spaces of Wandsworth Common are also close by.





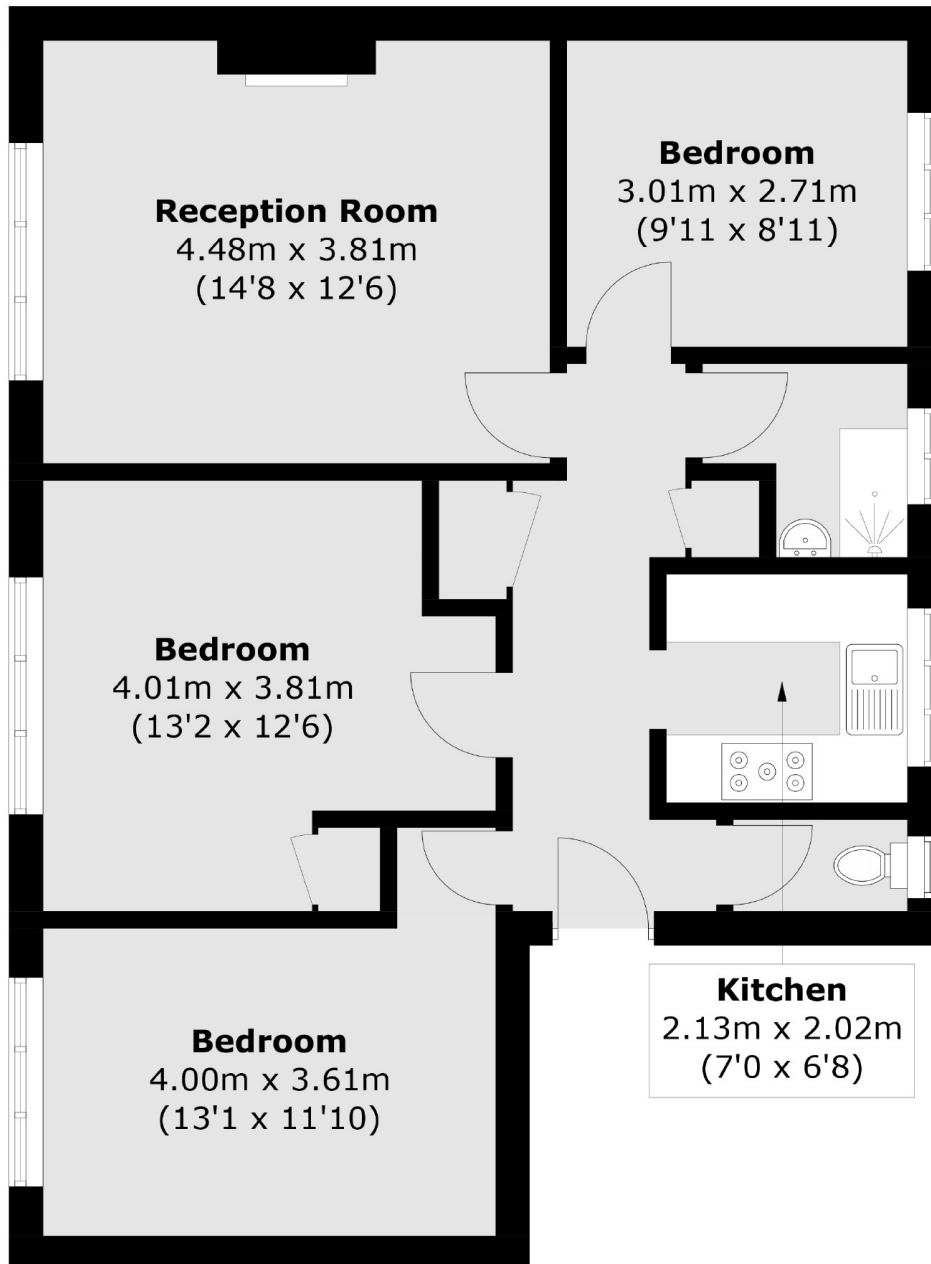

Total area (approx.): 70.4 sq. m (757.8 sq. ft)

JACKSONS BALHAM

8-11 Balham Station Road,
London, SW12 9SG
Sales: 020 8675 6555
Lettings: 020 8675 6565

Energy Rating: C We aim to make our particulars both accurate and reliable. However they are not guaranteed; nor do they form part of an offer or contract. If you require clarification on any points then please contact us, especially if you're traveling some distance to view. Please note that appliances and heating systems have not been tested and therefore no warranties can be given as to their good working order.