



ROWFANT ROAD, SW17

£845,000

- Victorian Conversion
- Share of Freehold
- South West Facing Garden
- Modern Kitchen
- Boundaries Triangle
- Energy Rating C





ABOUT THE HOME

Located just a short distance from the centre of Balham is this beautifully presented two double bedroom, ground floor Victorian conversion flat.

This property offers a bright and spacious reception room as well as a separate modern kitchen with plenty of space for dining and access to the large, south west facing garden. There are two generous double bedrooms and a spacious bathroom. This flat has been beautifully finished throughout and is offered to the market with a share of the freehold.

Rowfant Road is located in the Boundaries Triangle area of Balham, only a short walk to Balham Underground (Northern Line), with local shops bars and restaurant also within easy reach.





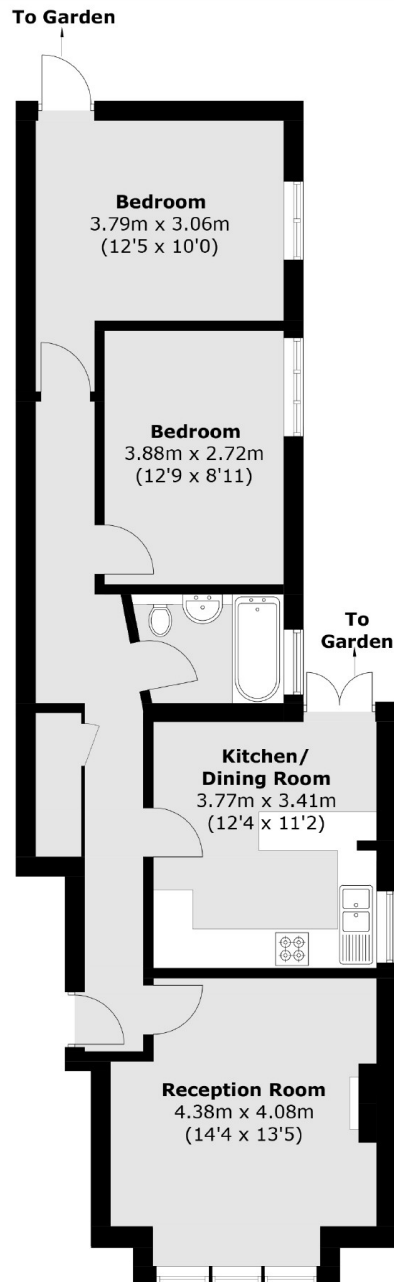

Total area (approx.): 71.6 (770.7 sq. ft)

JACKSONS BALHAM

8-11 Balham Station Road,
London, SW12 9SG
Sales: 020 8675 6555
Lettings: 020 8675 6565

Energy Rating: C We aim to make our particulars both accurate and reliable. However they are not guaranteed; nor do they form part of an offer or contract. If you require clarification on any points then please contact us, especially if you're traveling some distance to view. Please note that appliances and heating systems have not been tested and therefore no warranties can be given as to their good working order.