



FIELDHOUSE ROAD, SW12

£1,500,000

- Beautiful Finish Throughout
- Bright and Spacious Kitchen
- South West Facing Garden
- Close to Tooting Common
- Hyde Farm Estate
- Energy Rating C





ABOUT THE HOME

Just moments from Tooting Common is this superb four bedroom, Victorian Family home. This impressive home has been beautifully finished throughout and offers a large, south west facing garden.

The property offers two beautiful reception rooms and an extended kitchen with lovely skylights and doors leading out to a beautiful, south west facing garden. The first floor accommodates three generous double bedrooms and a spacious family bathroom. The loft has been converted to create a large bedroom with a good sized, en-suite bathroom.

Fieldhouse Road is located in the popular Hyde Farm Estate in Balham, which lies to the north of Tooting Bec Common. The local amenities including shops, restaurants, bars and supermarkets are also close by as well as overground and underground services provided by Balham station.





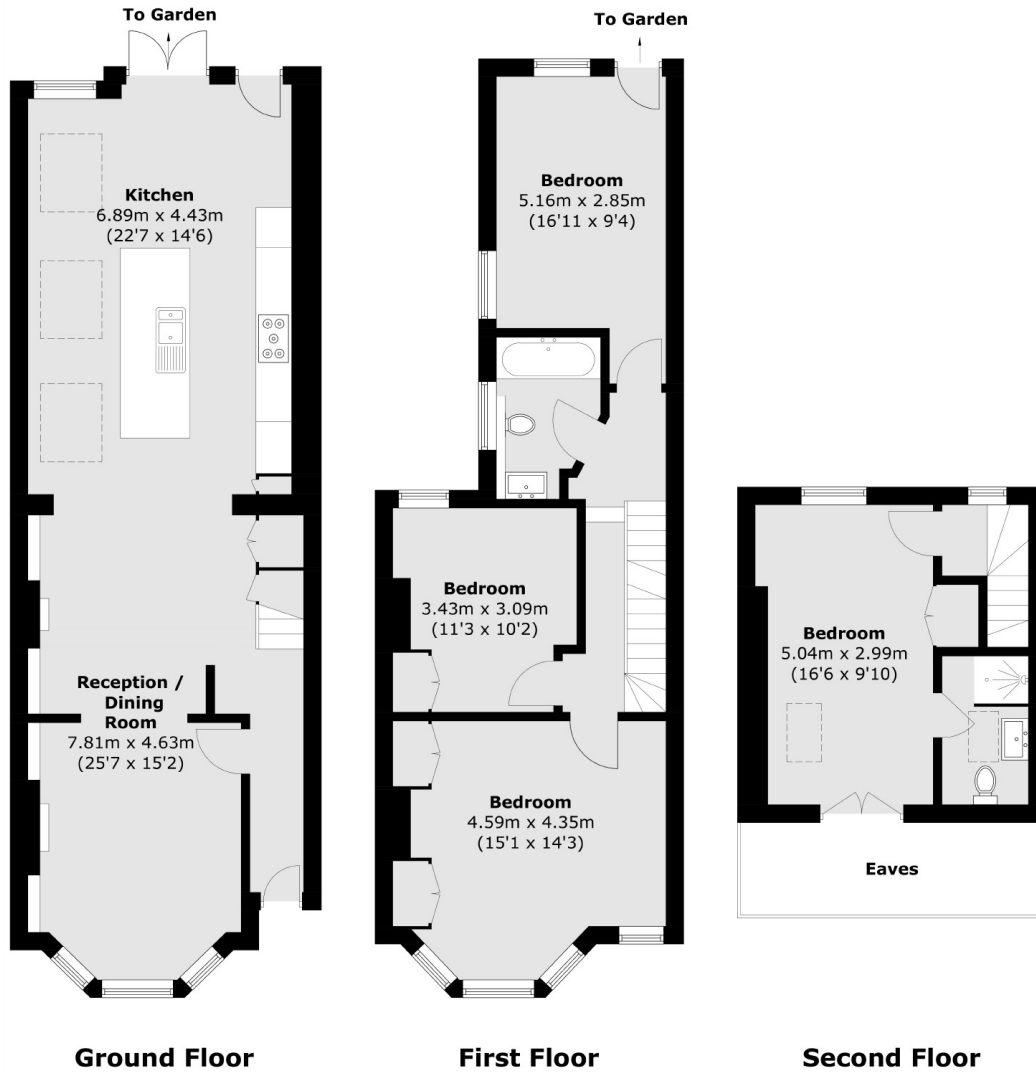

Total area (approx.): 143.9 sq. m (1,548.9 sq. ft)
(Excluding Eaves)

JACKSONS BALHAM

8-11 Balham Station Road,
London, SW12 9SG
Sales: 020 8675 6555
Lettings: 020 8675 6565

Energy Rating: C We aim to make our particulars both accurate and reliable. However they are not guaranteed; nor do they form part of an offer or contract. If you require clarification on any points then please contact us, especially if you're traveling some distance to view. Please note that appliances and heating systems have not been tested and therefore no warranties can be given as to their good working order.