



## Balham High Road, SW17

£2,800 PCM

A brand new luxury two double bedroom apartment in the heart of Balham. This stunning property is situated on the fifth floor of the development, offering expansive views across South London from the private balcony.

- Open Plan Reception Room
- Two Double Bedrooms
- Additional WC
- Private Balcony
- Cycle Storage
- Communal Garden

For further information on the costs associated with renting a property, please pop into our office or visit our website.





This modern apartment offers ample built in storage, an additional WC and access to communal gardens.

Situated in the centre of Balham, this new development is well positioned for easy access to Balham, Tooting Bec and Wandsworth Common stations offering mainline and underground services.





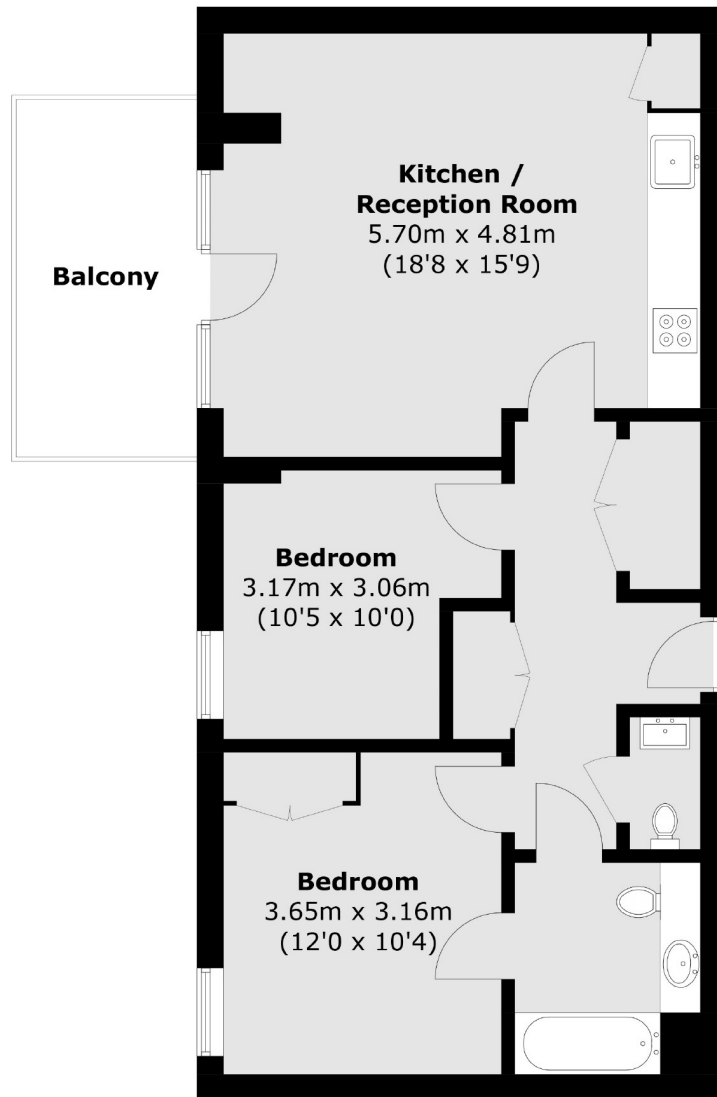

Total area (approx.): 64.2 sq. m (691.0 sq. ft)  
Balcony: 8.3 sq. m (89.3 sq. ft)

Jacksons Balham  
8-11 Balham Station Road  
London  
SW12 9SG  
020 8675 6565  
[balham.lettings@jacksonsestateagents.com](mailto:balham.lettings@jacksonsestateagents.com)

Energy Rating: We aim to make our particulars both accurate and reliable. However they are not guaranteed; nor do they form part of an offer or contract. If you require clarification on any points then please contact us, especially if you're traveling some distance to view. Please note that appliances and heating systems have not been tested and therefore no warranties can be given as to their good working order.