



SCHOLARS ROAD, SW12

£1,750,000

- Close to Tooting Common
- Multi-Purpose Annexe
- Unique Victorian Family Home
- Westerly Rear Garden
- Chain Free
- Hyde Farm Location





ABOUT THE HOME

A beautifully presented Victorian family home comes to the market chain free. Located in one of the most popular roads in the Hyde Farm, adjacent to the common and extensively expanded to larger than ordinarily available in this locale.

The property has been maintained to a very high standard throughout mixing an abundance of period features with up to the minute contemporary fittings and accommodation extending to almost 2,000 sqft. The ground floor accommodation comprises a delightful open plan kitchen and reception space offering excellent space for entertaining and featuring a range of modern bespoke kitchen units, Concertina doors from the kitchen lead out to the delightful private garden.

The property is situated in Scholars Road, across the street from Tooting Bec Common and close to popular local state schools. The transport links including Balham Mainline and Underground stations, and the increasing number of bars, restaurants, shops and supermarkets local to Balham are within a convenient short walk from this exceptional house.





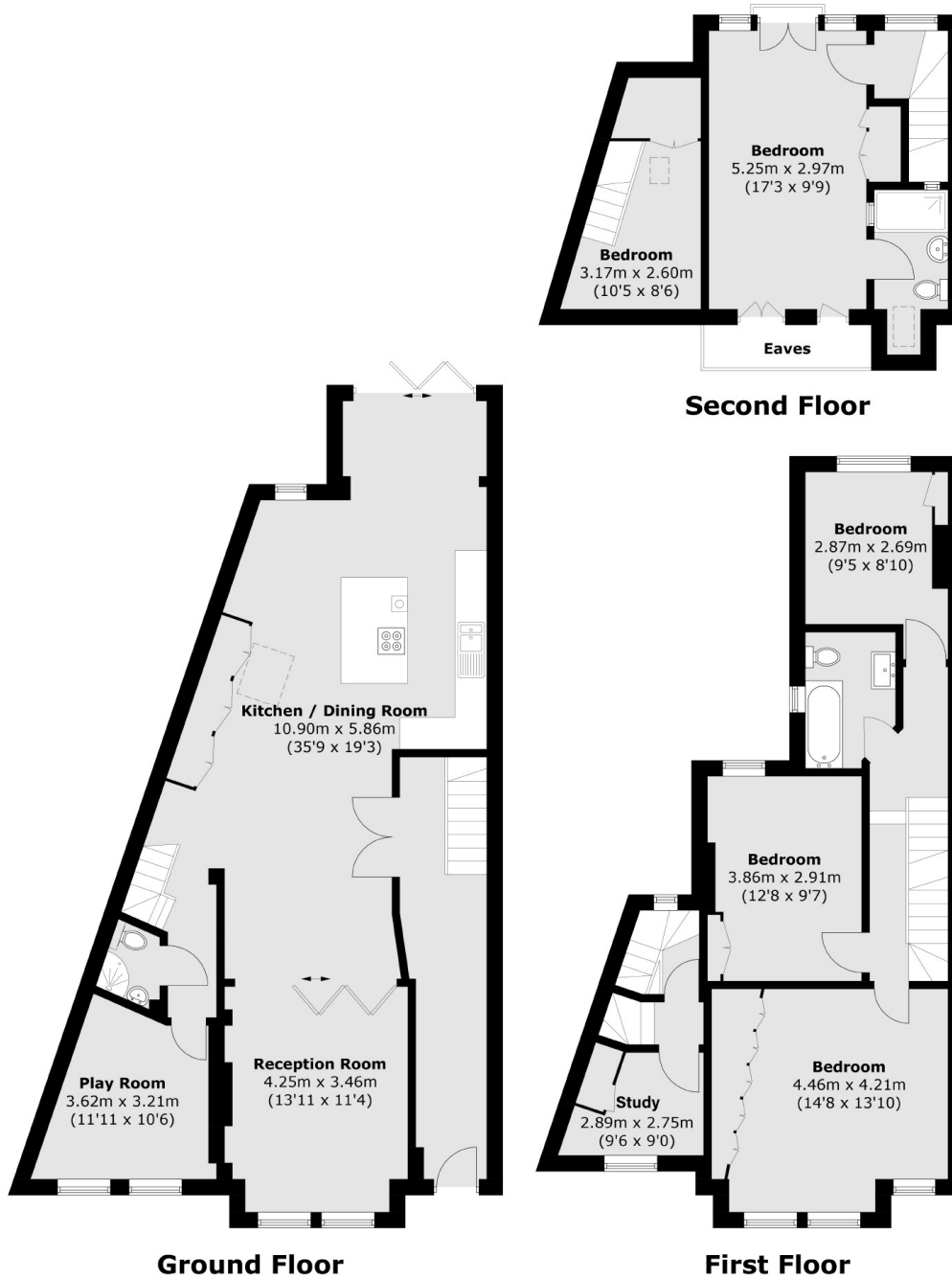

Total area (approx.): 184.8 sq. m (1,989.2 sq. ft)
(Excluding Eaves)

JACKSONS BALHAM

8-11 Balham Station Road,
London, SW12 9SG
Sales: 020 8675 6555
Lettings: 020 8675 6565

Energy Rating: D We aim to make our particulars both accurate and reliable. However they are not guaranteed; nor do they form part of an offer or contract. If you require clarification on any points then please contact us, especially if you're traveling some distance to view. Please note that appliances and heating systems have not been tested and therefore no warranties can be given as to their good working order.