



## Balham Grove, SW12

£2,500 PCM

Located in the heart of Balham, a two bedroom modern apartment, offering ample living space throughout for a professional couple or professional sharers.

- Open Plan
- Modern Fitted Kitchen
- Two Double Bedrooms
- Two Bathrooms
- Close To Balham Station
- Part Furnished

For further information on the costs associated with renting a property, please pop into our office or visit our website.

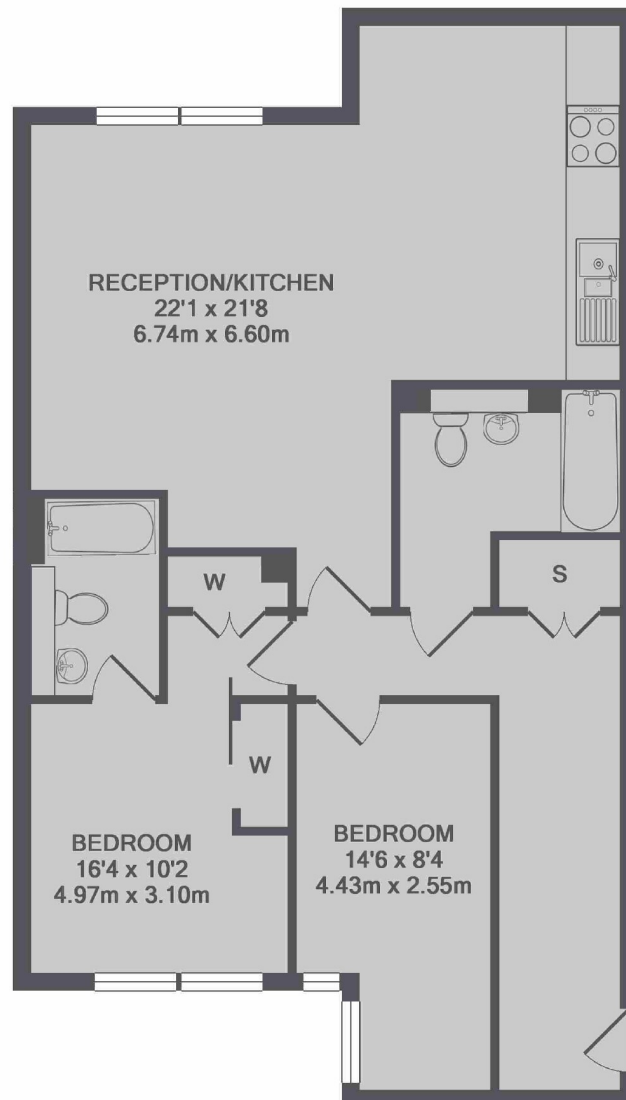

TOTAL APPROX. FLOOR AREA 777 SQ.FT. (72.2 SQ.M.)

Jacksons Balham  
8-11 Balham Station Road  
London  
SW12 9SG  
020 8675 6565  
[balham.lettings@jacksonsestateagents.com](mailto:balham.lettings@jacksonsestateagents.com)

Energy Rating: C We aim to make our particulars both accurate and reliable. However they are not guaranteed; nor do they form part of an offer or contract. If you require clarification on any points then please contact us, especially if you're traveling some distance to view. Please note that appliances and heating systems have not been tested and therefore no warranties can be given as to their good working order.