



Elmbourne Road, SW17

£1,700 PCM

This bright one bedroom, first floor flat would make the ideal home for a professional couple or single occupant.

- First Floor Flat
- Open Plan Reception Room
- One Double Bedroom
- Part Furnished
- Victorian Building
- Close to Tooting Bec Common

For further information on the costs associated with renting a property, please pop into our office or visit our website.

**Elmbourne Road, London**

APPROX. GROSS INTERNAL FLOOR AREA 491 SQ FT 45.6 SQ METRES

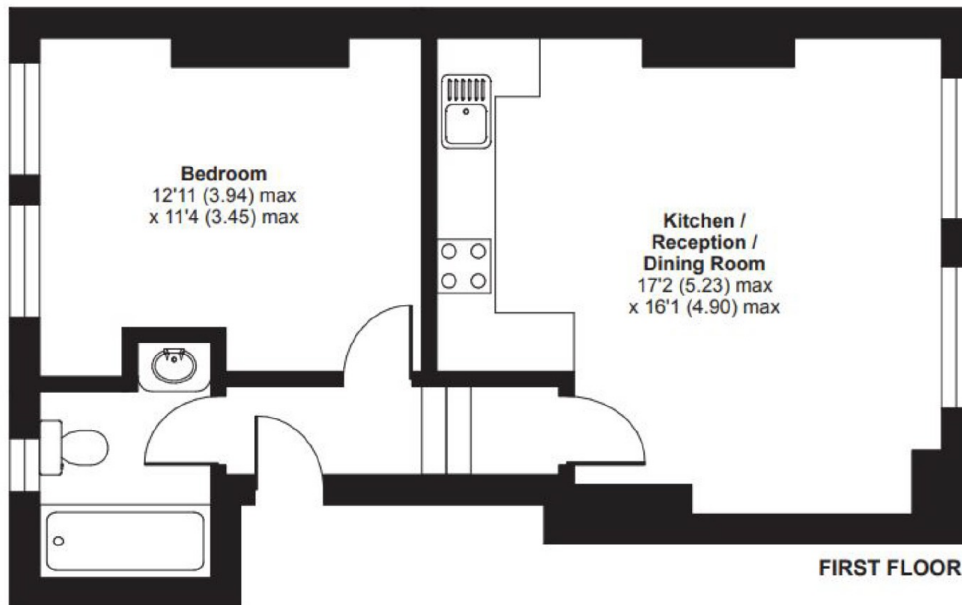

Whilst every attempt has been made to ensure the accuracy of the floor plan contained here, measurements of doors, windows and rooms are approximate and no responsibility is taken for any error, omission or misstatement. These plans are for representation purposes only as defined by RICS Code of Measuring Practice and should be used as such by any prospective purchaser. Specifically no guarantee is given on the total square footage of the property if quoted on this plan. Any figure given is for initial guidance only and should not be relied on as a basis of valuation.

Copyright nichecom.co.uk 2017 Produced for Jackson-Stops REF : 218733

Jacksons Balham
8-11 Balham Station Road
London
SW12 9SG
020 8675 6565
balham.lettings@jacksonsestateagents.com

Energy Rating: TBC We aim to make our particulars both accurate and reliable. However they are not guaranteed; nor do they form part of an offer or contract. If you require clarification on any points then please contact us, especially if you're traveling some distance to view. Please note that appliances and heating systems have not been tested and therefore no warranties can be given as to their good working order.