

9 JINGLING LANE

£265,000

Kirkby Lonsdale, LA6 2AW

An end terrace period cottage, set in a row of four, situated in the heart of this award-winning and sought-after Lune Valley market town.

Occupied by tenants for several years, the property is now ready for refurbishment and upgrading. Spacious accommodation with dining kitchen and sitting room. Two double bedrooms, a third single and bathroom. Garden with verandah and timber shed and walled rear courtyard with a small stone and slate outbuilding and WC. An allocated parking space available within a neighbouring car park on an annual licence.

Nos. 3, 5 and 7 are also on the market. Please ask the agent for further details.





Welcome to **9 JINGLING LANE**

£265,000

Kirkby Lonsdale, LA6 2AW

Here's our **TOP TEN** reasons to love **9 Jingling Lane**:

1. **Location, location, location** - at the heart of life in Kirkby Lonsdale - this sought-after Cumbrian market town in a Conservation Area, has been voted in the Top 10 places to live in the northwest by the Sunday Times on a number of occasions.
2. **Highly convenient** - walk to the independent shops, the post office, bank, to the pubs, cafes and restaurants, Booths supermarket and Boots Chemist, as well as the opticians and doctor's and dentists' surgeries.
3. **Opportunity to refurbish** - now ready for upgrading to suit your own requirements.
4. **Income potential** - 9 Jingling Lane has been let on an Assured Shorthold Tenancy for a number of years or it could also be a holiday let.
5. **Spacious accommodation** with a gross internal area of c. 1116 sq ft (103.7 sq m). To the ground floor, there is a dining kitchen with base and wall units and a wood burning stove, hall and sitting room and quarry tiled floor. The sitting room also has a brick fireplace. First floor landing, double bedroom 1 with built-in double wardrobe and, cast iron fireplace, double bedroom 2, single bedroom 3 with cast iron fireplace and a four piece bathroom.
6. **Allocated parking** - one space within the car park on Jingling Lane, available through John G Hills on an annual licence.
7. **Garden** - with verandah covered seating terrace, lawn and a timber shed.
8. **Small walled courtyard** to the rear with a stone and slate outhouse and a WC. There is also a pedestrian gate leading onto Jingling Lane.
9. **Excellent access to the great outdoors** - Lune Valley, The Yorkshire Dales and the Lake District National Park and two National Landscapes (Silverdale/Arnside and the Forest of Bowland) so in whichever direction you head for a walk, run, climb, sail or cycle, it's all beautifully accessible.
10. **Connectivity** - there is easy access onto the M6 at Junctions 34, 35, or 36 with the A65 for travelling east on the edge of town. There are train stations at Oxenholme and Lancaster, on the main west coast line with direct trains to London Euston, Glasgow, Edinburgh and Manchester Airport.

To find the property: from the market square in the centre of the town, head east along Jingling Lane. The row of cottages is on the right hand side with No. 9 being the fourth in the row.

What3Words reference: ///skippers.known.culminate



You'll need to know...

- Mains electricity, gas, water and drainage
- Single glazed windows
- Council Tax - 9 Jingling Lane is currently banded C. Potential purchasers are advised to verify this information for themselves.
- Local and Planning Authority - Westmorland & Furness Council. W: www.westmorlandandfurness.gov.uk
- Tenure - freehold, vacant possession on completion
- Also available separately - Nos. 3, 5 and 7 are also on the market. Please ask the agent for further details.
- Sold as seen

Money Laundering

Prospective buyers should be aware that in the event that they make an offer for the property, they will be required to provide the agent with documents in relation to the Money Laundering Regulations; one being photographic ID, i.e. driving licence or passport and the other being a utility bill showing their address. These can be provided in the following ways: by calling into the agent's office with copies or by way of a certified copy provided via their solicitor. In addition prospective buyers will be required to provide information regarding the source of funding as part of the agent's offer procedure.

3, 5, 7, 9 Jingling Lane, Kirkby Lonsdale, LA6 2AW

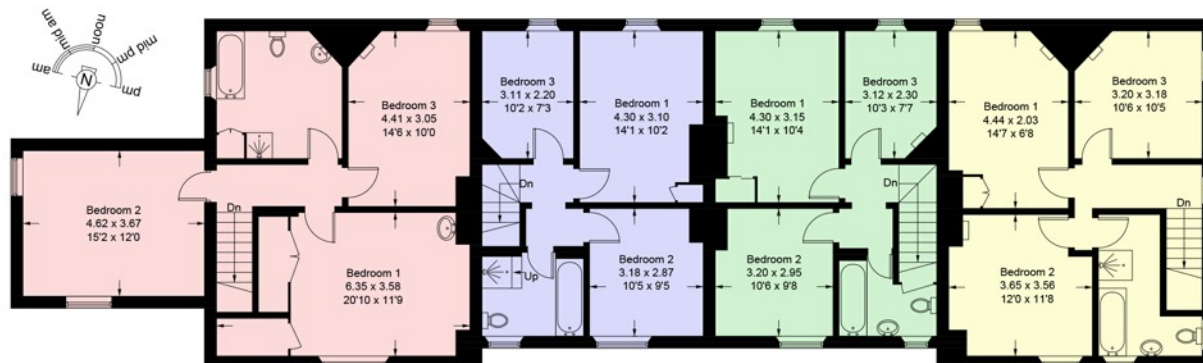

First Floor



Ground Floor

Illustration for identification purposes only, measurements are approximate, not to scale. Fourlabs.co @ (ID1203902)

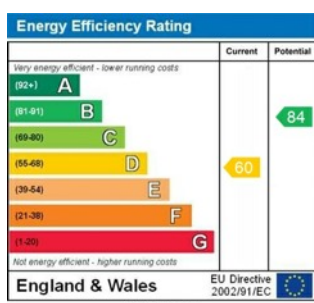
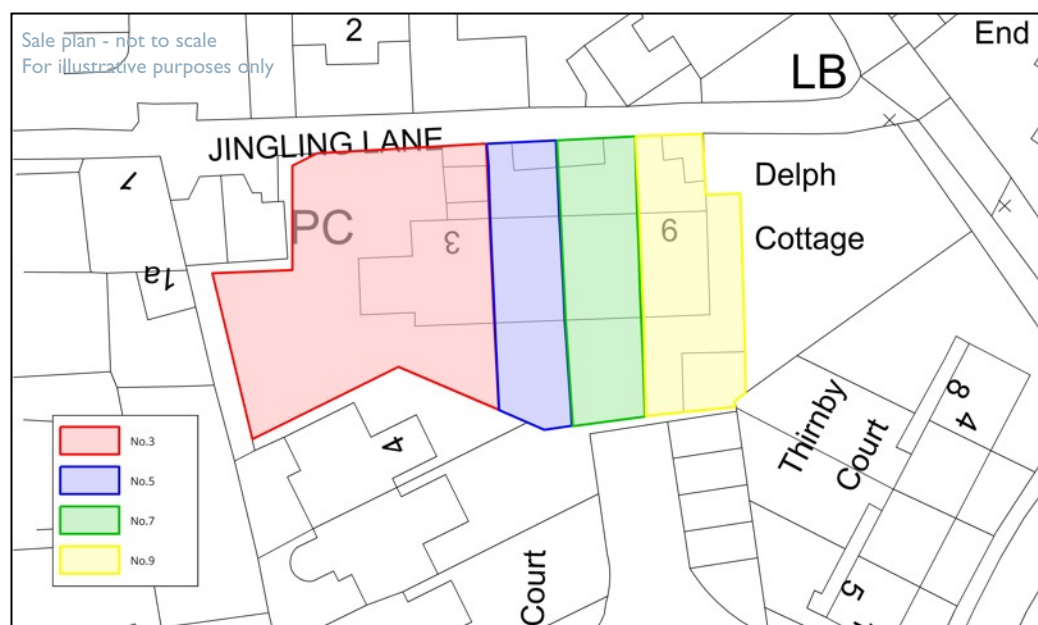

IMPORTANT Davis & Bowring, for themselves and for the vendors or lessors of this property whose agents they are give notice that (i) these particulars are set out as a general outline only for guidance of intending purchasers or lessees, and do not constitute, nor constitute part of an offer or contract; (ii) all descriptions, photographs, measurements, areas, dimensions, references to condition and necessary permissions for use and occupation, and other details are given without responsibility and any intending purchasers or tenants should not rely on them as statements or representations of fact but must satisfy themselves by inspection or otherwise as to the correctness of each of them; (iii) no person in the employment of Davis & Bowring, has any authority to make or give any representation or warranty whatever in relation to this property nor have we carried out a detailed survey or tested the services, appliances or fittings in the property; (iv) all viewings are carried out at the sole risk of the viewer and neither the selling agent nor the vendor takes responsibility for any part of the property.