



## 5 HOLWAY CLOSE CROMER, NR27 9LH

£1,200 PCM

**\*\*6 MONTH ONLY\*\*** A well presented detached bungalow situated in a quiet residential area of Cromer. Comprising Lounge/Diner, Kitchen, Conservatory, Two Bedrooms, Wet Room, Enclosed Rear Garden, Garage & Off Road Parking. Unfurnished & Available NOW. Call Henleys to view.

**HENLEYS**  
Residential Sales & Lettings



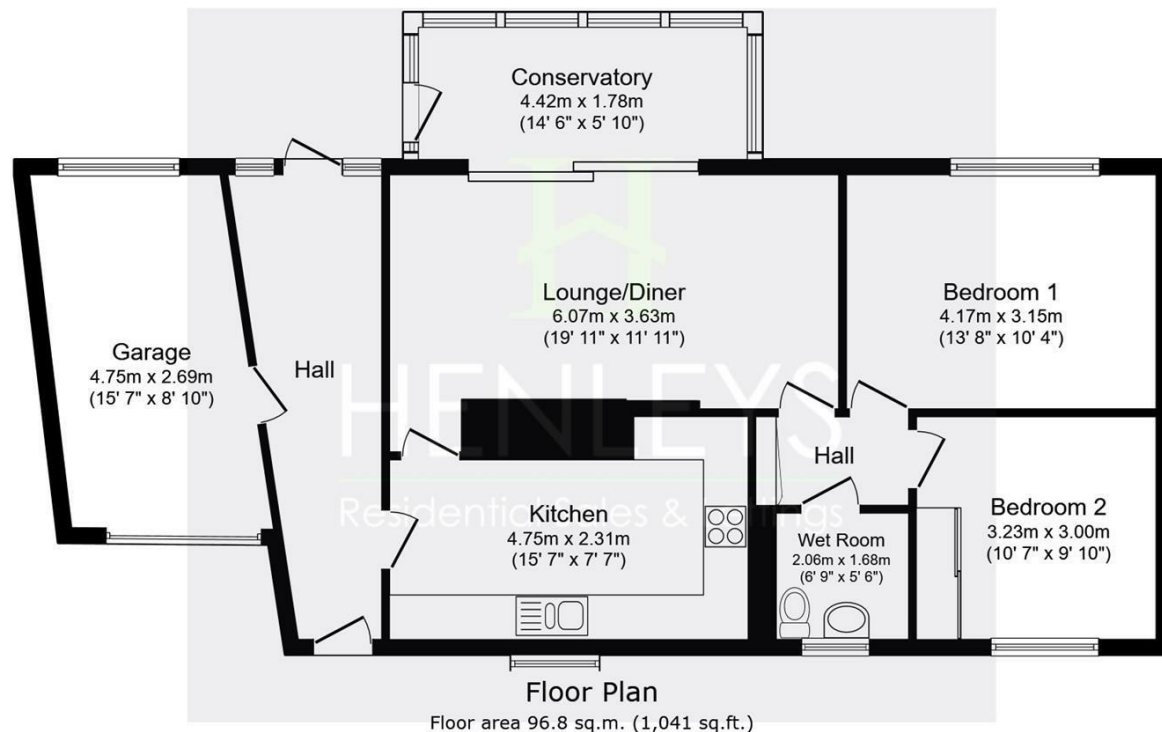

Total floor area: 96.8 sq.m. (1,041 sq.ft.)

This floor plan is for illustrative purposes only. It is not drawn to scale. Any measurements, floor areas (including any total floor area), openings and orientations are approximate. No details are guaranteed, they cannot be relied upon for any purpose and do not form any part of any agreement. No liability is taken for any error, omission or misstatement. A party must rely upon its own inspection(s). Powered by www.Propertybox.io

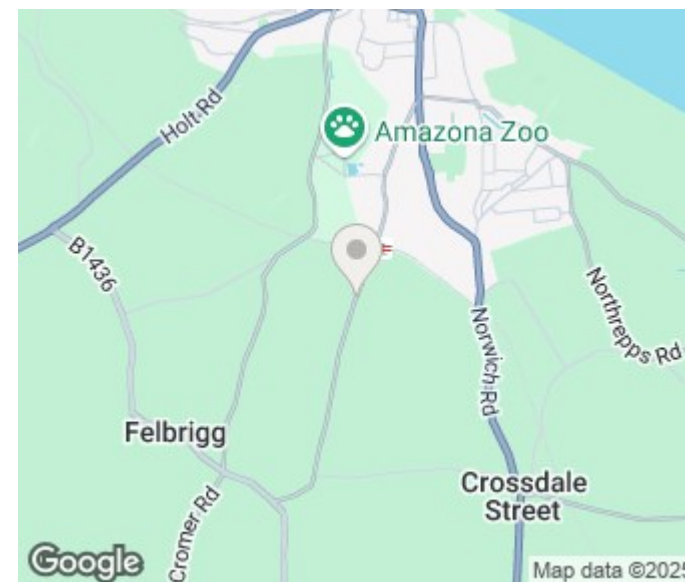

Energy Efficiency Rating		
	Current	Potential
Very energy efficient - lower running costs		
(92 plus) <b>A</b>		
(81-91) <b>B</b>		
(69-80) <b>C</b>		
(55-68) <b>D</b>		
(39-54) <b>E</b>		
(21-38) <b>F</b>		
(1-20) <b>G</b>		
Not energy efficient - higher running costs		
<b>England &amp; Wales</b>	EU Directive 2002/91/EC	