

# Bradman Way, Stevenage, Hertfordshire, SG1 5RE

£1,450 PCM

**H&M**  
sales and lettings





Refurbished and modern two bedroom mid terraced located in the Pin Green area of Stevenage. Available now and offered unfurnished with good size lounge diner, enclosed rear garden and allocated parking space. Call Homes and Mortgages today on 01438 728444 to arrange your viewing.

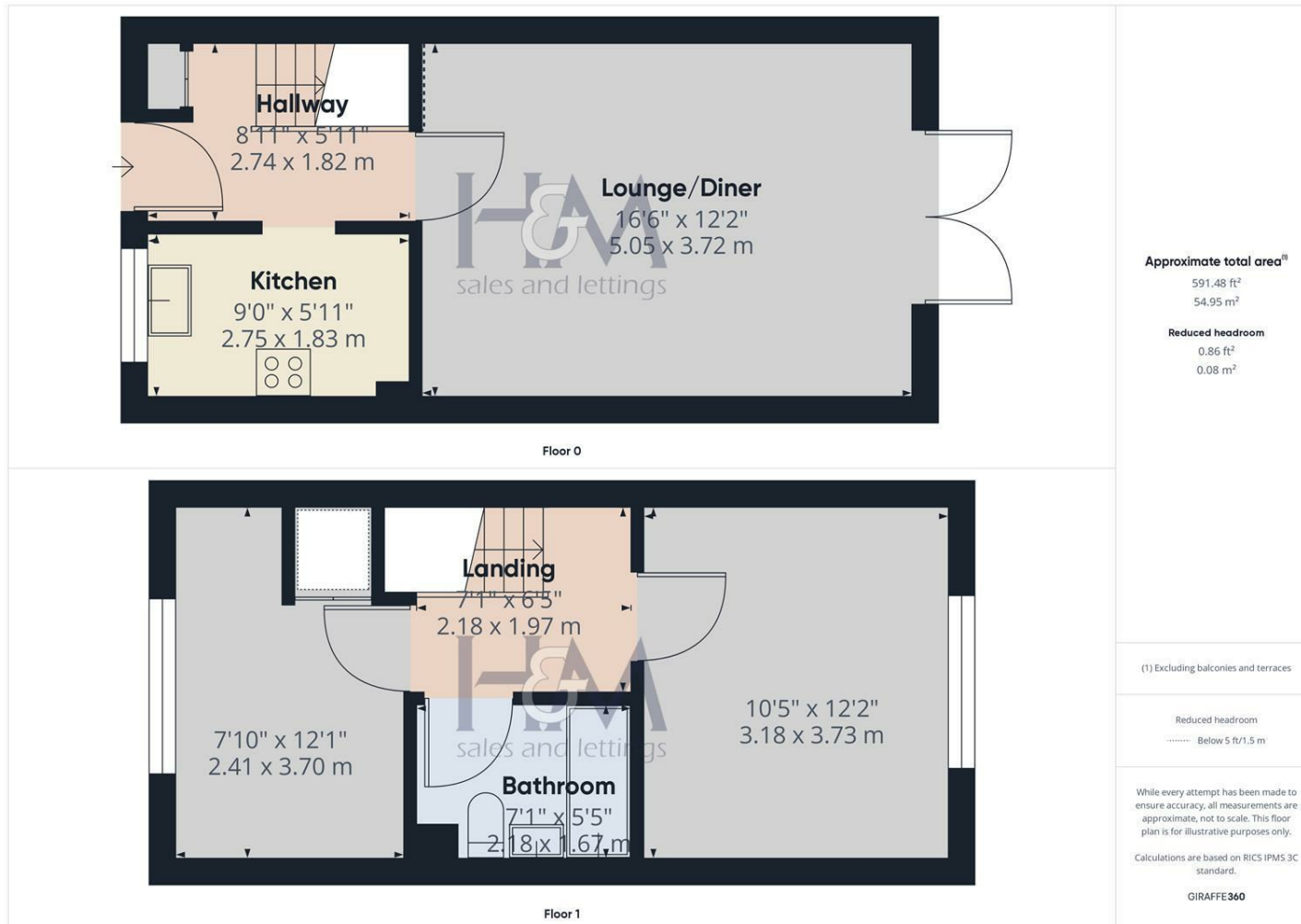

86 High Street  
Stevenage  
Hertfordshire  
SG1 3DW  
01438 728444  
stevenage@homesandmortgages.co.uk

### Energy Efficiency Rating

	Current	Potential
Very energy efficient - lower running costs		
(92 plus) <b>A</b>		
(81-91) <b>B</b>		
(69-80) <b>C</b>		
(55-68) <b>D</b>	63	69
(39-54) <b>E</b>		
(21-38) <b>F</b>		
(1-20) <b>G</b>		
Not energy efficient - higher running costs		
<b>England &amp; Wales</b>	EU Directive 2002/91/EC 