



Sky Gardens, Wandsworth Road, Vauxhall, SW8

Asking price **£560,000** | Leasehold



Sky Gardens, Wandsworth Road, Vauxhall, SW8



1 Bedroom



1 Bathroom



1 Reception



Winter Garden



Gymnasium



Local Amenities



24-Hour Concierge



0.1 MI Nine Elms

This fantastic one bedroom apartment is set in Sky Gardens, a recent development in Nine Elms / Vauxhall district. The open plan living/ dining area extends onto a winter garden with panoramic area views. There is a modern kitchen with integrated appliances, an ample bedroom and a smart bathroom. Features include floor-to-ceiling windows, wood flooring and adequate bedroom storage.

Sky Gardens offers impressive onsite amenities including a 24-hour concierge, a stylish gym and garden area, and the roof garden with 360-degree

views of London. The development is a short walk away from Vauxhall station and a stroll from the Thames and the new Nine Elms district with shops and riverside restaurants.

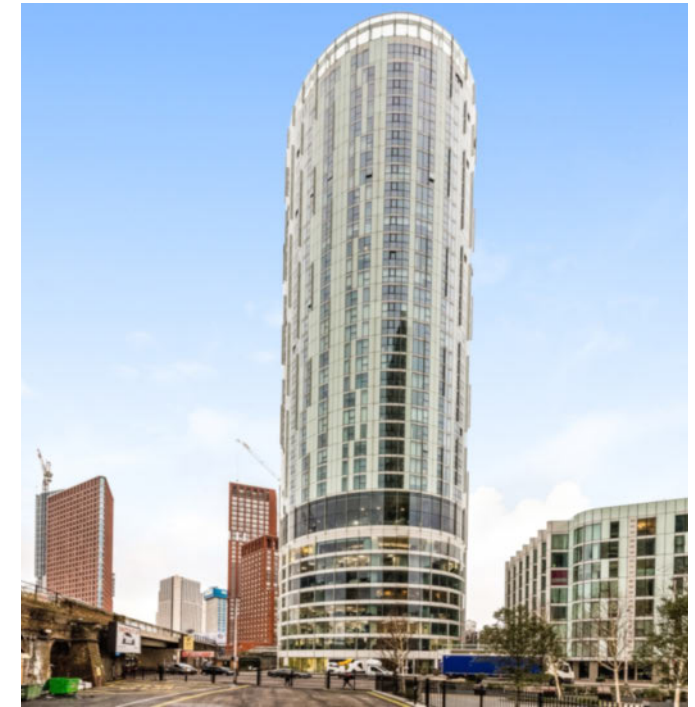

Tenure: Leasehold

Local Authority: Lambeth London

Ground Rent: £400 p.a.

Council Tax Band: E

Service Charge: £2,200 p.a.

EPC: B

Floorplan

496 sq ft | 46 sq m

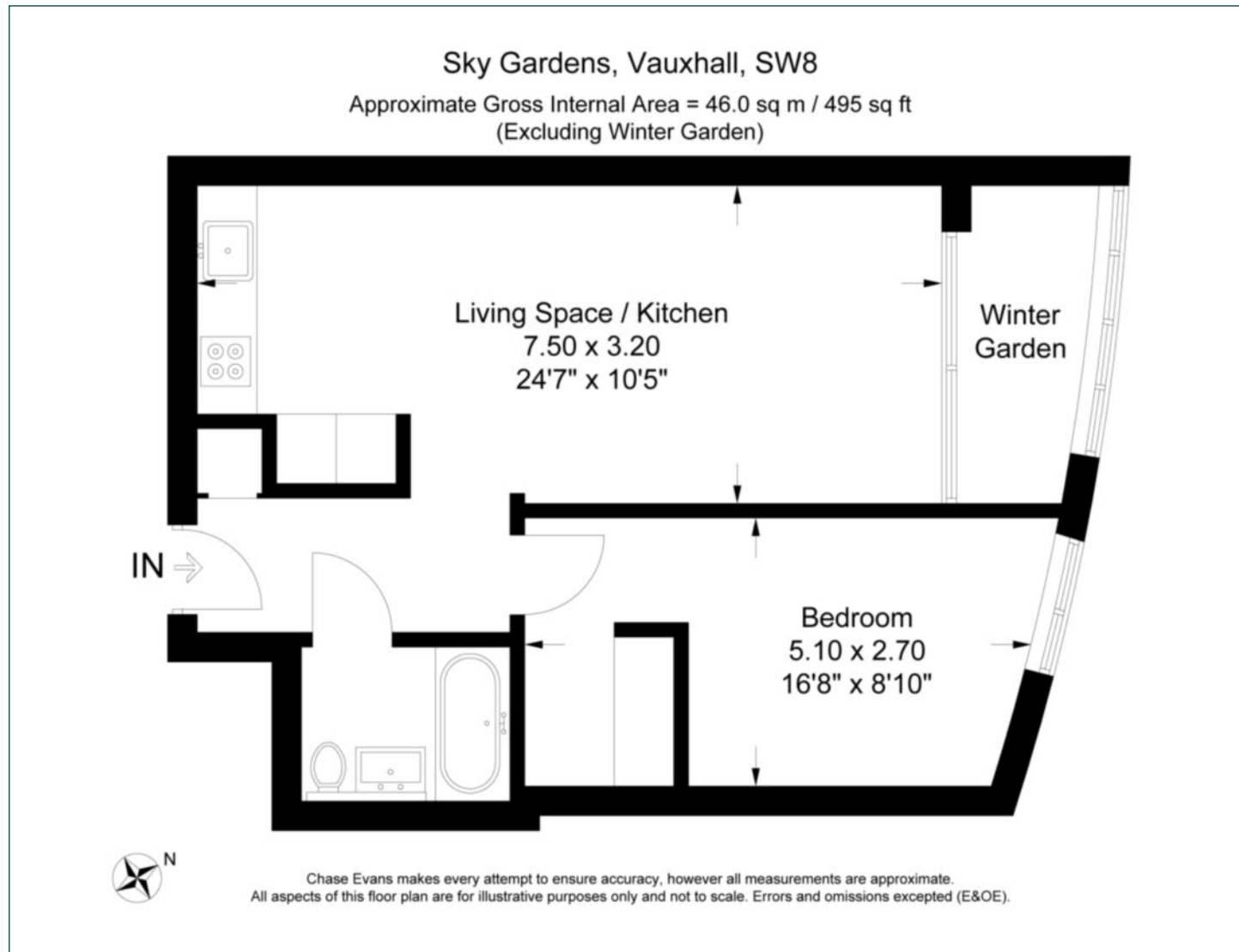

Elephant & Castle

One The Elephant, 5 St Gabriel Walk, London, SE1 6FA

Sales

020 3869 2898 | eandc.sales@chaseevans.co.uk

We're here to help.

IMPORTANT NOTICE - These particulars have been prepared in good faith and they are not intended to constitute part of an offer or contract. We have not performed a structural survey on this property and the services, appliances and specific fittings have not been tested. All photographs, measurements, floor plans and distances referred to are given as a guide and should not be relied upon.

chaseevans.com

 Chase Evans