



## Tenterden House, Kinglake Street, Elephant & Castle, SE17

Asking price **£335,000** | Leasehold



# Tenterden House, Kinglake Street, Elephant & Castle, SE17



2 Bedrooms



1 Bathroom



1 Reception



Balcony



Nearby Green Spaces



Local Amenities



1.2 MI Elephant & Castle

A substantial two bedroom, one bathroom with a balcony flat set within Tenterden House, a purpose built mansion block situated on Surrey Square park, a short walk away from the thriving Elephant Park regeneration district in Elephant and Castle.

The accommodation includes a fully integrated kitchen equipped with modern appliances, a separate reception area with wood-style laminate flooring. Two spacious bedrooms and a bright bathroom, separate WC.

The property is well-situated just off the Old Kent Road with plenty of bus, tube and train transport services available within walking distance.

There are a wealth of amenities within convenient walking distance at Elephant and Castle and Bermondsey. Adjacent to Kinglake Road is Green Flag award-winning Surrey Square Park and just a short stroll to the South is the excellent Burgess Park.

**Tenure:** Leasehold (105 years remaining) **Local Authority:** Southwark Council

**Ground Rent:** Peppercorn **Council Tax Band:** B

**Service Charge:** £1,719 p.a. **EPC:** C

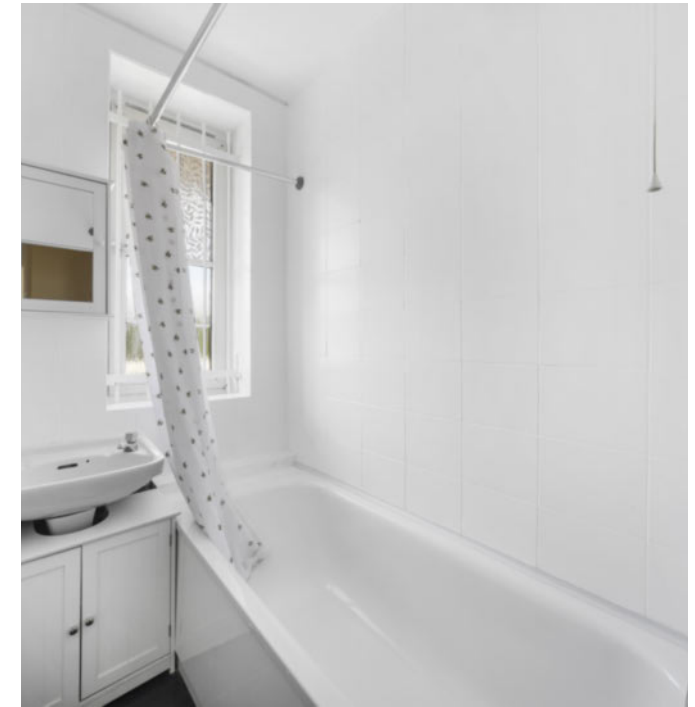

# Floorplan

590 sq ft | 54.8 sq m

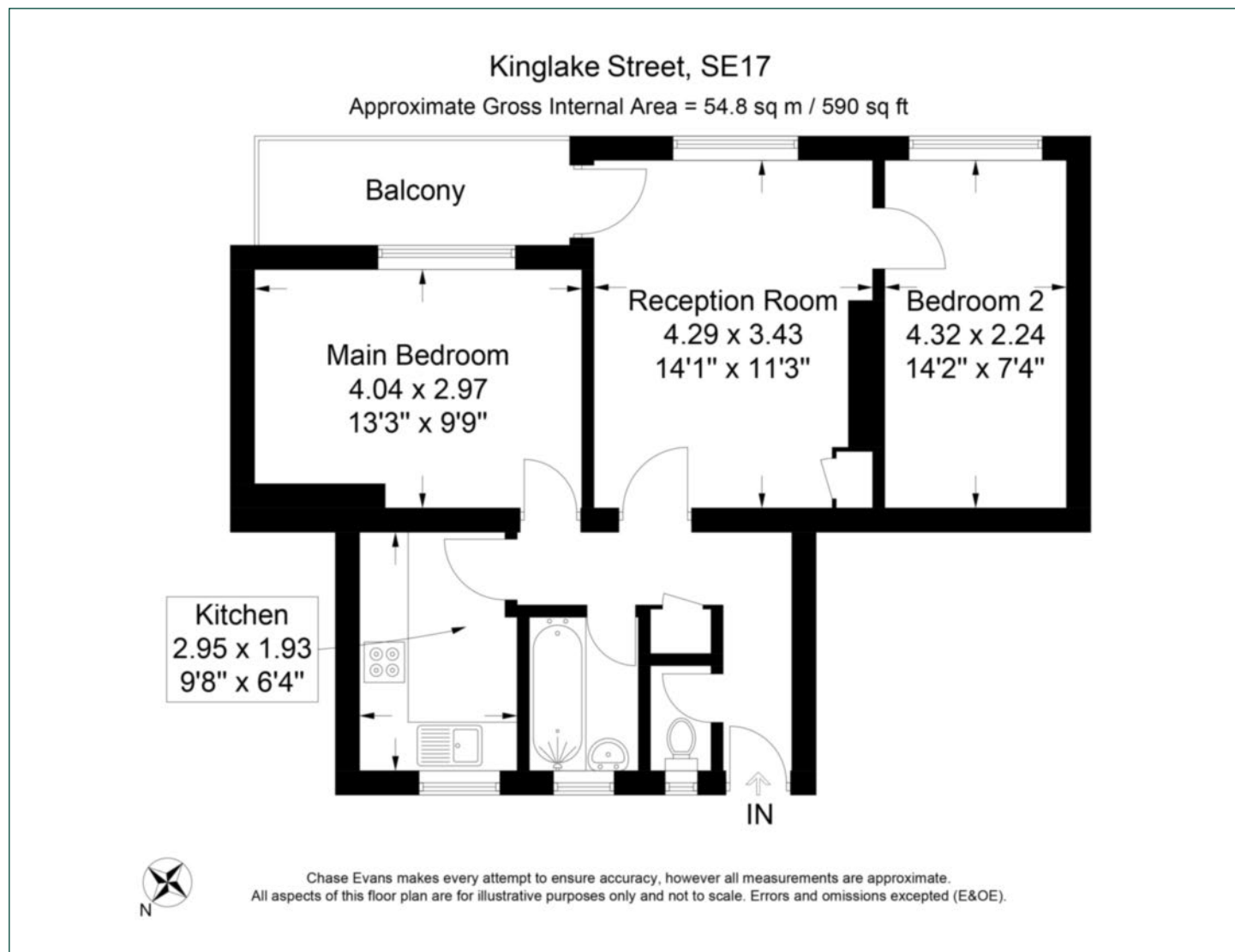

## Elephant & Castle

One The Elephant, 5 St Gabriel Walk, London, SE1 6FG

## Sales

020 3869 2898 | eandc.sales@chaseevans.com

## We're here to help.

IMPORTANT NOTICE - These particulars have been prepared in good faith and they are not intended to constitute part of an offer or contract. We have not performed a structural survey on this property and the services, appliances and specific fittings have not been tested. All photographs, measurements, floor plans and distances referred to are given as a guide and should not be relied upon.

[chaseevans.com](https://www.chaseevans.com)

 Chase Evans