



## Baldwin Point, Elephant Park, Sawyer Street, SE17

Price **£877 per week** | Furnished



# Baldwin Point, Elephant Park, Sawyer Street, SE17



2 Bedrooms



2 Bathrooms



1 Reception



Balcony



Gymnasium



Local Amenities



Concierge Service

\*PHOTOS FOR ILLUSTRATIVE PURPOSES ONLY\*

Modern two bedroom, two bathroom apartment with a balcony in Baldwin Point, Elephant Park. This apartment comprises an open plan kitchen/ living space featuring modern, fully integrated appliances, wood flooring and access to the balcony, a master bedroom with en-suite bathroom, a further double bedroom and a family bathroom.

Concierge, onsite gym, roof terrace and private gardens. The development also benefits from being

located close to Elephant and Castle Underground station which serves Northern and Bakerloo Lines, providing access towards central London and other areas across the capital.



**Local Authority:** Southwark Council

**Council Tax Band:** E

**EPC:** B

**Security deposit:** equivalent to 5 weeks' rent

# Floorplan

730 sq ft | 67.8 sq m

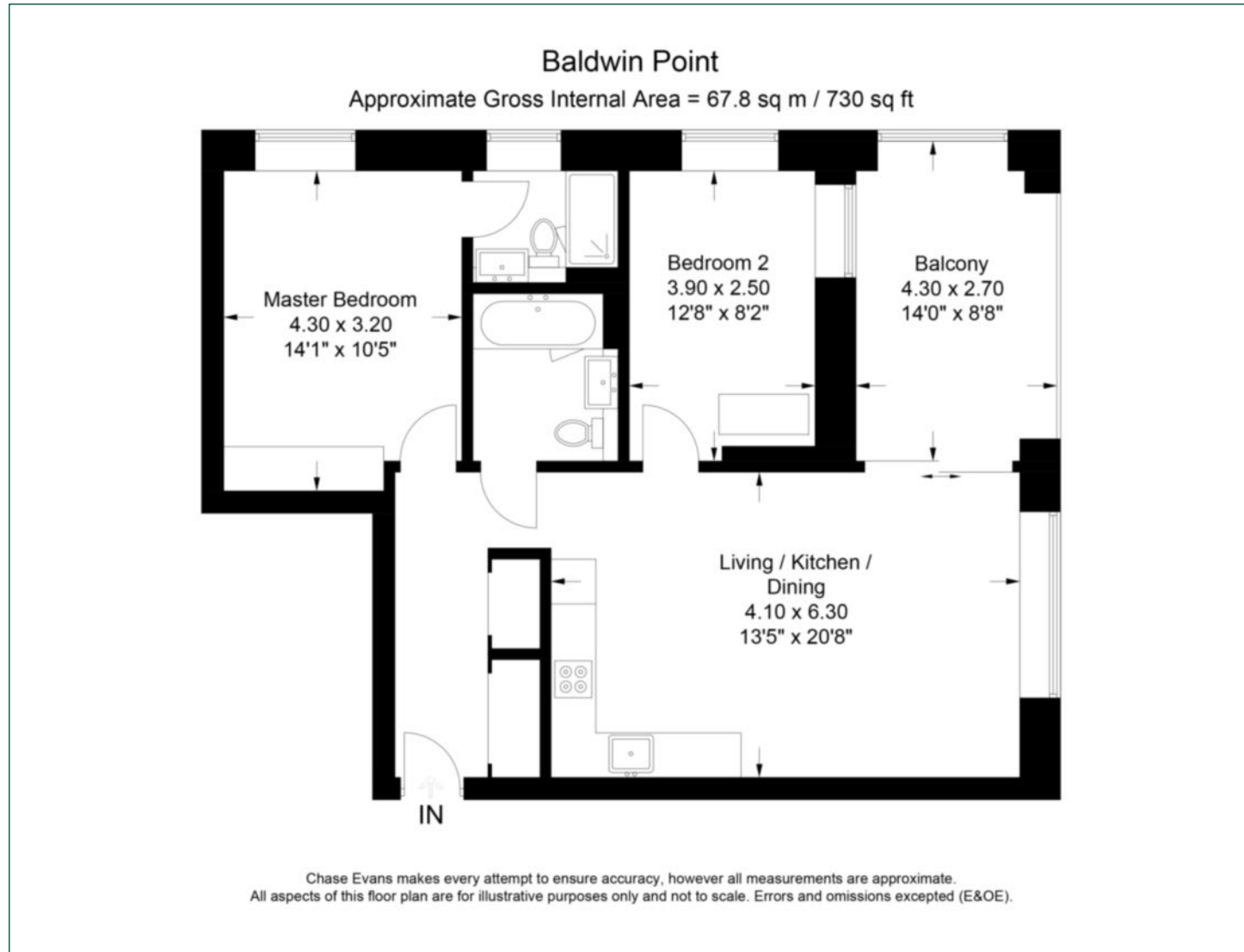

## Elephant & Castle

One The Elephant, 5 St Gabriel Walk, London, SE1 6FG

## Lettings

020 3869 2888 | [eandc.lettings@chaseevans.com](mailto:eandc.lettings@chaseevans.com)

## We're here to help.

IMPORTANT NOTICE - These particulars have been prepared in good faith and they are not intended to constitute part of an offer or contract. We have not performed a structural survey on this property and the services, appliances and specific fittings have not been tested. All photographs, measurements, floor plans and distances referred to are given as a guide and should not be relied upon.

[chaseevans.com](http://chaseevans.com)