



Arc House, Maltby Street, Tower Bridge, SE1

Asking price **£750,000** | Leasehold



Arc House, Maltby Street, Tower Bridge, SE1



2 Bedrooms



2 Bathrooms



1 Reception



Balcony



Local Amenities



0.6 MI London Bridge

A two bedroom, two bathroom apartment with a balcony set within the Arc House development minutes from the City of London's and London Bridge. This spacious apartment includes an open plan kitchen/ living space opening onto the balcony, modern fitted kitchen with ample cupboard space, wood flooring, high ceilings, recessed lighting, two large bedrooms, master with fitted storage and en suite and bright bathroom with smart fittings and fixtures.

There are several amenities located nearby including restaurants, bars and a number of

cultural attractions of the South Bank. Butlers Wharf Pier offers a fine selection of places to dine along the riverside with views of Tower Bridge. The development is located near several transport links including London Bridge station, providing Underground and rail services for commutes across the Capital.

Tenure:	Leasehold (241 years remaining)	Local Authority:	Southwark Council
Ground Rent:	£300 p.a.	Council Tax Band:	E
Service Charge:	£3,744.09 p.a.	EPC:	B



Floorplan

838 sq ft | 77.88 sq m

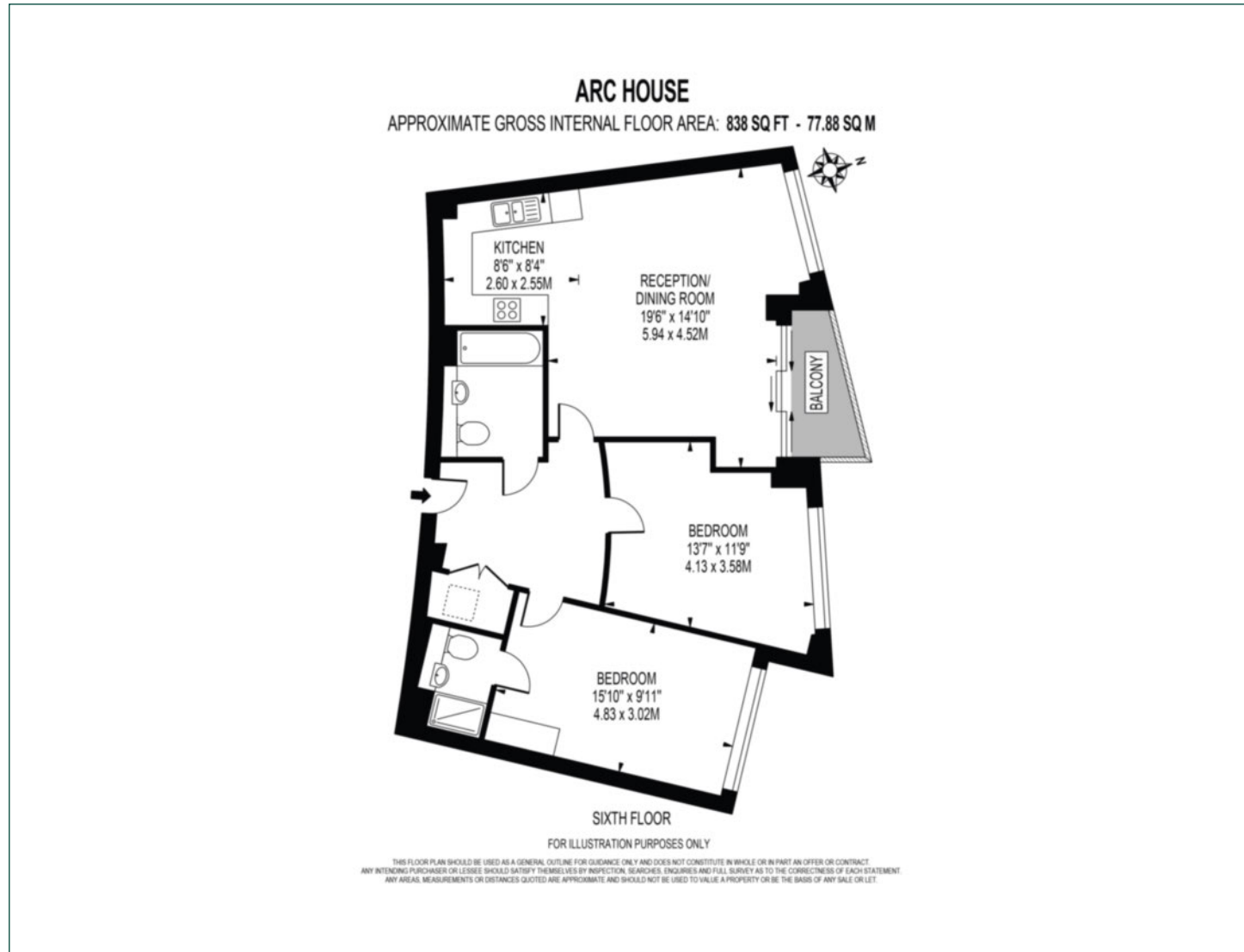

Elephant & Castle

One The Elephant, 5 St Gabriel Walk, London, SE1 6FA

Sales

020 3869 2888 | eandc.sales@chaseevans.co.uk

We're here to help.

IMPORTANT NOTICE - These particulars have been prepared in good faith and they are not intended to constitute part of an offer or contract. We have not performed a structural survey on this property and the services, appliances and specific fittings have not been tested. All photographs, measurements, floor plans and distances referred to are given as a guide and should not be relied upon.

[chaseevans.com](https://www.chaseevans.com)