



## Walton Heights, Elephant Park, Walworth Road, Elephant & Castle, SE17

Price **£795 per week** | Furnished



# Walton Heights, Elephant Park, Walworth Road, Elephant & Castle, SE17



1 Bedroom



1 Bathroom



1 Reception



Balcony



Gymnasium



Local Amenities



24-Hour Concierge



0.2 MI Elephant & Castle

Bright & spacious one bedroom apartment set within Walton Heights, Elephant Park SE17. Comprises a bright and airy living / dining area with full length windows, a bespoke modern fitted kitchen with integrated appliances and an additional 52sq/ft dual aspect south/south-east facing balcony. Stylish, contemporary bathroom suite and a large double bedroom with fitted wardrobe.

Residents benefit from an array of facilities which will include a gymnasium, communal gardens, secure cycle storage and a 24-hour concierge

service There are several amenities located nearby including bars, cafés, restaurants and the Elephant and Castle Shopping Centre.

The development is located close to Elephant and Castle National Rail and Underground stations, providing Underground and Rail services for commutes towards the City and West End. The property is serviced by Thameslink, Southeastern, Bakerloo and Northern Line, opening up a plethora of transport links.

**Local Authority:** Southwark Council

---

**Council Tax Band:** D

---

**EPC:** B

---

**Security deposit:** equivalent to 5 weeks' rent

---

# Floorplan

577 sq ft | 53.6 sq m

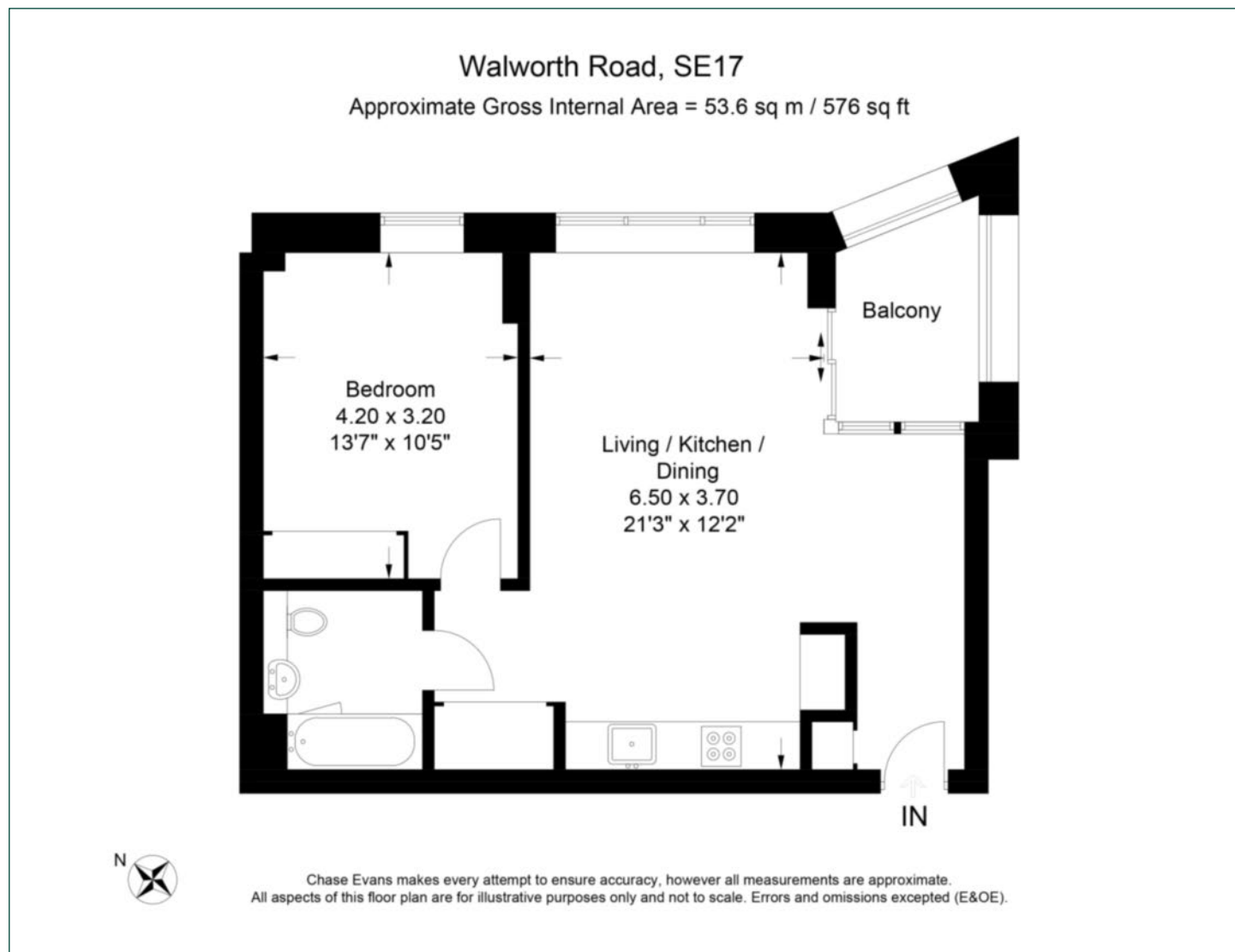

## Elephant & Castle

One The Elephant, 5 St Gabriel Walk, London, SE1 6FA

## Lettings

020 3869 2888 | [eandc.lettings@chaseevans.co.uk](mailto:eandc.lettings@chaseevans.co.uk)

## We're here to help.

IMPORTANT NOTICE - These particulars have been prepared in good faith and they are not intended to constitute part of an offer or contract. We have not performed a structural survey on this property and the services, appliances and specific fittings have not been tested. All photographs, measurements, floor plans and distances referred to are given as a guide and should not be relied upon.

[chaseevans.com](https://chaseevans.com)

 Chase Evans