



Grand Tower, Plaza Gardens, Putney, SW15

Price **£650 per week** | Furnished



Grand Tower, Plaza Gardens, Putney, SW15



2 Bedrooms



2 Bathrooms



1 Reception



Balcony



Lift Access



Gymnasium



Local Amenities



24-Hour Concierge



0.1 MI East Putney

A modern two bedroom two bathroom apartment set within this fantastic tower in Putney Plaza SW15. The property benefits from a large spacious open plan fitted kitchen with breakfast area and appliances, wood flooring, two good sized bedrooms, master with fitted storage space and en suite and family bathroom and a private balcony providing views across London. Parking bay available through separate negotiation.

Surrounded by a plethora of great restaurants, cafes, bars and supermarkets which include Waitrose and Co-op on your doorstep, the outdoor spaces of Wandsworth Park and the River Thames are in easy reach, while the popular Fulham Palace Garden is only ten minutes away. Moments from either Putney Mainline or East Putney Underground Station.

Putney Plaza offers residents 24-hour concierge, lift access, fitness facilities and a large communal roof terrace with exceptional views across London.

Local Authority:	Wandsworth London
Council Tax Band:	D
EPC:	B
Security deposit:	equivalent to 5 weeks' rent

Floorplan

714 sq ft | 66.33 sq m

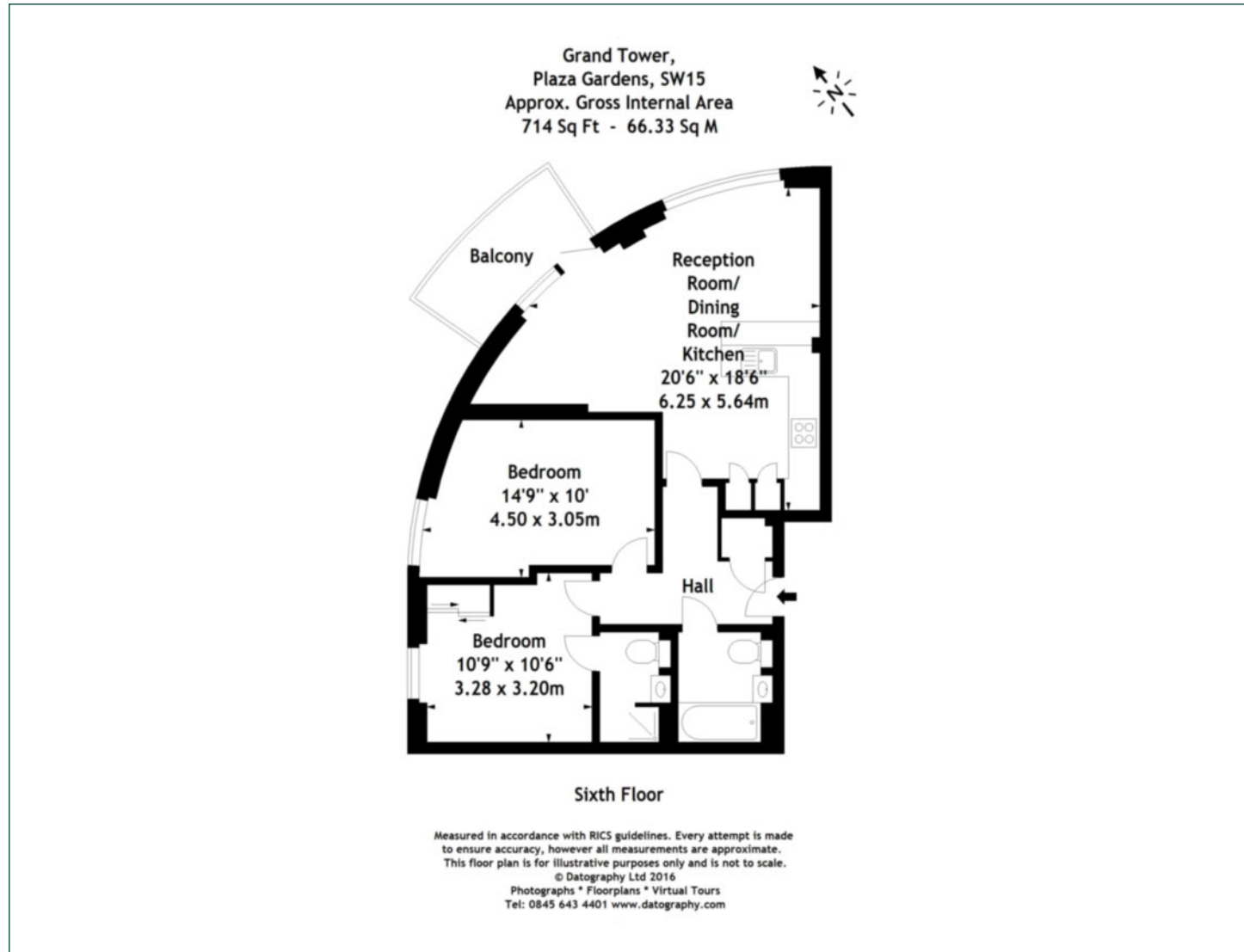

Elephant & Castle

One The Elephant, 5 St Gabriel Walk, London, SE1 6FG

Lettings

020 3869 2888 | eandc.lettings@chaseevans.com

We're here to help.

IMPORTANT NOTICE - These particulars have been prepared in good faith and they are not intended to constitute part of an offer or contract. We have not performed a structural survey on this property and the services, appliances and specific fittings have not been tested. All photographs, measurements, floor plans and distances referred to are given as a guide and should not be relied upon.

chaseevans.com

 Chase Evans