



## The Tower, One The Elephant, St Gabriel Walk, Elephant & Castle, SE1

Price **£585 per week** | Furnished



# The Tower, One The Elephant, St Gabriel Walk, Elephant & Castle, SE1



1 Bedroom



1 Bathroom



1 Reception



Balcony



Local Amenities



24-Hour Concierge



0.4 MI Elephant & Castle

A luxury one bedroom apartment with a balcony in One The Elephant, the landmark tower a stone's throw from all the amenities of Elephant and Castle centre. The bright open-plan kitchen/ living area features large glazing, wood flooring, gloss kitchen cabinetry and high end appliances. The ample bedroom has a fitted wardrobe and there is a smart, modern bathroom.

Residents will also have access to a 24-hour concierge service and communal reading garden. There are several amenities located nearby including bars, restaurants, cafés, a large sports

centre and the new park at the Elephant Park development. The development is located a short distance from Elephant and Castle station, providing Underground and rail services.

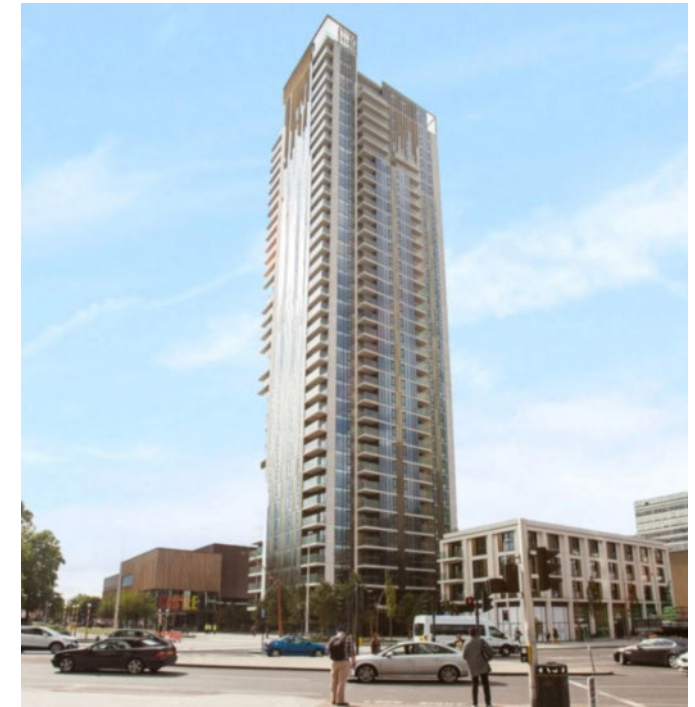

**Local Authority:**

Southwark Council

**Council Tax Band:**

D

**EPC:**

B

**Security deposit:**

equivalent to 5 weeks' rent

# Floorplan

539 sq ft | 50.1 sq m

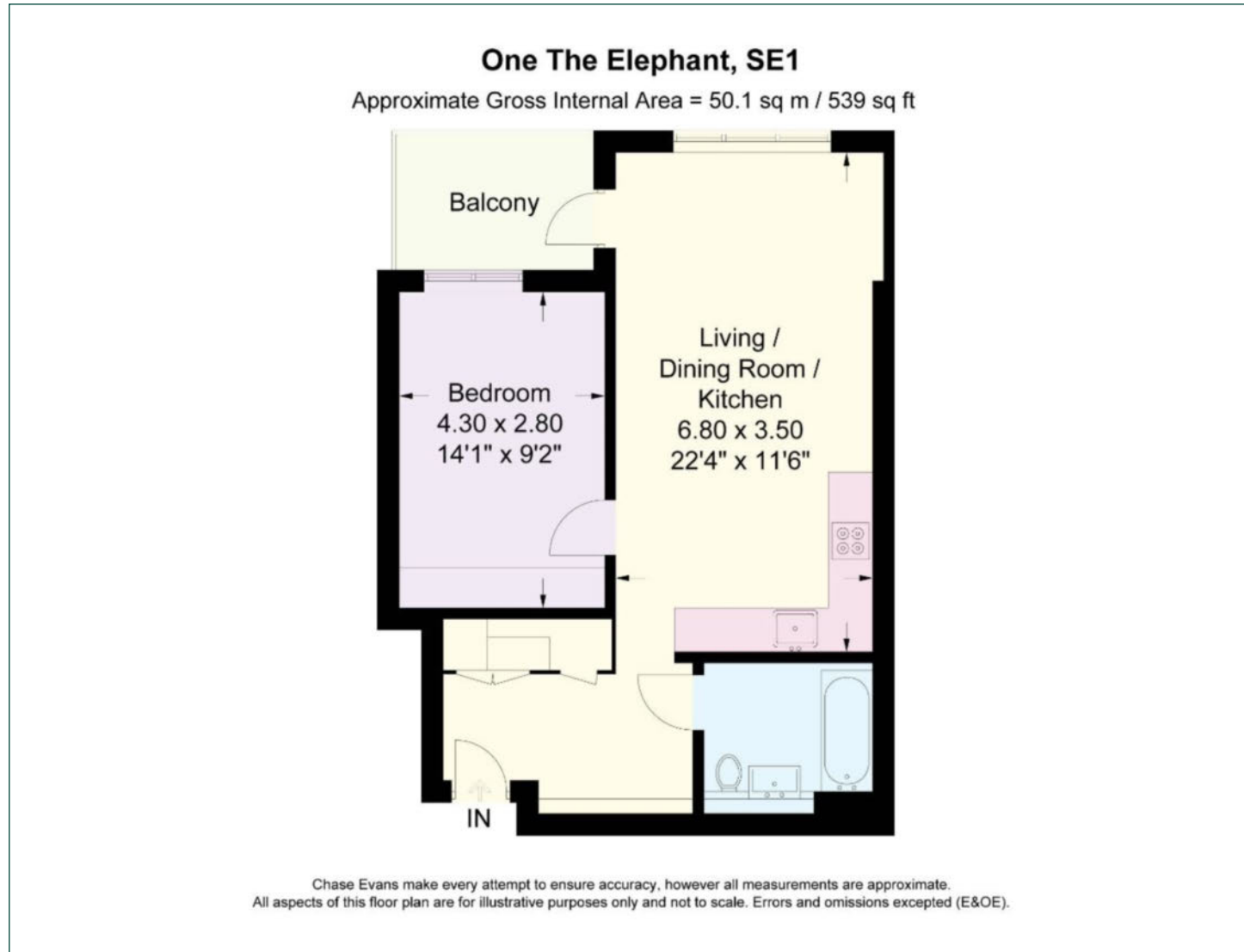

## Elephant & Castle

One The Elephant, 5 St Gabriel Walk, London, SE1 6FA

## Lettings

020 3869 2888 | [eandc.lettings@chaseevans.com](mailto:eandc.lettings@chaseevans.com)

## We're here to help.

IMPORTANT NOTICE - These particulars have been prepared in good faith and they are not intended to constitute part of an offer or contract. We have not performed a structural survey on this property and the services, appliances and specific fittings have not been tested. All photographs, measurements, floor plans and distances referred to are given as a guide and should not be relied upon.

[chaseevans.com](http://chaseevans.com)