



Weymouth Building, Elephant Park, Deacon Street, Elephant & Castle, SE17

Price **£795 per week** | Furnished



Weymouth Building, Elephant Park, Deacon Street, Elephant & Castle, SE17



2 Bedrooms



2 Bathrooms



1 Reception



Balcony



Gymnasium



Local Amenities



24-Hour Concierge



0.3 MI Elephant & Castle

A delightful two bedroom, two bathroom apartment with a balcony set within Weymouth Building, Elephant Park SE17. Comprising a naturally bright living area opening onto the balcony and featuring full height windows and wood flooring, a bespoke modern fitted kitchen with smart integrated appliances, two ample double bedrooms with fitted wardrobes and two bathrooms (master ensuite).

Residents have access to 24-hour Concierge and access to a gym, communal gardens and lounge. The development is located close to Elephant and

Castle National Rail and Underground stations, providing Underground and Rail services for commutes towards the City and West End. The property is serviced by Thameslink, Southeastern, Bakerloo and Northern Line, opening up a plethora of transport links.



Local Authority:

Southwark Council

Council Tax Band:

E

EPC:

B

Security deposit:

equivalent to 5 weeks' rent

Floorplan

787 sq ft | 73.1 sq m

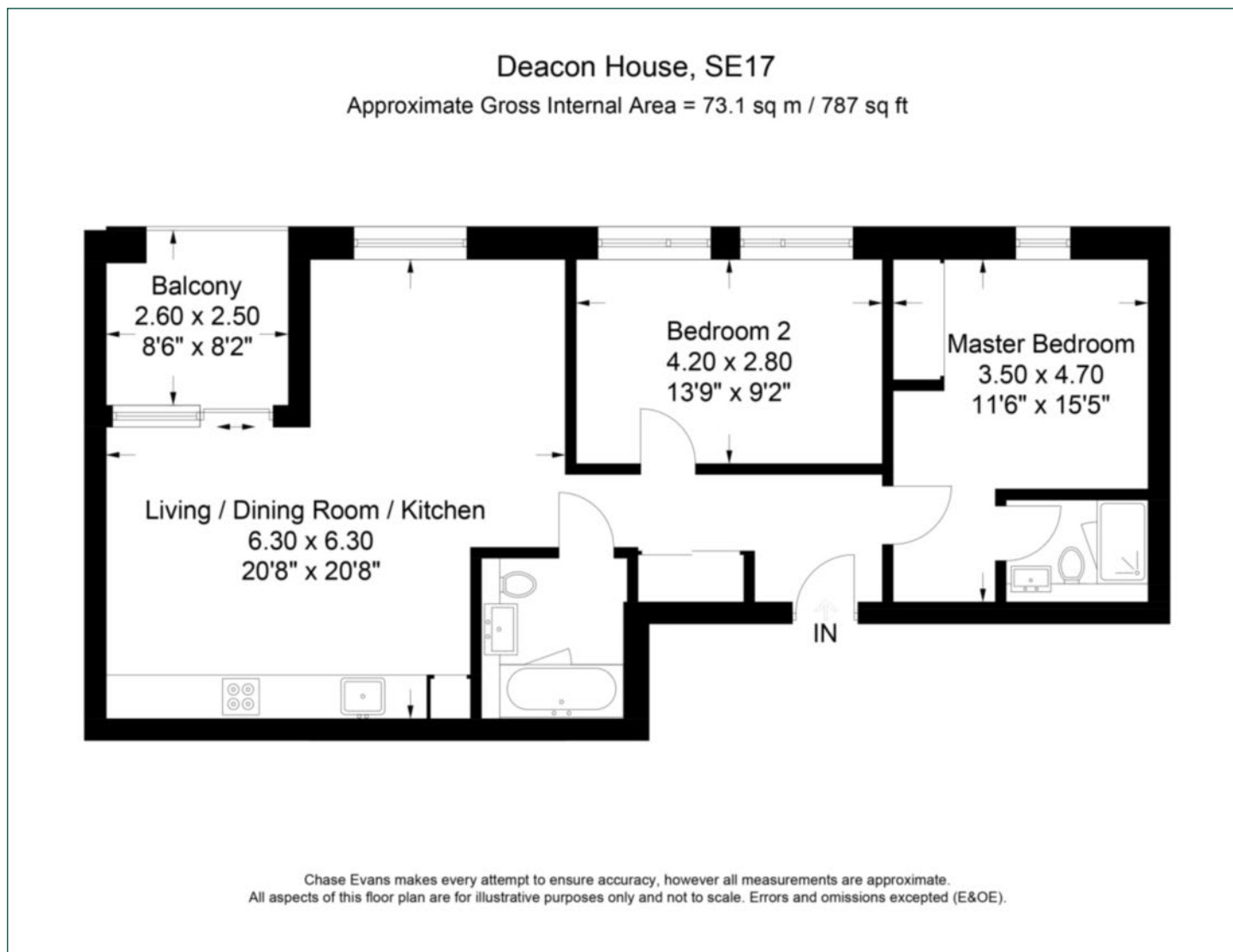

Elephant & Castle

One The Elephant, 5 St Gabriel Walk, London, SE1 6FA

Lettings

020 3869 2888 | eandc.lettings@chaseevans.co.uk

We're here to help.

IMPORTANT NOTICE - These particulars have been prepared in good faith and they are not intended to constitute part of an offer or contract. We have not performed a structural survey on this property and the services, appliances and specific fittings have not been tested. All photographs, measurements, floor plans and distances referred to are given as a guide and should not be relied upon.

chaseevans.com