











## Wansey Street, Elephant Park, Elephant & Castle, SE17

Price **£995 per week** | Furnished





# Wansey Street, Elephant Park, Elephant & Castle, SE17

-  3 Bedrooms
-  3 Bathrooms
-  1 Reception
-  Front & Back Gardens
-  Private & Communal Terraces
-  24-Hour Concierge
-  Communal Gardens
-  Near Elephant Park & Markets
-  0.4 MI Elephant & Castle

\*PHOTOS FOR ILLUSTRATIVE PURPOSES ONLY\*

Bright three bedroom, three bathroom townhouse with substantial outdoor space and access to private communal gardens in the impressive Elephant Park, a short walk from Elephant & Castle tube station. Arranged over three floors, the accommodation extends onto an attractive back patio garden and its own private top floor terrace.

On the ground floor are the kitchen/ diner, guest cloakroom and an informal living room which opens onto the back patio garden. Two double bedrooms and a family bathroom occupy the first floor. The master bedroom with an en suite shower and the private terrace are configured on the second floor and there is access to private

communal gardens at the rear.

The development provides 24 hour concierge services, access to residents' lounge, communal gardens and a roof terrace. Elephant Park is a beautifully landscaped and maintained 0.4 hectares of green space nearby featuring mature trees, play trails and a lively performance area. Also close to the development is Merkato Metropolitan, a popular food market with a mixture of Italian and London based producers offering an astonishing array of quality food and drinks in an attractive and lively indoor space.

The nearby Elephant and Castle station provides Underground and National Rail services.

**Local Authority:** Southwark Council

---

**Council Tax Band:** G

---

**EPC:** B

---

**Security deposit:** equivalent to 5 weeks' rent

---

# Floorplan

1,174 sq ft | 109.1 sq m

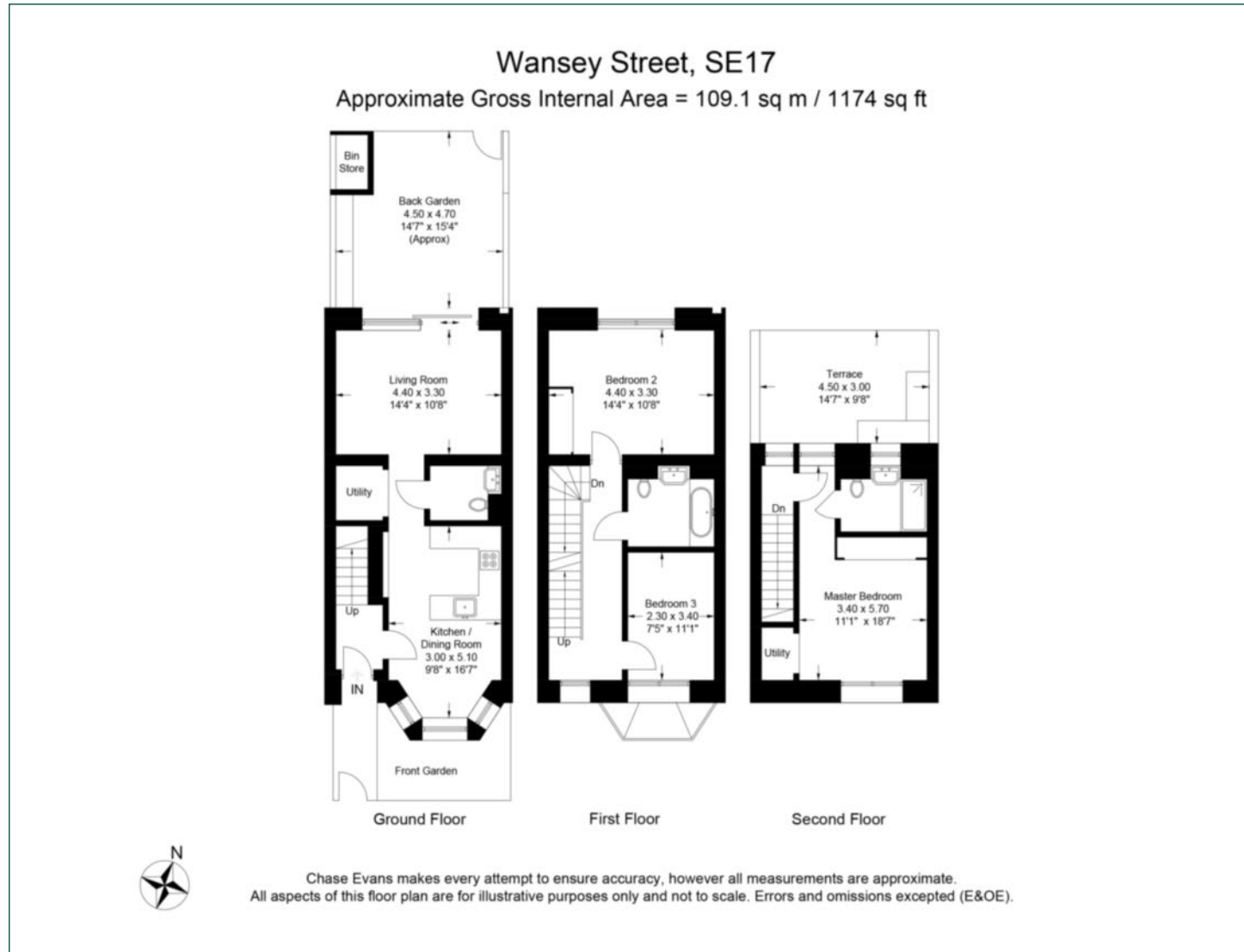

## Elephant & Castle

One The Elephant, 5 St Gabriel Walk, London, SE1 6FA

## Lettings

020 3869 2888 | [eandc.lettings@chaseevans.com](mailto:eandc.lettings@chaseevans.com)

## We're here to help.

IMPORTANT NOTICE - These particulars have been prepared in good faith and they are not intended to constitute part of an offer or contract. We have not performed a structural survey on this property and the services, appliances and specific fittings have not been tested. All photographs, measurements, floor plans and distances referred to are given as a guide and should not be relied upon.

[chaseevans.com](http://chaseevans.com)

 Chase Evans