











## Belfield Mansions, Park & Sayer, Elephant and Castle, SE17

Price **£785 per week** | Furnished



# Belfield Mansions, Park & Sayer, Elephant and Castle, SE17

-  2 Bedrooms
-  2 Bathrooms
-  1 Reception
-  Private Terrace
-  Gym
-  Communal Terrace
-  Cycle Storage
-  24-Hour Concierge
-  0.5 MI Elephant & Castle

New luxury two-bedroom apartment with a balcony in Park & Sayer, Elephant Park, close to amenities of Elephant and Castle, SE17. The accommodation comprises an open-plan kitchen/living room, a master bedroom with an en suite bathroom, a second double bedroom and a further family bathroom.

Features include engineered wood flooring, underfloor heating, custom kitchen cabinetry, high-quality integrated appliances, utility cupboard with washer/dryer, a built-in wardrobe with sliding doors, and contemporary bathroom ware and tiling.

Residents have access to a 24-hour concierge, an onsite gym and a residential roof terrace.

Elephant Park is a regeneration success story that has delivered quality housing, beautifully landscaped squares, courtyards and gardens and a great selection of local shops, cafes and restaurants. The neighbourhood of Park & Sayer is very close to Elephant and Castle Tube (Travel Zone 1) and the National Rail Station providing superb connections with the West End, the City, Canary Wharf, and more other terminations across London.

**Local Authority:** Southwark

**Council Tax Band:** TBA

**EPC:** B

**Security deposit:** equivalent to 5 weeks' rent

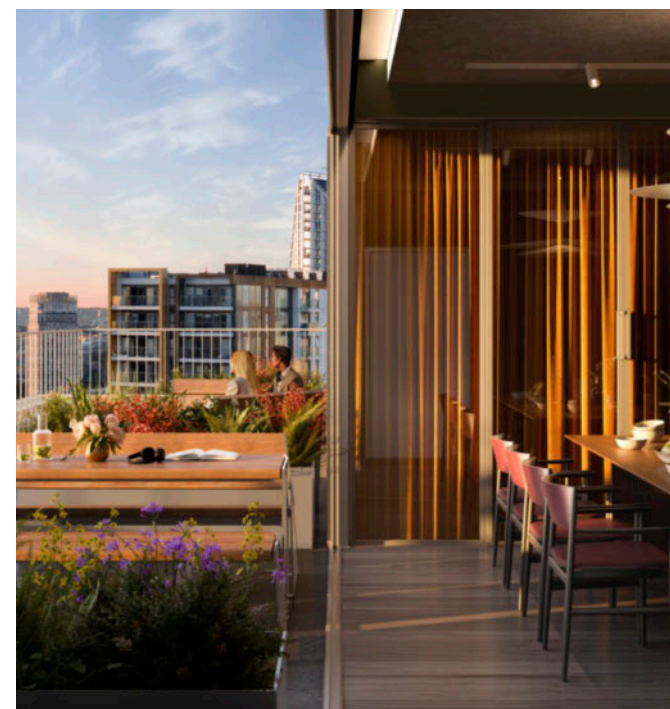

# Floorplan

864 sq ft | 80.3 sq m

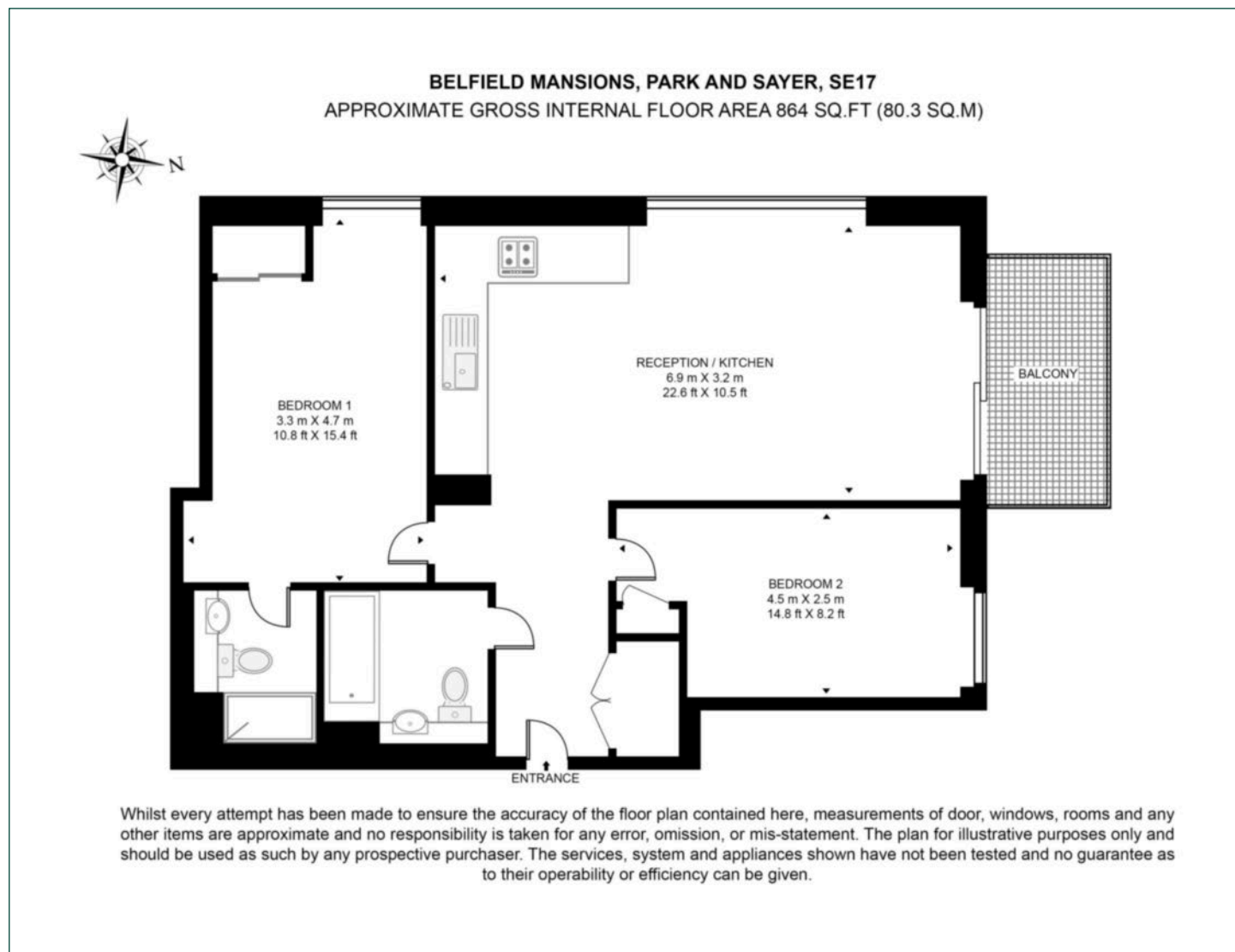

## Elephant & Castle

One The Elephant, 5 St Gabriel Walk, London, SE1 6FG

## Lettings

020 3869 2888 | [eandc.lettings@chaseevans.com](mailto:eandc.lettings@chaseevans.com)

## We're here to help.

IMPORTANT NOTICE - These particulars have been prepared in good faith and they are not intended to constitute part of an offer or contract. We have not performed a structural survey on this property and the services, appliances and specific fittings have not been tested. All photographs, measurements, floor plans and distances referred to are given as a guide and should not be relied upon.

[chaseevans.com](http://chaseevans.com)

 Chase Evans