



## Providence Square, Shad Thames, London, SE1

Price **£625 per week** | Furnished



# Providence Square, Shad Thames, London, SE1



2 Bedrooms



2 Bathrooms



1 Reception



Parking



Concierge Services



Gymnasium



Local Amenities



0.4 MI Bermondsey

A two bedroom apartment set within a modern riverside development located near Tower Bridge. This furnished apartment includes a spacious living area, separate fitted kitchen with integrated appliances, wood flooring, full length windows, master en suite and a private balcony.

Residents have access to a concierge service, gymnasium, parking and a sauna. There are amenities located nearby including restaurants, cafés, shops and pubs. Butler's Wharf Pier provides several places to enjoy a drink or a meal beside the Thames, with Tower Bridge as a backdrop. The

development is located near Bermondsey Underground station, providing a valuable transport link for commutes across the Capital.

**Local Authority:** Southwark Council

---

**Council Tax Band:** E

---

**EPC:** C

---

**Security deposit:** equivalent to 5 weeks' rent

---

# Floorplan

744 sq ft | 69.12 sq m

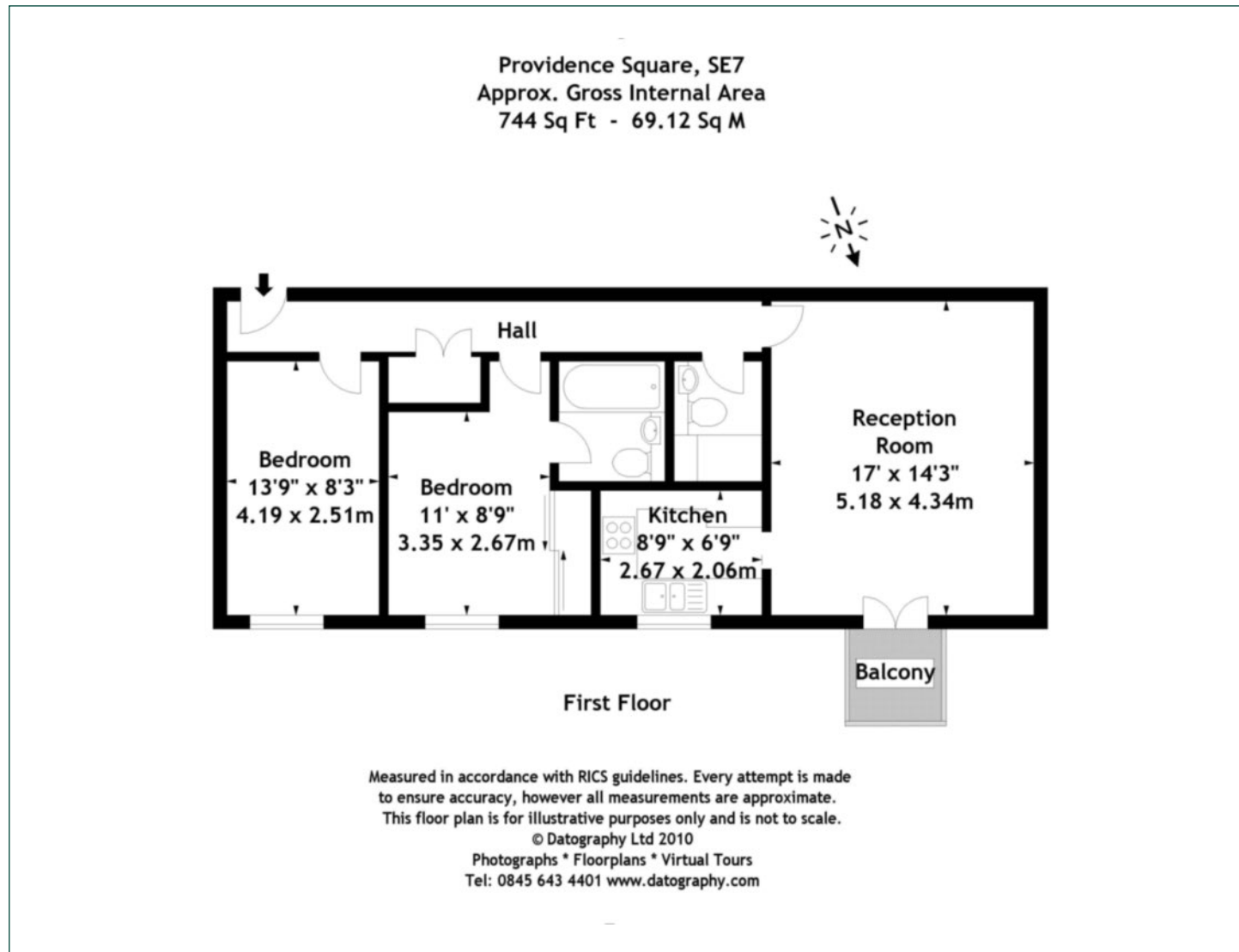

## Elephant & Castle

One The Elephant, 5 St Gabriel Walk, London, SE1 6FA

## Lettings

020 3869 2888 | eandc.lettings@chaseevans.co.uk

## We're here to help.

IMPORTANT NOTICE - These particulars have been prepared in good faith and they are not intended to constitute part of an offer or contract. We have not performed a structural survey on this property and the services, appliances and specific fittings have not been tested. All photographs, measurements, floor plans and distances referred to are given as a guide and should not be relied upon.

[chaseevans.com](http://chaseevans.com)

 Chase Evans