

Keybridge Capital, Exchange Gardens, Vauxhall, SW8

Asking price **£600,000** | Leasehold



Keybridge Capital, Exchange Gardens, Vauxhall, SW8



1 Bedroom



1 Bathroom



1 Reception



Balcony



Gymnasium



Local Amenities



24-Hour Concierge



0.1 MI Nine Elms

Stylish & modern one bedroom property set within the latest phase of the Keybridge development located in the heart of Vauxhall, SW8.

This apartment offers an open plan kitchen/ living and dining space leading onto a private balcony, wood flooring, floor to ceiling glazing, recessed lighting, modern kitchen, large bedroom features built in storage, stunning bathroom with stylish fittings.

Residents will soon benefit from extensive leisure facilities to include a pool, sauna & gymnasium.

There are several amenities located including all the new restaurants, cafés and shops in Embassy Gardens and Nine Elms.

Vauxhall Park, Battersea Park and the Thames Patch offer green spaces that are ideal for leisure activities. The apartment is less than 10mins walk from Vauxhall station, providing access to Underground and rail services linking the development with destinations across London.

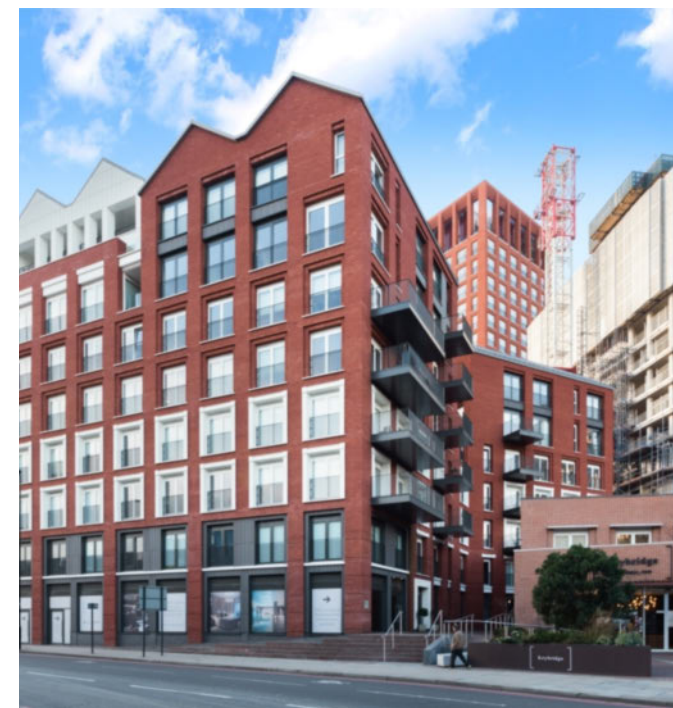

Tenure: Leasehold (994 years remaining)

Local Authority: Lambeth London

Ground Rent: £500 p.a.

Council Tax Band: G

Service Charge: £3,299 p.a.

EPC: B

Floorplan

546 sq ft | 50.7 sq m

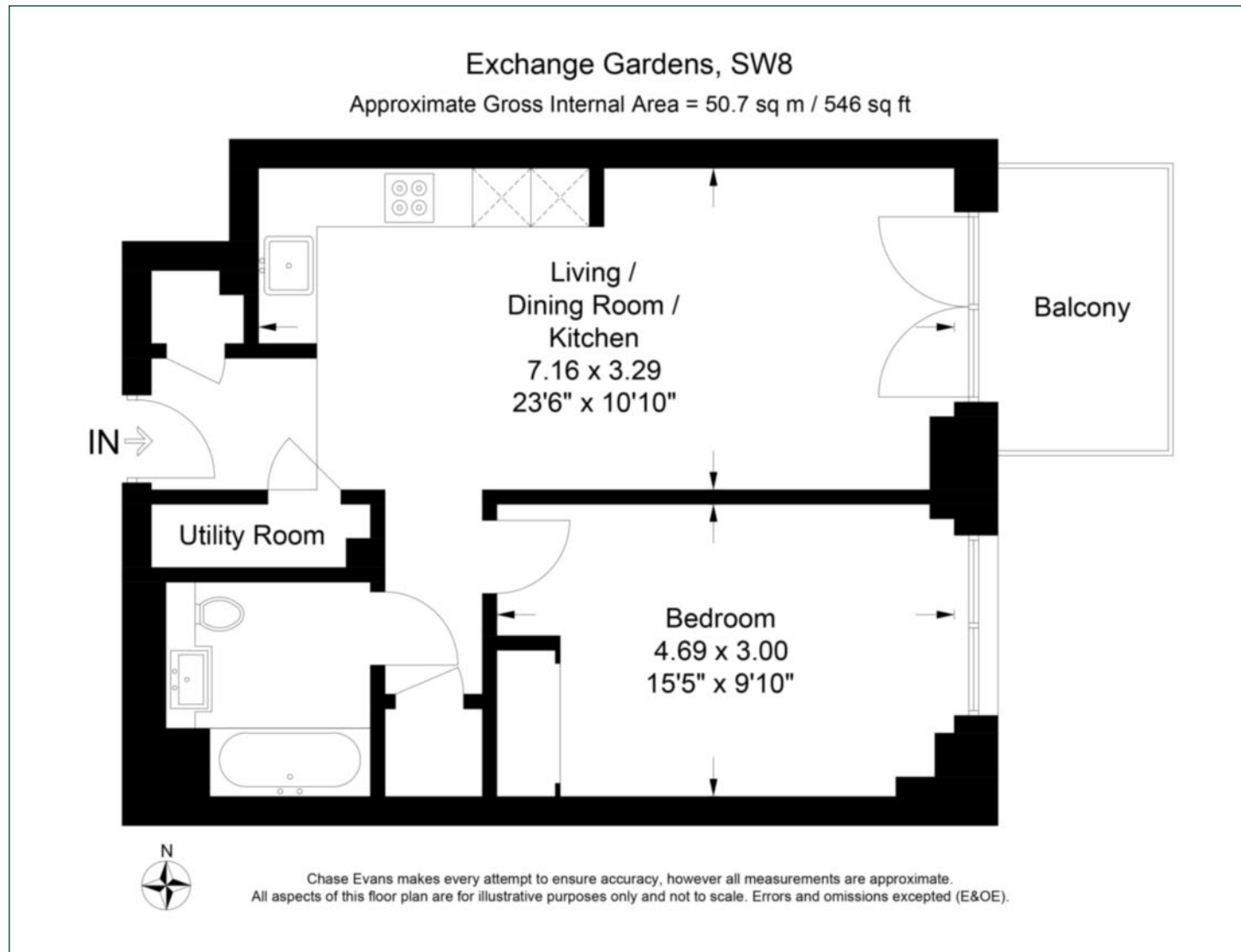

Elephant & Castle

One The Elephant, 5 St Gabriel Walk, London, SE1 6FA

Sales

020 3869 2888 | eandc.lettings@chaseevans.co.uk

We're here to help.

IMPORTANT NOTICE - These particulars have been prepared in good faith and they are not intended to constitute part of an offer or contract. We have not performed a structural survey on this property and the services, appliances and specific fittings have not been tested. All photographs, measurements, floor plans and distances referred to are given as a guide and should not be relied upon.

[chaseevans.com](https://www.chaseevans.com)

 Chase Evans