



## Strata Tower, Walworth Road, Elephant & Castle, SE1

Asking price **£675,000** | Leasehold



# Strata Tower, Walworth Road, Elephant & Castle, SE1



2 Bedrooms



2 Bathrooms



1 Reception



Local Amenities



24-Hour Concierge



0.1 MI Elephant & Castle

A beautifully presented two bedroom apartment set in The Strata Tower, SE1 an iconic residential building rising forty-three stories above Elephant & Castle.

This fantastic property boasts far reaching views of London, accommodation spans 702 sq ft and includes an spacious open plan living room, sleek fully integrated kitchen, wood flooring, high ceilings, two sizable bedrooms, master with fitted wardrobe space and en suite, pristine bathroom suite. Ample hallway storage.

Residents also enjoy a 24-hour concierge. The property benefits from being within close proximity to excellent local amenities and transport links of Elephant & Castle, with underground & overground services a short walk from the development. The property is serviced by Thameslink, Southeastern, Bakerloo and Northern Line, opening up a plethora of transport options.

**Tenure:** Leasehold (110 years remaining) **Local Authority:** Southwark Council

**Ground Rent:** £375 p.a. **Council Tax Band:** E

**Service Charge:** £5,199 p.a. **EPC:** B

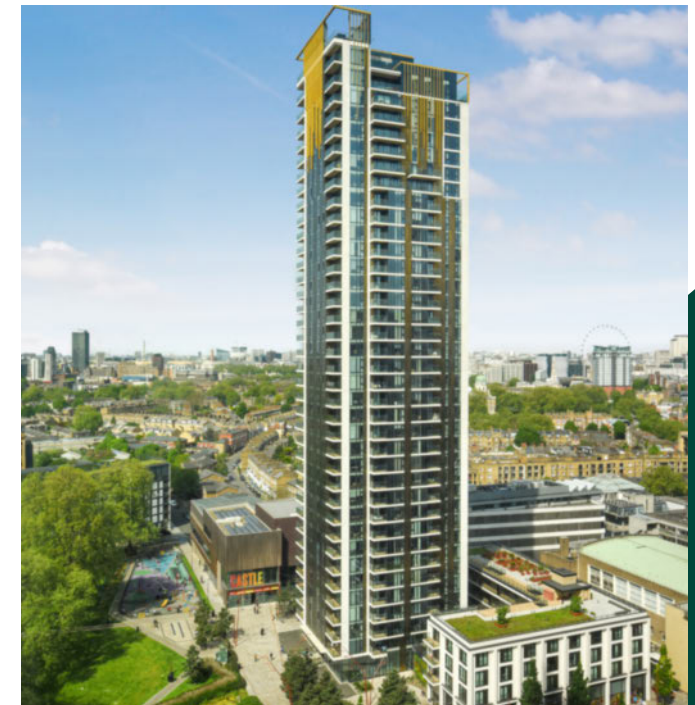

# Floorplan

702 sq ft | 65.2 sq m

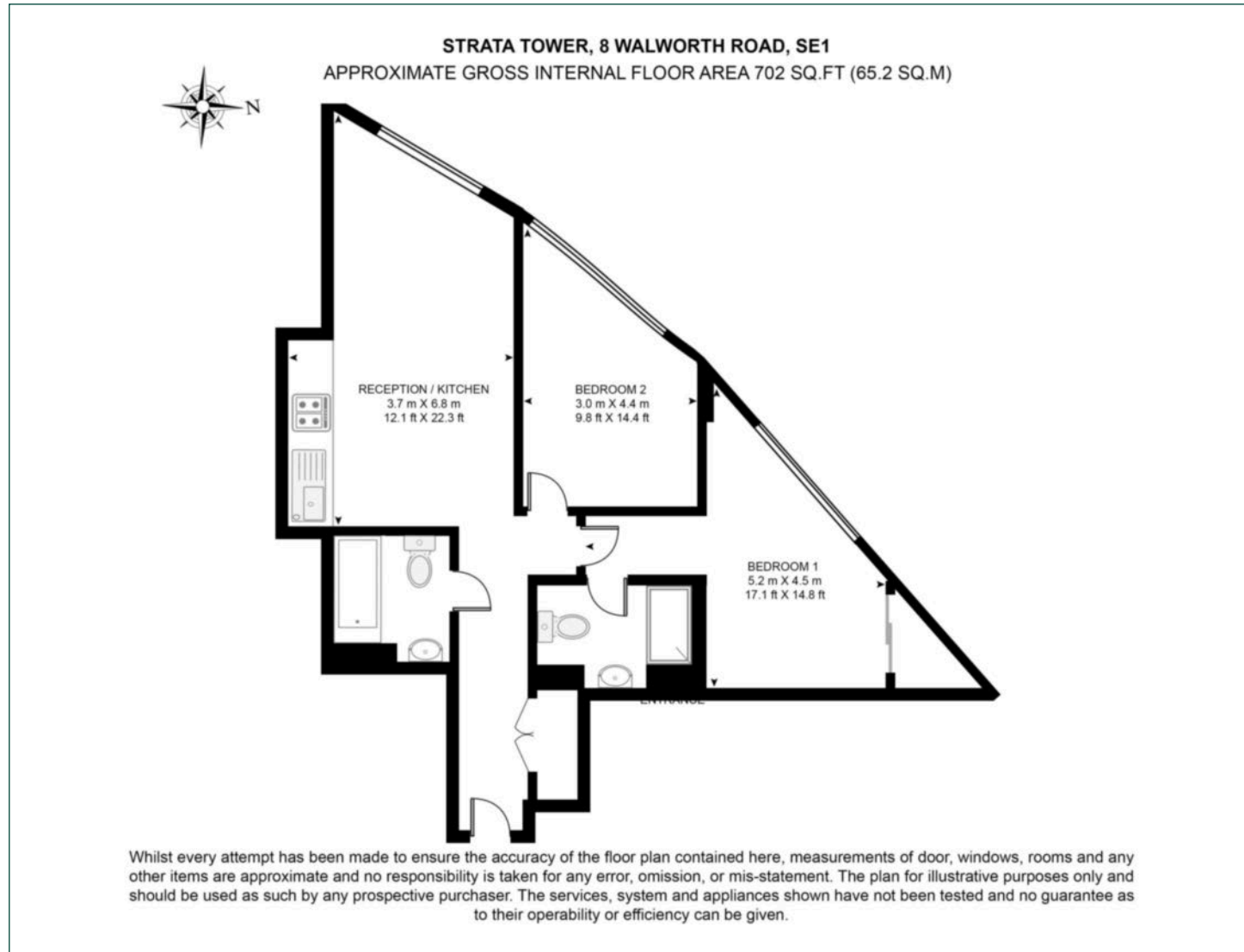

## Elephant & Castle

One The Elephant, 5 St Gabriel Walk, London, SE1 6FG

## Sales

020 3869 2898 | [eandc.sales@chaseevans.com](mailto:eandc.sales@chaseevans.com)

## We're here to help.

IMPORTANT NOTICE - These particulars have been prepared in good faith and they are not intended to constitute part of an offer or contract. We have not performed a structural survey on this property and the services, appliances and specific fittings have not been tested. All photographs, measurements, floor plans and distances referred to are given as a guide and should not be relied upon.

[chaseevans.com](http://chaseevans.com)

 Chase Evans