

Levy Building, Elephant Park, Heygate Street, Elephant & Castle, SE17

Price **£950 per week** | Furnished



Levy Building, Elephant Park, Heygate Street, Elephant & Castle, SE17



3 Bedrooms



2 Bathrooms



1 Reception



Large Balcony



Secure Cycle Storage



Gymnasium



Local Amenities



24-Hour Concierge



0.3 MI Elephant & Castle

Bright and spacious three-bedroom, two-bathrooms apartment with a balcony in Elephant Park, Elephant & Castle SE17. Comprising a dual aspect, open plan kitchen/living room leading to an additional 248 sq ft private balcony, three large double bedrooms with fitted wardrobes including master en suite bathroom, and an additional tiled family bathroom.

Residents benefit from an array of facilities which includes a gymnasium, communal gardens, secure cycle storage and a 24-hour concierge service. The development is located close to Elephant and

Castle National Rail and Underground stations, providing Underground and Rail services for commutes towards the City and West End by Thameslink, Southeastern, Bakerloo and Northern lines, opening up a plethora of transport links.



Local Authority:

Southwark Council

Council Tax Band:

E

EPC:

B

Security deposit:

equivalent to 5 weeks' rent

Floorplan

946 sq ft | 87.9 sq m

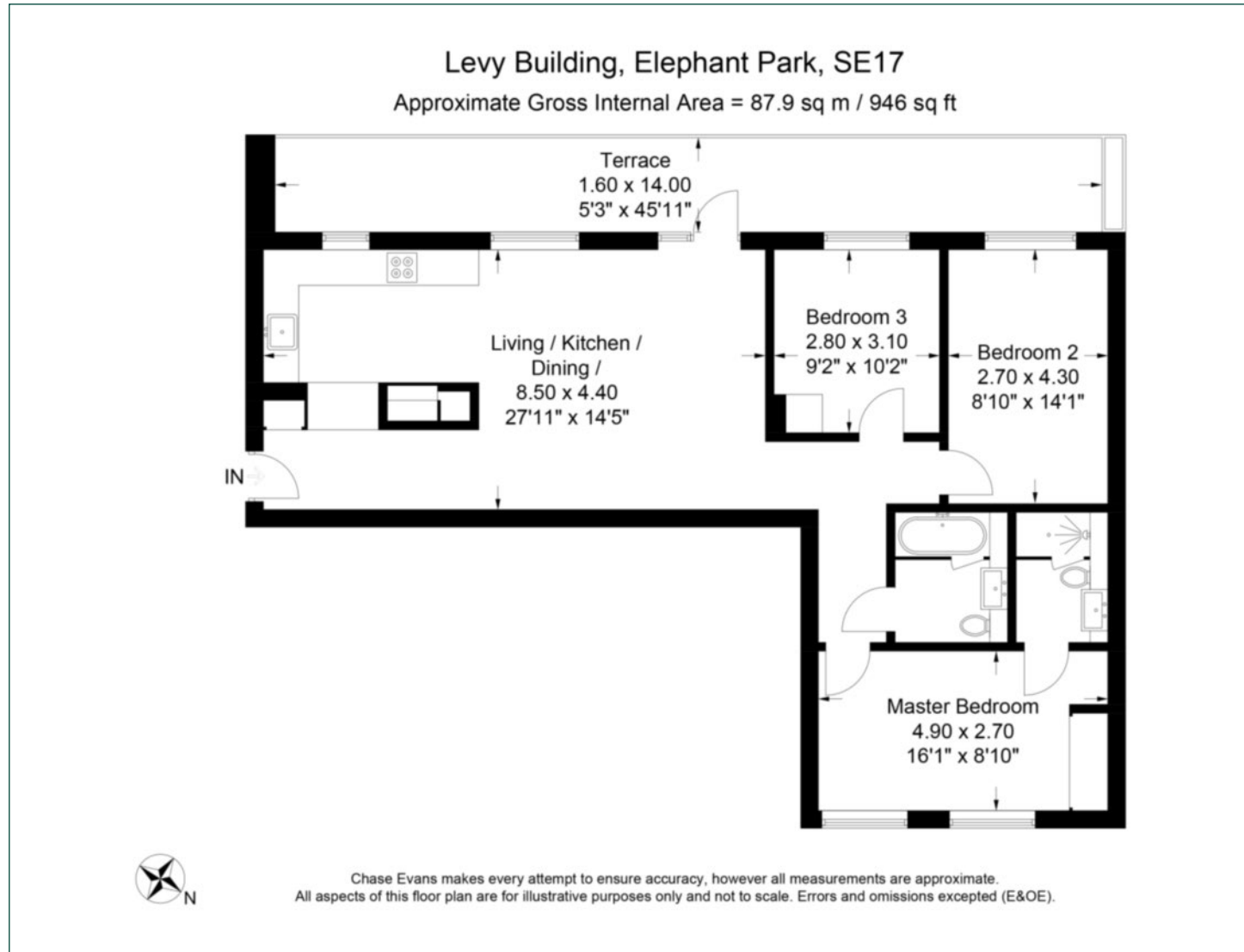

Elephant & Castle

One The Elephant, 5 St Gabriel Walk, London, SE1 6FA

Lettings

020 3869 2888 | eandc.lettings@chaseevans.co.uk

We're here to help.

IMPORTANT NOTICE - These particulars have been prepared in good faith and they are not intended to constitute part of an offer or contract. We have not performed a structural survey on this property and the services, appliances and specific fittings have not been tested. All photographs, measurements, floor plans and distances referred to are given as a guide and should not be relied upon.

chaseevans.com

 Chase Evans