

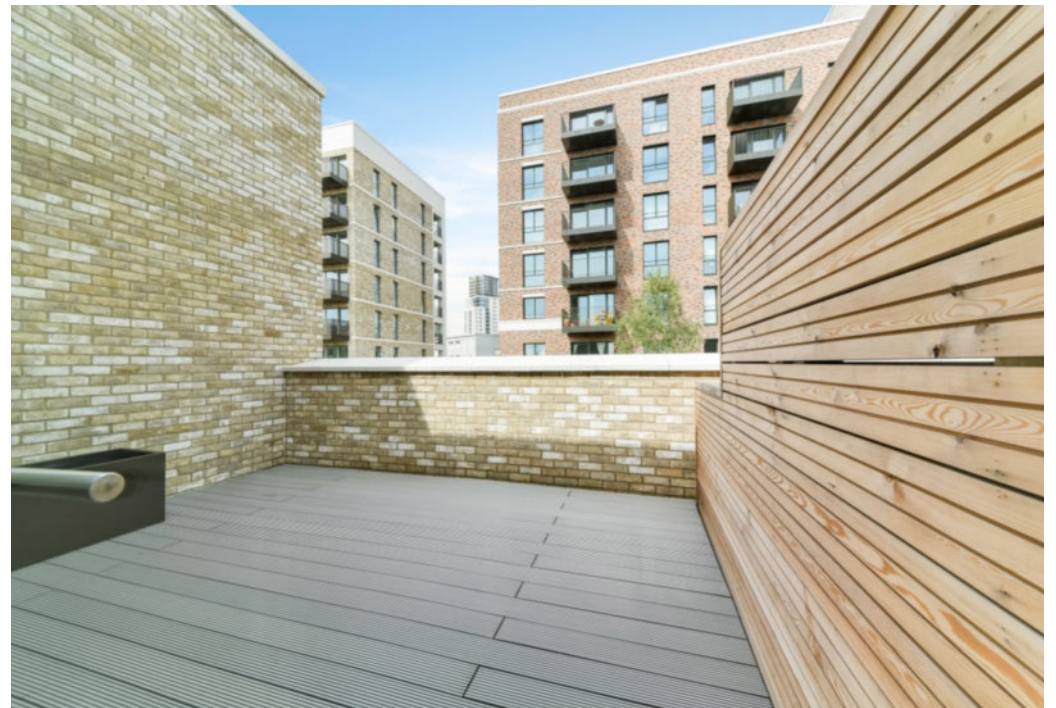

## Wansey Street, Elephant Park, Elephant & Castle, SE17

Asking price **£1,275,000** | Leasehold

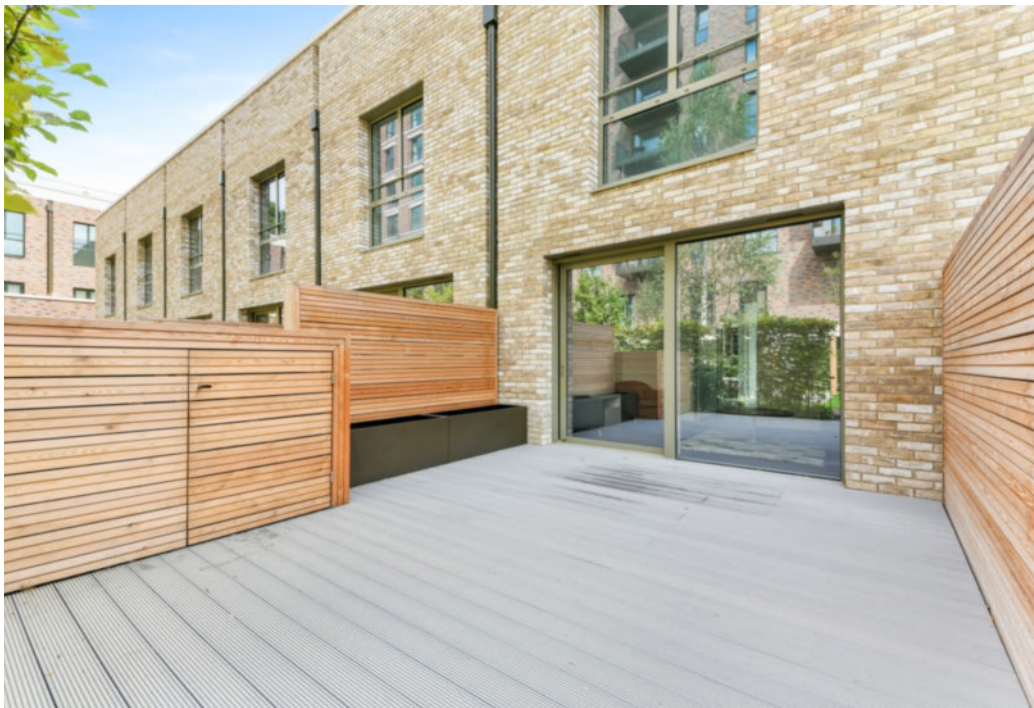

# Wansey Street, Elephant Park, Elephant & Castle, SE17



3 Bedrooms



2 Bathrooms



1 Reception



2 Gardens



Roof Terrace



Local Amenities



24-Hour Concierge



0.2 MI Elephant & Castle

A spacious three bedroom, two bathroom townhouse substantial outdoor space and access to private communal gardens in the impressive Elephant Park, a short walk from all the amenities at Elephant and Castle SE17. Arranged over three floors, the accommodation extends onto an attractive back patio garden and its own private top floor terrace.

On the ground floor are the kitchen/ diner, guest cloakroom and an informal living room which opens onto the back patio garden. Two double bedrooms and a family bathroom occupy the first

floor. The master bedroom with an ensuite shower and the private terrace are configured on the second floor. and access to private communal gardens at the rear.

The development provides 24-hour concierge services, access to residents' lounge, communal gardens and a roof terrace. The development is located a short distance from Elephant and Castle station, which provides Underground and rail services.

**Tenure:** Leasehold (242 years remaining) **Local Authority:** Southwark Council

**Ground Rent:** £450 p.a. **Council Tax Band:** G

**Service Charge:** £9879.04 p.a. **EPC:** B

# Floorplan

1,192 sq ft | 110.08 sq m

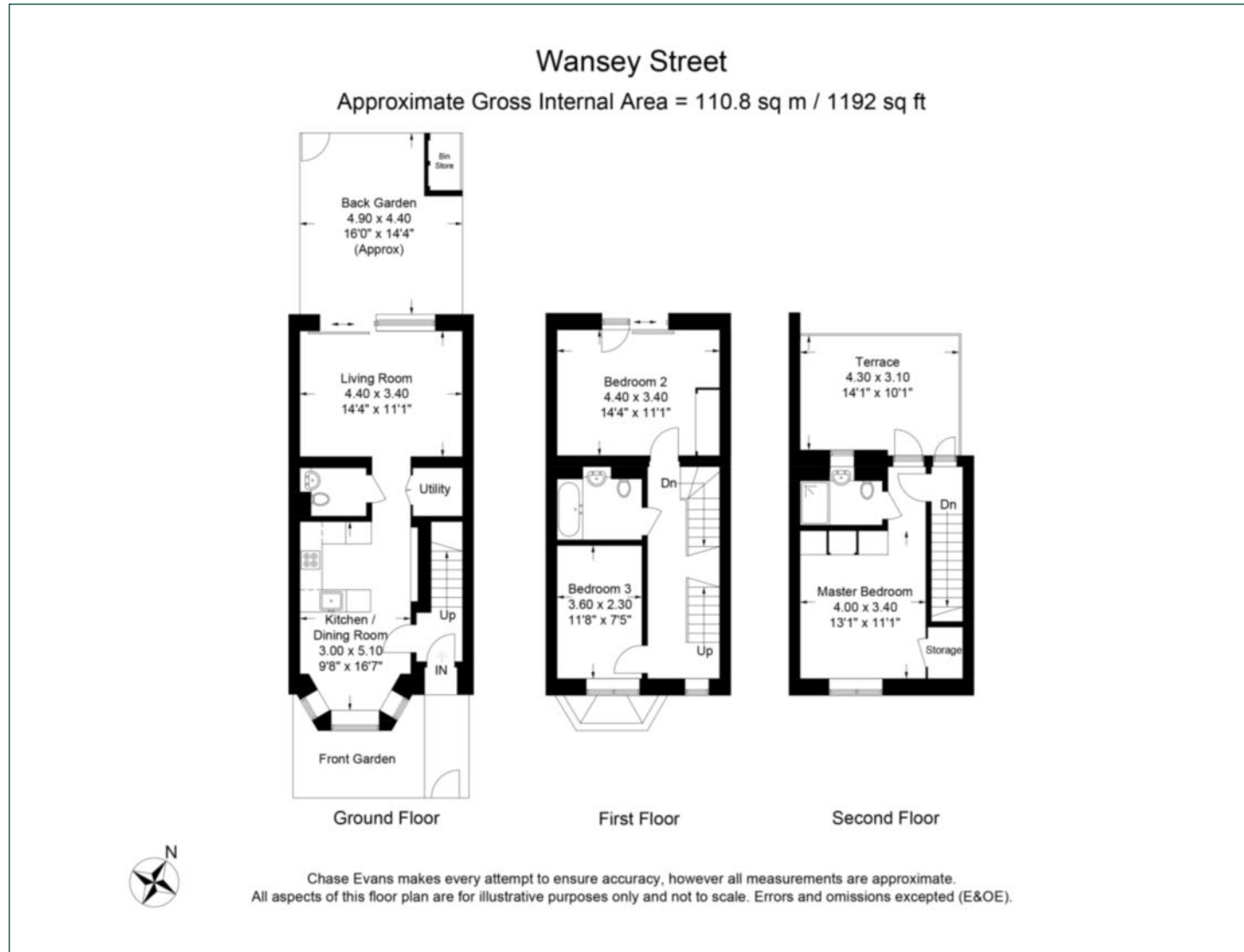

## Elephant & Castle

One The Elephant, 5 St Gabriel Walk, London, SE1 6FA

## Sales

020 3869 2888 | eandc.sales@chaseevans.co.uk

## We're here to help.

IMPORTANT NOTICE - These particulars have been prepared in good faith and they are not intended to constitute part of an offer or contract. We have not performed a structural survey on this property and the services, appliances and specific fittings have not been tested. All photographs, measurements, floor plans and distances referred to are given as a guide and should not be relied upon.

[chaseevans.com](https://www.chaseevans.com)

 Chase Evans