

Madeira Tower, The Residence, Ponton Road, Nine Elms, SW11

Price **£625 per week** | Furnished



Madeira Tower, The Residence, Ponton Road, Nine Elms, SW11



1 Bedroom



1 Bathroom



1 Reception



Balcony



Gymnasium



Local Amenities



24-Hour Concierge



0.2 MI Nine Elms

A contemporary one bedroom apartment within Madeira Tower, part of the luxurious 'The Residence' development, Nine Elms SW11. The property comprises a large open plan living, dining, and kitchen area, private balcony, sizeable master bedroom with built-in wardrobe and a modern bathroom suite. Also features engineered oak wood flooring, underfloor heating, and fully integrated appliances. Ample storage throughout.

Residents benefit from 24-hour concierge, gym, cinema, and communal gardens. The development benefits from direct access to Nine Elms

underground station (0.2 miles) and the Vauxhall transport hub is also just a short walk away, making the West End, City and Canary Wharf all able to reach in less than 30 minutes.



Local Authority: Wandsworth London

Council Tax Band: E

EPC: B

Security deposit: equivalent to 5 weeks' rent

Floorplan

538 sq ft | 50 sq m

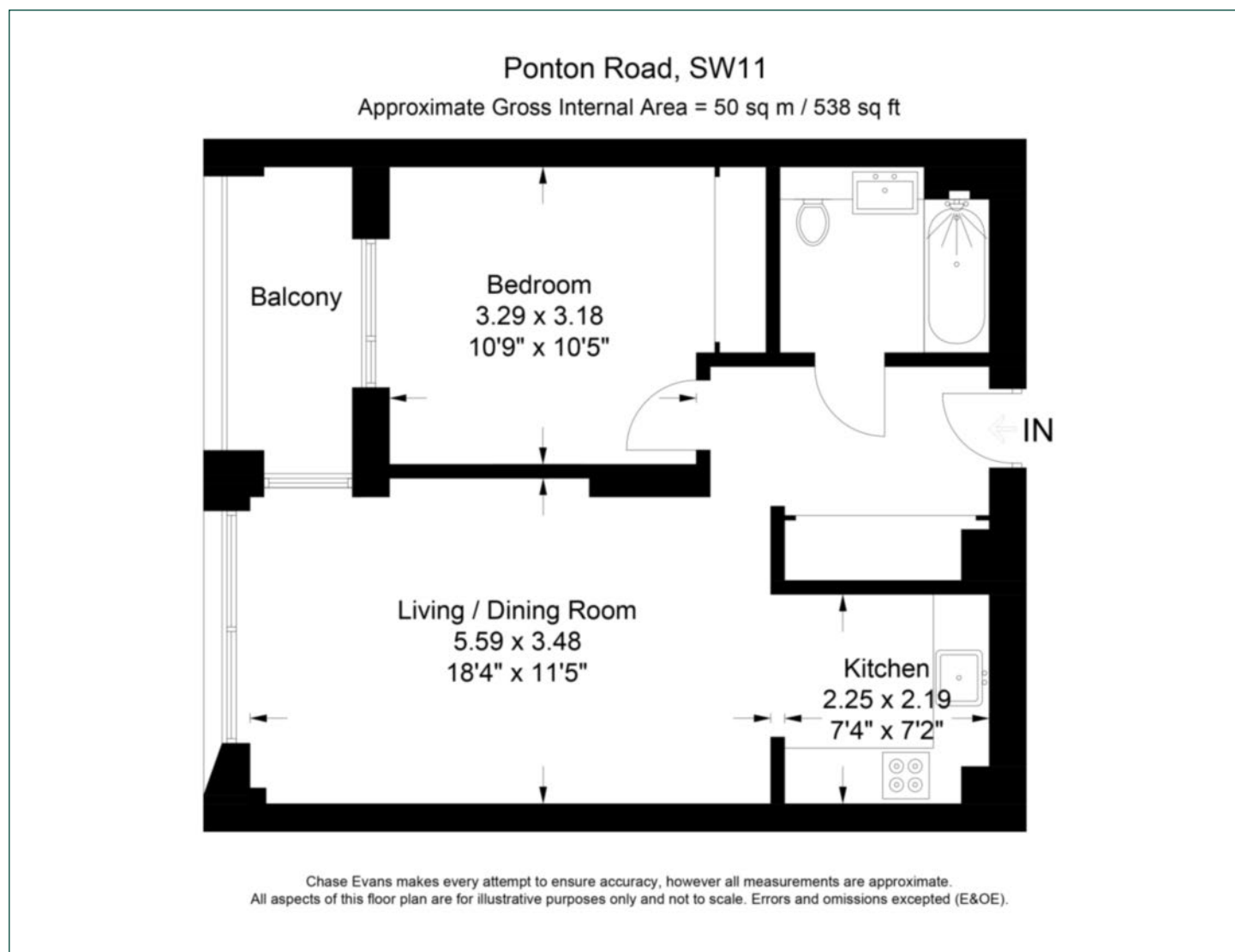

Elephant & Castle

One The Elephant, 5 St Gabriel Walk, London, SE1 6FA

Lettings

020 3869 2898 | eandc.lettings@chaseevans.co.uk

We're here to help.

IMPORTANT NOTICE - These particulars have been prepared in good faith and they are not intended to constitute part of an offer or contract. We have not performed a structural survey on this property and the services, appliances and specific fittings have not been tested. All photographs, measurements, floor plans and distances referred to are given as a guide and should not be relied upon.

chaseevans.com