



Rutherford Heights, Trafalgar Place, Rodney Road, Elephant & Castle, SE17

Price **£675 per week** | Furnished



Rutherford Heights, Trafalgar Place, Rodney Road, Elephant & Castle, SE17



2 Bedrooms



2 Bathrooms



1 Reception



Balcony



Secure Cycle Storage



Local Amenities



24-Hour Concierge



0.4 MI Elephant & Castle

A two bedroom, two bathroom, dual aspect, apartment set within Trafalgar Place, a desirable SE17 development in Elephant and Castle. Comprising a large balcony with easterly views, open plan living room, fully integrated kitchen with high quality appliances, en-suite to the master bedroom, and under floor heating throughout.

There are several on-site facilities that include 24-hour concierge services, communal roof terrace and cycle storage. Local amenities can be easily found close to the development and include several shops, bars and restaurants.

The development is located a short distance from Elephant and Castle station, which provides Underground and rail services. Residents will appreciate being a close to valuable transport link for commutes to London Bridge, Old Street and other key destinations located across the Capital.

Local Authority: Southwark Council

Council Tax Band: E

EPC: B

Security deposit: equivalent to 5 weeks' rent

Floorplan

825 sq ft | 76.6 sq m

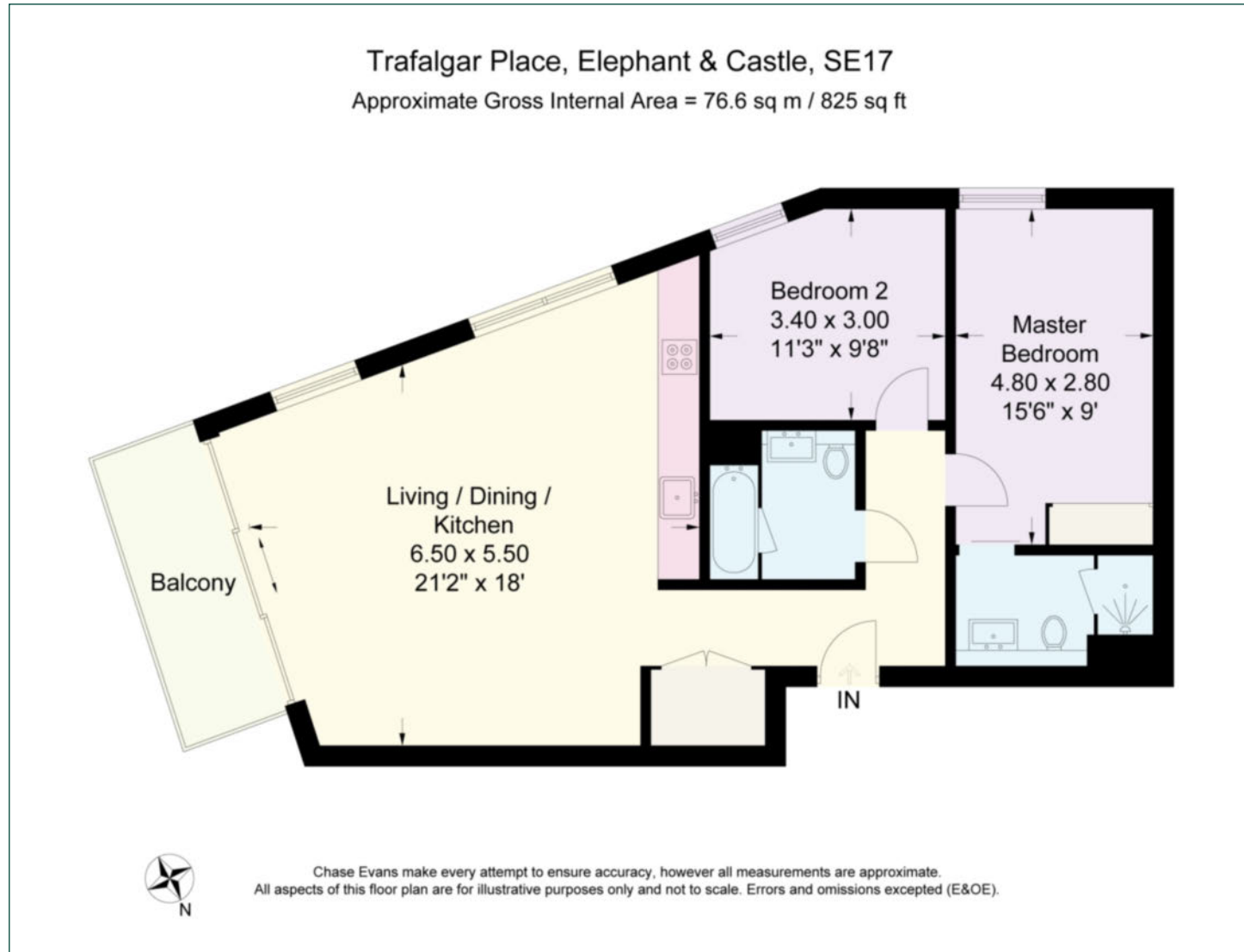

Elephant & Castle

One The Elephant, 5 St Gabriel Walk, London, SE1 6FG

Lettings

020 3869 2888 | eandc.lettings@chaseevans.com

We're here to help.

IMPORTANT NOTICE - These particulars have been prepared in good faith and they are not intended to constitute part of an offer or contract. We have not performed a structural survey on this property and the services, appliances and specific fittings have not been tested. All photographs, measurements, floor plans and distances referred to are given as a guide and should not be relied upon.

[chaseevans.com](https://www.chaseevans.com)

 Chase Evans