



Benbow House, New Globe Walk, London Bridge, SE1

Price **£695 per week** | Furnished



Benbow House, New Globe Walk, London Bridge, SE1



1 Bedroom



1 Bathroom



1 Reception



Private Terrace



Local Amenities



River Views



Concierge



0.6 MI London Bridge

Spacious one double bedroom apartment available designer furnished or unfurnished with access to a terrace set within Benbow House. The property benefits a large living area, contemporary kitchen with integrated appliances, wood flooring, floor to ceiling glazing, sizeable bedroom with built in wardrobe and also patio access, modern bathroom suite.

Further benefits are the concierge service and private allocated parking.

Benbow House is a sought-after development with

a concierge and proximity to the City of London, which is just a stroll across the pedestrian bridge. The apartment is a short walk away from London Bridge Rail and Underground. The new Blackfriars Rail and Overground station is also nearby as are many cafes, restaurants, galleries, markets (Borough) and museums (Tate Modern) along this stretch of the Thames' south bank.

Local Authority: Southwark Council

Council Tax Band: E

EPC: C

Security deposit: equivalent to 5 weeks' rent

Floorplan

527 sq ft | 48.96 sq m

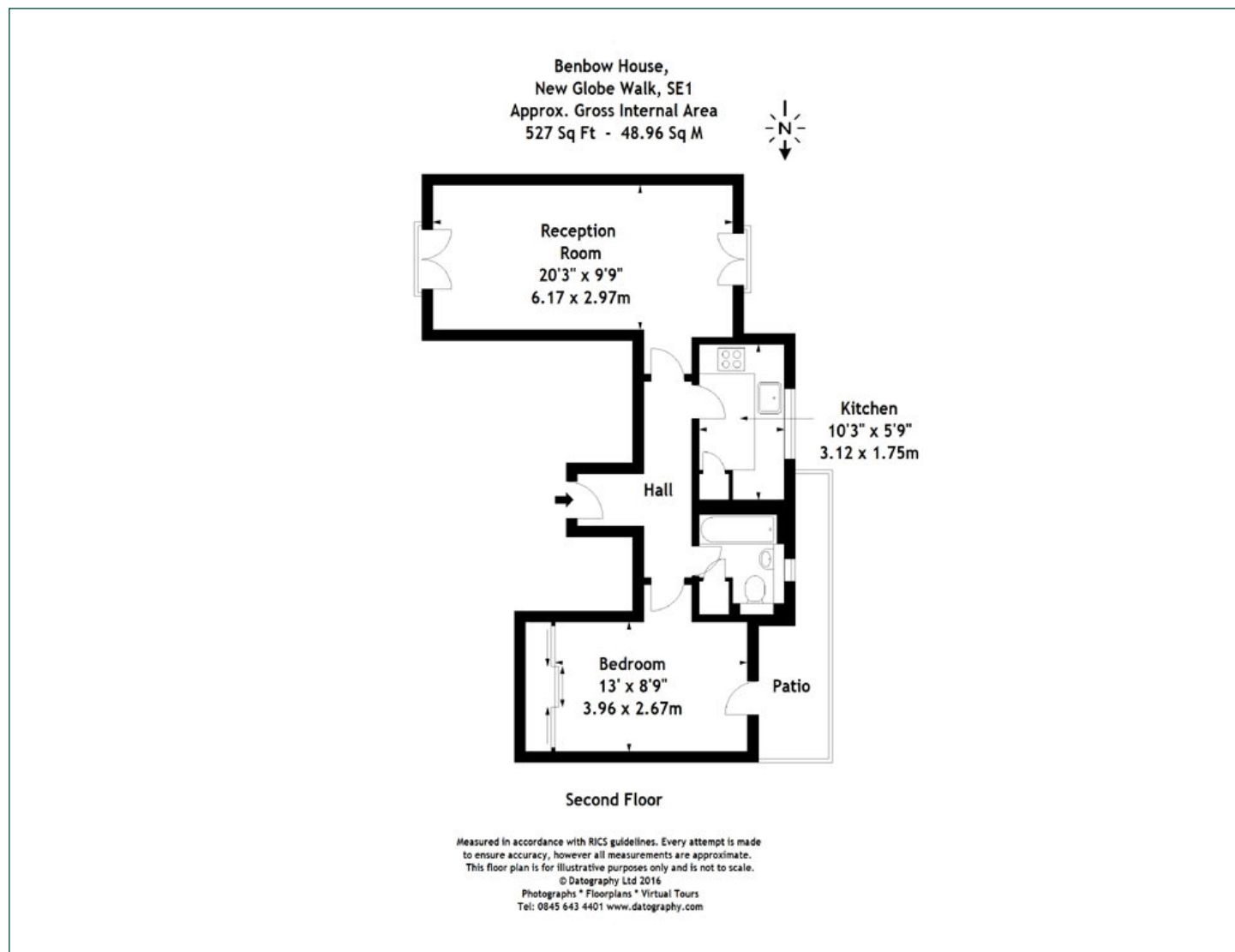

Elephant & Castle

One The Elephant, 5 St Gabriel Walk, London, SE1 6FA

Lettings

020 3869 2888 | eandc.lettings@chaseevans.co.uk

We're here to help.

IMPORTANT NOTICE - These particulars have been prepared in good faith and they are not intended to constitute part of an offer or contract. We have not performed a structural survey on this property and the services, appliances and specific fittings have not been tested. All photographs, measurements, floor plans and distances referred to are given as a guide and should not be relied upon.

chaseevans.com

 Chase Evans