

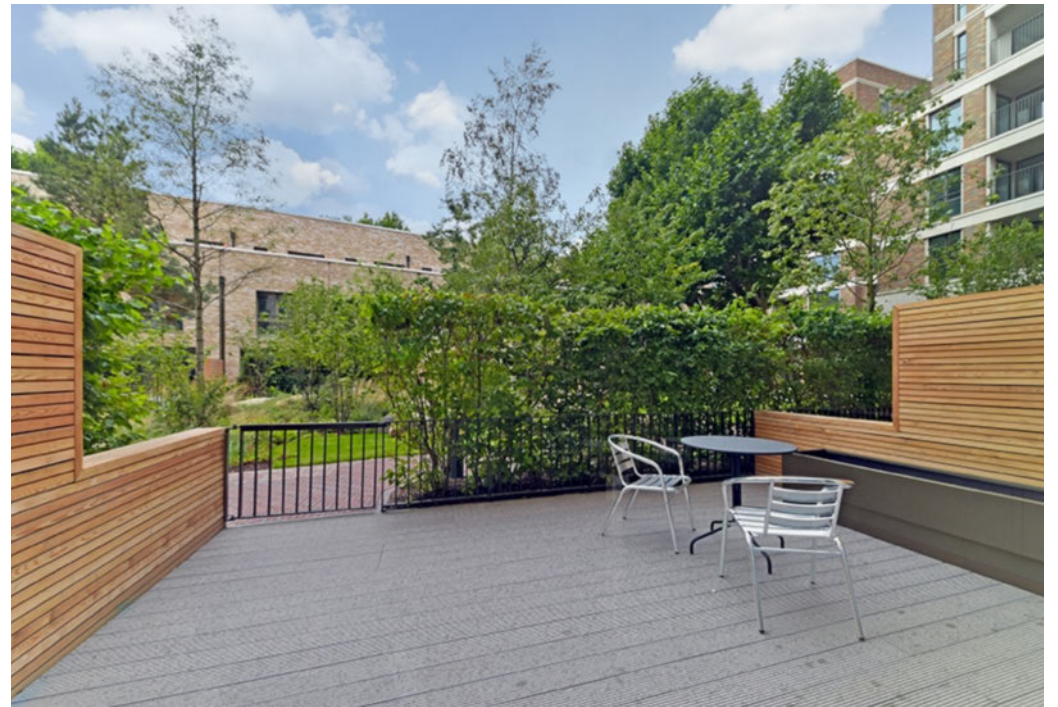

Heygate Street, Elephant & Castle, SE17

Asking price **£1,195,000** | Leasehold



Heygate Street, Elephant & Castle, SE17



3 Bedrooms



2 Bathrooms



1 Reception



Garden



Prime Location



Local Amenities



24-Hour Concierge



0.3 MI Elephant & Castle

A luxury, duplex three bed apartment forming part of the impressive 'Elephant Park' development. Features include a spacious open plan reception room with wood flooring, large stylish fitted kitchen, floor to ceiling glazing, three stunning bedrooms with fitted storage, master with ensuite and two modern bathrooms with contemporary fittings. Front garden and also large back garden.

Residents also benefit from 24-hour concierge services, access to residents' lounge, communal gardens and a roof terrace. There are several amenities located nearby including bars, cafés,

restaurants. The development is located close to Elephant & Castle National Rail and Underground stations, providing Underground and Rail are serviced by Thameslink, Southeastern, Bakerloo and Northern Line, opening up a plethora of transport links.

Tenure: Leasehold (244 years remaining)

Local Authority: Southwark Council

Ground Rent: £450 p.a.

Council Tax Band: F

Service Charge: £6,546 p.a.

EPC: B



Floorplan

1,286 sq ft | 119.4 sq m

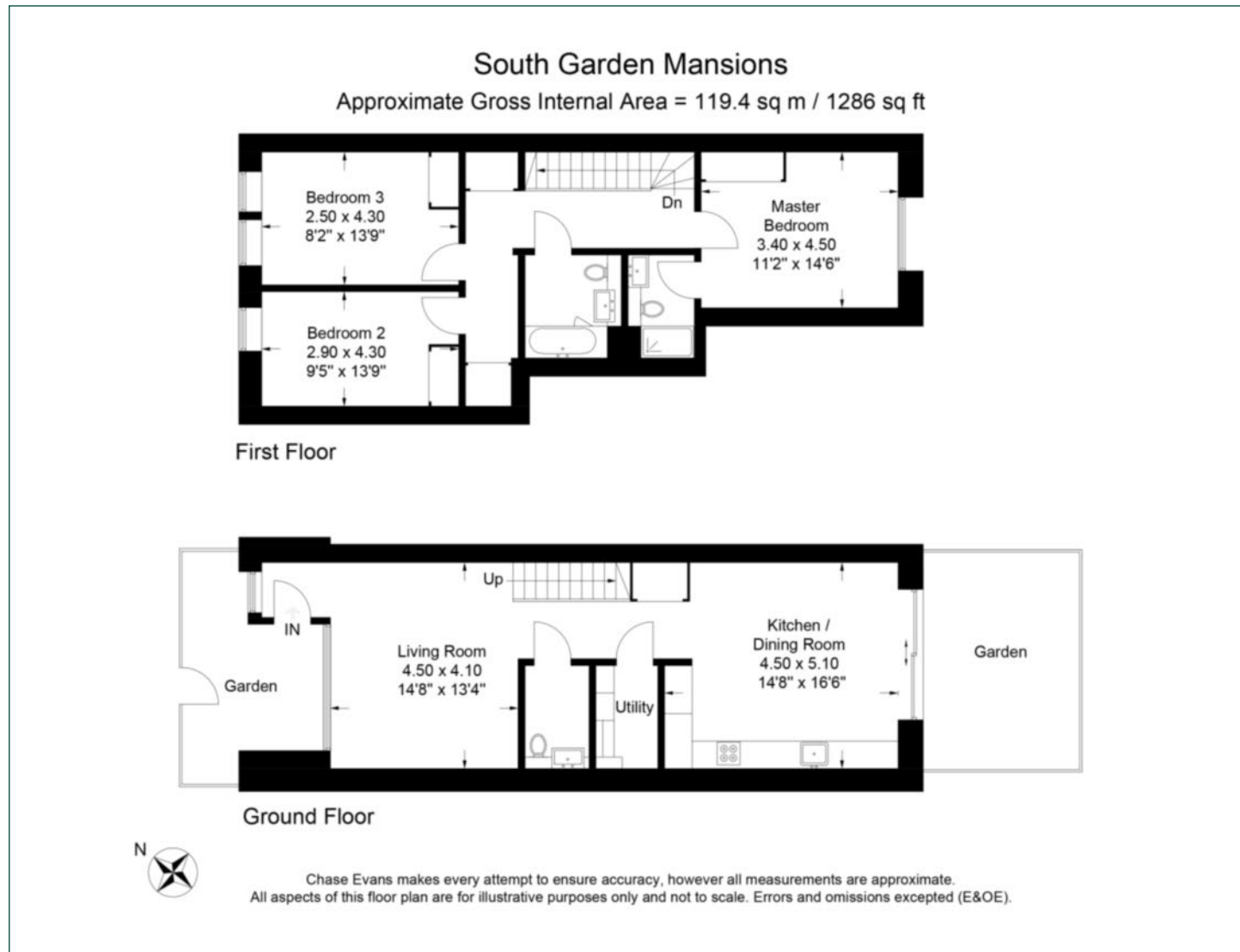

Elephant & Castle

One The Elephant, 5 St Gabriel Walk, London, SE1 6FA

Sales

020 3869 2898 | eandc.sales@chaseevans.co.uk

We're here to help.

IMPORTANT NOTICE - These particulars have been prepared in good faith and they are not intended to constitute part of an offer or contract. We have not performed a structural survey on this property and the services, appliances and specific fittings have not been tested. All photographs, measurements, floor plans and distances referred to are given as a guide and should not be relied upon.

chaseevans.com

 Chase Evans