



Palace View, Lambeth High Street, Lambeth, SE1

Price **£800 per week** | Furnished



Palace View, Lambeth High Street, Lambeth, SE1



2 Bedrooms



2 Bathrooms



1 Reception



Balcony



Gymnasium



Local Amenities



24-Hour Concierge



0.5 MI Lambeth North

Stunning two bedrooms, two bathrooms apartment with a balcony set within Palace View, an attractive contemporary development, a stroll across the bridge from Westminster SE1. This spacious property benefits from an open plan stylish kitchen with breakfast bar and a private balcony accessed from both the living room and bedroom, wood flooring, floor to ceiling glazing, good sized bedrooms, master with fitted wardrobe and en suite, and a further family bathroom suite.

Residents are able to enjoy a communal roof terrace with stunning views over the Thames to Parliament.

The development also offers residents a 24-hour concierge service, cycle storage, gymnasium and cinema.

Primely located near to the River Thames, parks, green spaces and an array of amenities such as bars, restaurants and shops. Westminster is also just a 15 minute walk away, home to iconic sights such as Big Ben, Westminster Westminster Bridge and The London Eye. The development is located a short 10 minute walk from Lambeth North Underground station, providing a valuable transport link for commutes to destinations located across the Capital.



Local Authority:

Lambeth London

Council Tax Band:

F

EPC:

B

Security deposit:

equivalent to 5 weeks' rent

Floorplan

883 sq ft | 82 sq m

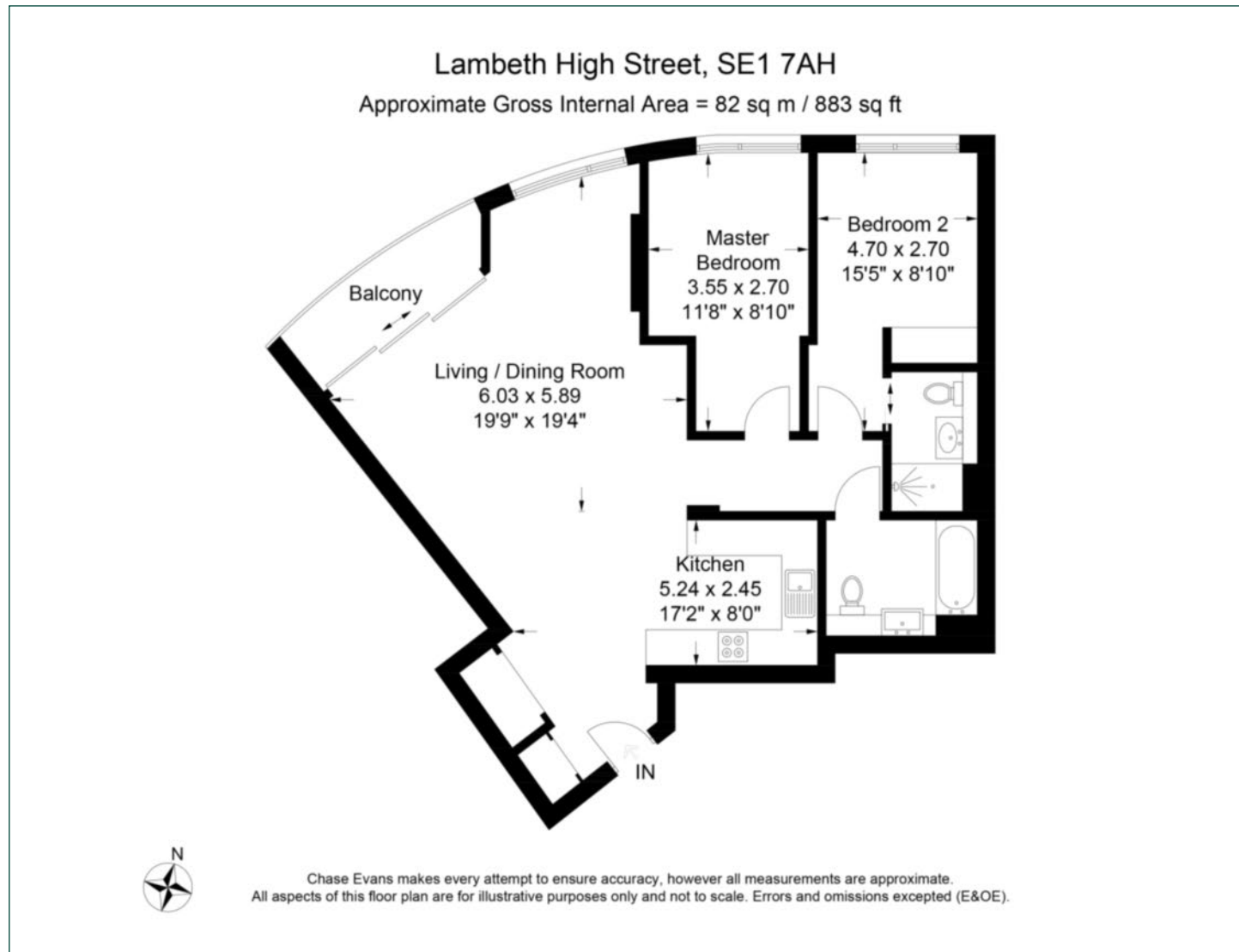

Elephant & Castle

One The Elephant, 5 St Gabriel Walk, London, SE1 6FG

Lettings

020 3869 2888 | eandc.lettings@chaseevans.com

We're here to help.

IMPORTANT NOTICE - These particulars have been prepared in good faith and they are not intended to constitute part of an offer or contract. We have not performed a structural survey on this property and the services, appliances and specific fittings have not been tested. All photographs, measurements, floor plans and distances referred to are given as a guide and should not be relied upon.

chaseevans.com

 Chase Evans