

Barlow Fold | Rawtenstall

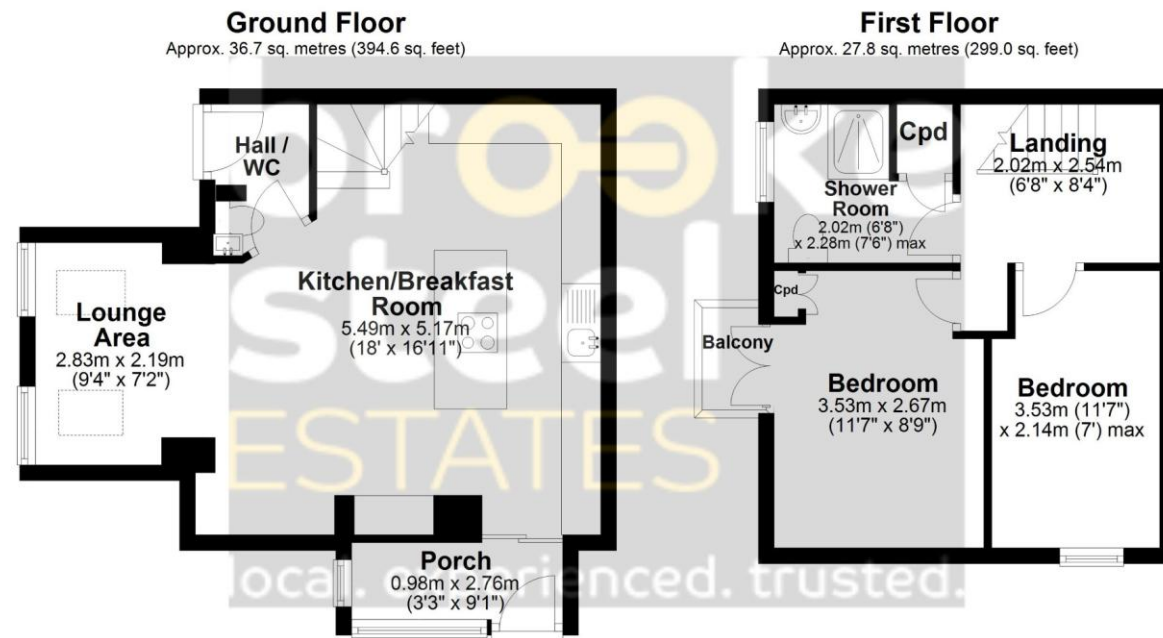

Total area: approx. 64.4 sq. metres (693.6 sq. feet)

Disclaimer: This floorplan is for illustrative purposes only. All measurements are approximate and not guaranteed to be exact or to scale. Whilst all efforts have been made to ensure its accuracy we make no guarantee, warranty or representation and any buyer should confirm measurements using their own source.

Plan produced using PlanUp.



- Back to Back Cottage
- Two Bedrooms
- Ground Floor Extension
- Shower Room
- Open Plan Modern Kitchen
- Recently Added Porch
- Gas Central Heating
- Small Balcony Overlooking Playing Field
- No Onward Chain
- Modern Throughout

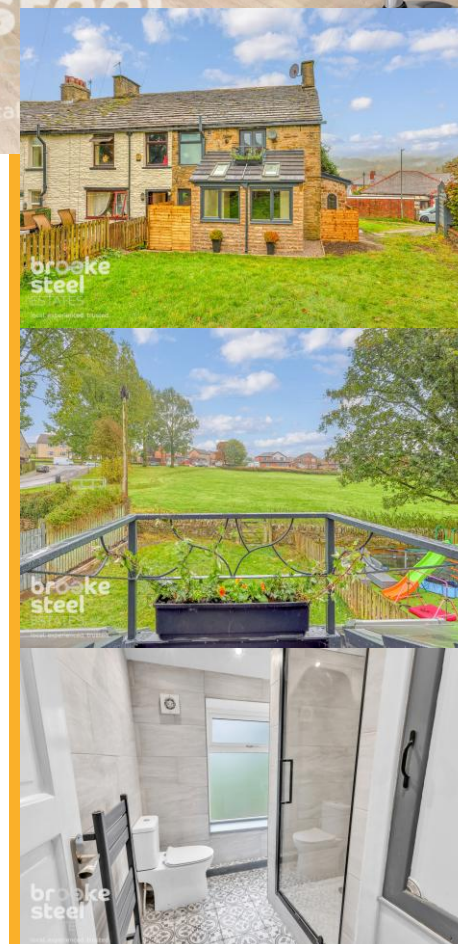

Offers Over £200,000

Back to back cottage offering modern living & traditional charm. Stone walls to the exterior, refitted kitchen, new shower room, downstairs WC, balcony, ground floor extension with views to field. Porch. Newly fitted carpets & freshly decorated throughout. Opportunity to rent parking space.



Porch

3'3" (0.99m) x 9'1" (2.77m)

Kitchen/Breakfast Room

18'0" (5.49m) x 16'11" (5.16m)

Lounge/Snug

9'4" (2.84m) x 7'2" (2.18m)

Downstairs WC/ Rear Door

First Floor

Landing

6'8" (2.03m) x 8'4" (2.54m)

Primary Bedroom

11'7" (3.53m) x 8'9" (2.67m)

Quaint Balcony

Bedroom Two

11'7" (3.53m) x 7'0" (2.13m)

Shower Room

6'8" (2.03m) x 7'6" (2.29m)

Council Tax Band A

