

GROUND FLOOR  
267 sq.ft. (24.8 sq.m.) approx.

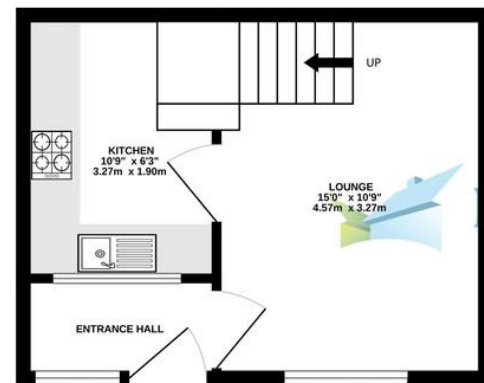

1ST FLOOR  
267 sq.ft. (24.8 sq.m.) approx.

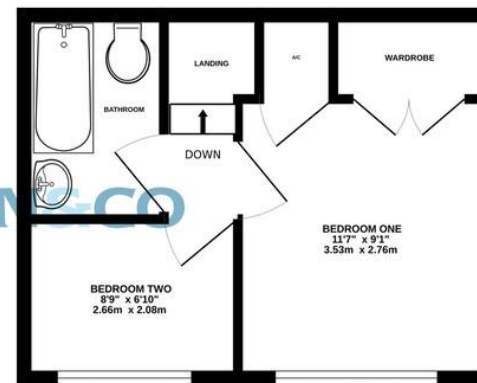

TOTAL FLOOR AREA: 534 sq.ft. (49.6 sq.m.) approx.

Whilst every attempt has been made to ensure the accuracy of the floorplan contained here, measurements of doors, windows, rooms and any other items are approximate and no responsibility is taken for any error, omission or mis-statement. This plan is for illustrative purposes only and should be used as such by any prospective purchaser. The services, systems and appliances shown have not been tested and no guarantee as to their operability or efficiency can be given.  
Made with Metropix ©2025

TO LET



**Martin & Co Basingstoke**

26 London Street • Basingstoke • RG21 7PG  
T: 01256-859960 • E: basingstoke@martinco.com

**01256-859960**

<http://www.martinco.com>



**Accuracy:** References to the Tenure of a Property are based on information supplied by the Seller. The Agent has not had sight of the title documents. A Buyer is advised to obtain verification from their Solicitor. Items shown in photographs including but not limited to carpets, fixtures and fittings are not included unless specifically mentioned within the sales particulars. They may however be available by separate negotiation. Buyers must check the availability of any property and make an appointment to view before embarking on any journey to see a property. No person in the employment of the agent has any authority to make any representation about the property, and accordingly any information given is entirely without responsibility on the part of the agents, sellers(s) or lessors(s). Any property particulars are not an offer or contract, nor form part of one. **Sonic / Laser Tape:** Measurements taken using a sonic / laser tape measure may be subject to a small margin of error. **All Measurements:** All Measurements are Approximate. **Services Not tested:** The Agent has not tested any apparatus, equipment, fixtures and fittings or services and so cannot verify that they are in working order or fit for the purpose. A Buyer is advised to obtain verification from their Solicitor or Surveyor.



**Thumwood, Chineham, RG24 8TE**

**2 Bedrooms, 1 Bathroom, Back to Back House**

**£1,200 pcm**







Thumwood, Chineham

Back to Back House,  
2 bedroom, 1 bathroom

£1,200 pcm

Date available: Now  
Deposit: £1,384  
Unfurnished  
Council Tax band: C

- Entrance Hall
- Lounge/Dining Room
- Kitchen with Appliances
- Two Bedrooms
- Modern Bathroom
- Allocated Parking
- Small Garden

A beautifully presented two bedroom back to back house, located in Chineham, close to local shops and amenities.

Comprising two bedrooms, lounge/dining room, kitchen with appliances, allocated parking and a small garden to the front of the property.

Viewing is highly recommended.

ENTRANCE HALL Front aspect window, laminate flooring and door to the lounge/dining room.

LOUNGE/DINING ROOM 14' 11" x 10' 8" (4.57m x 3.27m) Front aspect window, laminate flooring, radiator, stairs to the landing and door to the kitchen.

KITCHEN 10' 8" x 6' 2" (3.27m x 1.90m) Front aspect window, a range of eye and base level storage units with rolled edge work surfaces, integrated oven, four ring electric hob, washing machine, fridge/freezer, radiator and laminate flooring.

Score	Energy rating	Current	Potential
92+	A		
81-91	B		90 B
69-80	C	72 C	
55-68	D		
39-54	E		
21-38	F		
1-20	G		



LANDING Carpet, loft access and doors to all rooms.

BEDROOM ONE 11' 6" x 9' 0" (3.53m x 2.76m) Front aspect window, radiator, built in wardrobe with hanging space and carpet. Airing cupboard with various shelves, housing a combi boiler.

BEDROOM TWO 8' 8" x 6' 9" (2.66m x 2.08m) Single bedroom, with front aspect window, carpet and radiator.

BATHROOM Bath with shower over, low-level WC, wash hand basin and laminate flooring.

OUTSIDE To the front and side of the property, there is a small garden with garden storage shed. There is allocated parking for 1 car.

APPLICATIONS A holding deposit equivalent to 1 weeks rent will be required to reserve the property while referencing checks are being carried out. With the tenants' consent this holding deposit will be refunded against the first month's rent. The holding deposit can be retained if the applicant provides false or misleading information, fails Right to Rent checks, withdraws from the property or fails to take reasonable steps to enter into the tenancy.

In accordance with the Tenant Fees Act applicants will be required to enter into the tenancy agreement no more than 15 days after paying the holding deposit. Failure to do so for any of the afore mentioned reasons may result in you losing your holding deposit. An extension to the deadline may be entered into if agreed in writing by all parties.



Right to Rent Checks  
By law, Right to Rent checks must be carried and as such will be required to provide proof of ID and address in accordance with Home Office guidelines. More information can be found at:  
[https://assets.publishing.service.gov.uk/government/uploads/system/uploads/attachment\\_data/file/573057/6\\_1193\\_HO\\_NH\\_Right-to-Rent-Guidance.pdf](https://assets.publishing.service.gov.uk/government/uploads/system/uploads/attachment_data/file/573057/6_1193_HO_NH_Right-to-Rent-Guidance.pdf)

Reference Checks and Credit Worthiness  
All applicants will be subject to a credit check carried out by a 3rd party to check for CCJs and IVAs Applicants will need to provide proof of an income of at least 2.5 x annual rent.

We will also carry out employment checks, affordability checks, previous landlord reference and proof of address history, usually up to 3 years.

Documentation that will be required  
Passport, driving licence, utility bill dated in the last 3 months (for proof of address) and payslips.

KEY FACTS FOR RENTERS  
Council Tax Band: C  
Basingstoke and Deane  
EPC Rating: C  
UNFURNISHED  
Minimum Tenancy Term: 12 Months  
Allocated Parking for 1 Car