



Grammers Park
Launceston | Cornwall



Town • Country • Coast



Tucked away in a quiet position within a newly established development is this well presented modern 3 bedroom (1 en-suite) semi-detached home. Offering well presented accommodation throughout plus an enclosed generous rear garden and 2 off-road parking spaces at the front.

You enter the home into a hallway with a staircase to the first floor plus a ground floor WC. A doorway takes you into the dual aspect sitting room with a front aspect window enjoying a view over a green. A door opens into the rear aspect kitchen/dining room. The kitchen area has a range of modern eye and base level units plus integrated appliances. The dining area is in front of French doors out into the garden. A further door gives you access into an under-stairs cupboard.

On the first floor are 3 bedrooms and a family bathroom. The master bedroom is front aspect with a pleasant view plus space for furniture and an en-suite shower room with double shower enclosure. Bedroom 2 is a rear aspect double and finally bedroom 3 is a comfortable front aspect single. All the bedrooms share a family bathroom.

In front of the house are 2 off-road parking spaces side by side with a pathway into the rear garden. The rear garden is West facing and fully enclosed to all sides which is laid to lawn and an area of decking off the French doors alongside a patio area in the far corner. The property overlooks a green area with a natural hedgerow beyond.



Situation

Launceston is an ancient town steeped in History with the imposing Launceston Castle overlooking the town and surrounding area. Referred to as 'the gateway to Cornwall' Launceston is centred one mile (1.6 km) West of the River Tamar, which constitutes almost the entire border between the Cornish peninsula and Devon, the A30 is ideally located on the fringe of Launceston connecting to the rest of Cornwall with great access to the beautiful Coastline whilst providing great access to Plymouth and Exeter and beyond. The town itself offers a variety of individual businesses from boutiques to fine food shops, blending with occasional national outlets including Tesco, M&S Food and Costa Coffee. Local facilities include a leisure centre, medical facilities and well regarded primary and secondary schooling.

Directions

The postal code for the property is PL15 7FY. What Three Words 'kicks.unleashed.sneezing' will take you to the property. From the town centre, drive out of town on Western Road and take a right hand turning leading down to Meadowside just by 'Nicholls Flats' and follow the road down and take the left hand turning into Meadowside. Follow the road to the top of the hill. At the T junction proceed ahead into Long Meadow and turn immediately left. After a short distance turn right into Grammers Park. At the top of the road bear left where the property will be seen on your right.

www.viewproperty.org.uk

sales@viewproperty.org.uk



Town • Country • Coast

Entrance Hallway

Cloakroom

5'3" x 3'0" (1.61m x 0.92m)

Living Room

16'2" max x 11'8" (4.93m max x 3.57m)

4.93m narrowing to 3.22m

Kitchen/Diner

14'11" x 10'5" (4.57m x 3.19m)

First Floor

Bedroom 1

10'2" x 8'5" (3.11m x 2.58m)

Bedroom 2

13'9" max x 8'5" (4.21m max x 2.58m)

4.21m narrowing to 3.58m

En-suite

8'5" max to 4'5" (2.58m max to 1.35m)

2.58m narrowing to 1.32m

Bedroom 3

8'9" x 6'3" (2.67m x 1.92m)

Services

Mains Electricity, Gas, Water and Drainage

Council Tax Band C.

Agent Note

Management Charge - there will be a management charge but is yet to be taken over by First Port from Barretts.

Ground Floor



First Floor

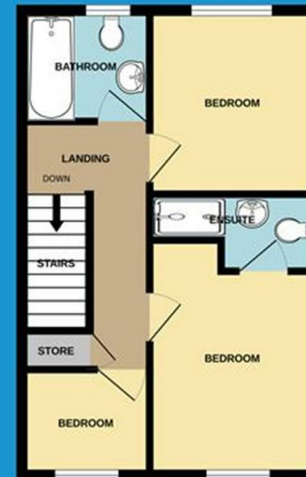

IMPORTANT: We would like to inform prospective purchasers that these sales particulars have been prepared as a general guide only. A detailed survey has not been carried out, nor the services, appliances and fittings tested. Room sizes should not be relied upon for furnishing purposes and are approximate. If floor plans are included, they are for guidance only and illustration purposes only and may not be to scale. If there are any important matters likely to affect your decision to buy, please contact us before viewing the property.

01566 706706 | sales@viewproperty.org.uk

www.viewproperty.org.uk



Town • Country • Coast