

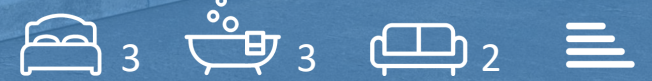

Town • Country • Coast



Fore Street, Lifton  
Price Guide £359,950





# Fore Street

## Lifton

The Roadford is a three bedroom home with a half slate frontage.

The ground floor has open plan kitchen dining and spacious lounge with both rooms boasting bifold doors opening onto the rear garden. There is also a storage cupboard and WC.

The first floor has three bedrooms with an ensuite to the principle bedroom. The second and third bedroom both have handy storage cupboards. There is also a family bathroom.

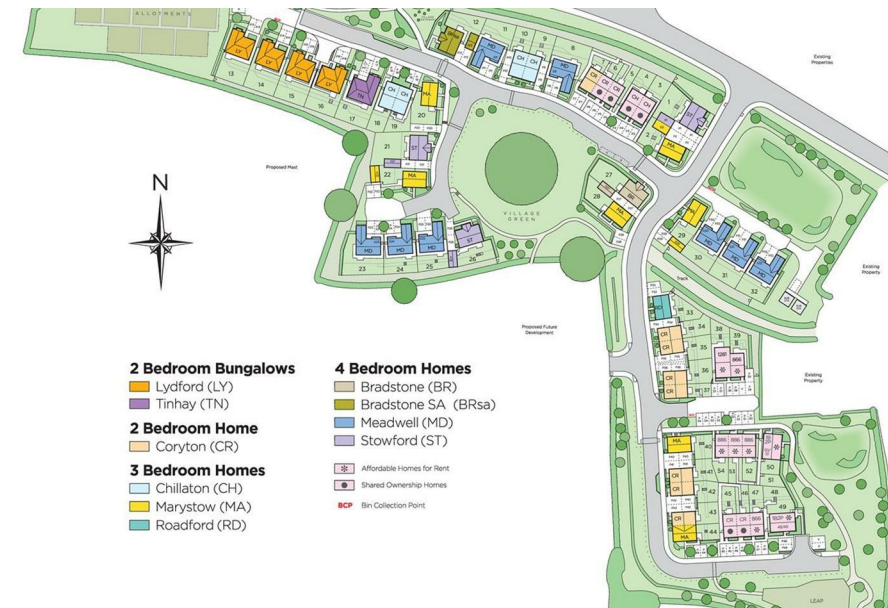

### Hallway

### Kitchen/Dining Room

18'5" x 9'6" (5.63m x 2.90m )

### Living Room

18'5" x 11'0" (5.63m x 3.36)

### Cloakroom

### First Floor

### Master Bedroom

11'5" x 9'1" (3.50m x 2.77m )

### En-Suite

### Bedroom 2

11'11" x 9'8" (3.65m x 2.95m)

### Bedroom 3

9'8" x 8'5" (2.95m x 2.59m )

### Bathroom

### Services

## Directions

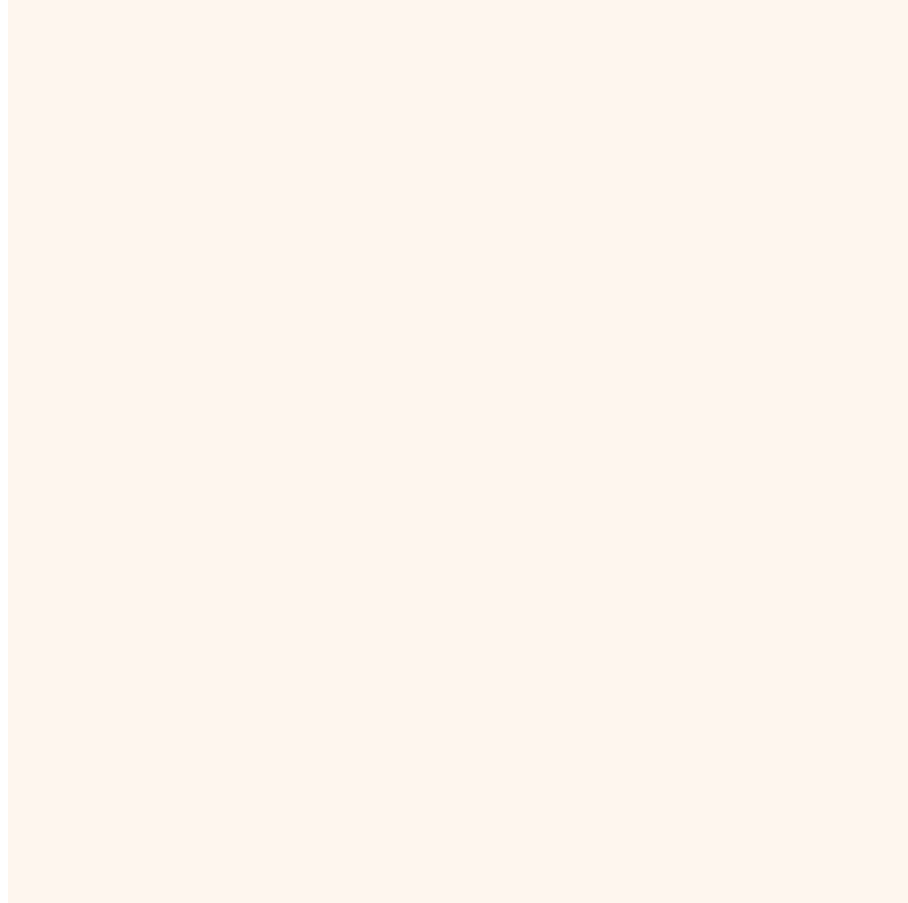



## Floor Plans

# Ground Floor

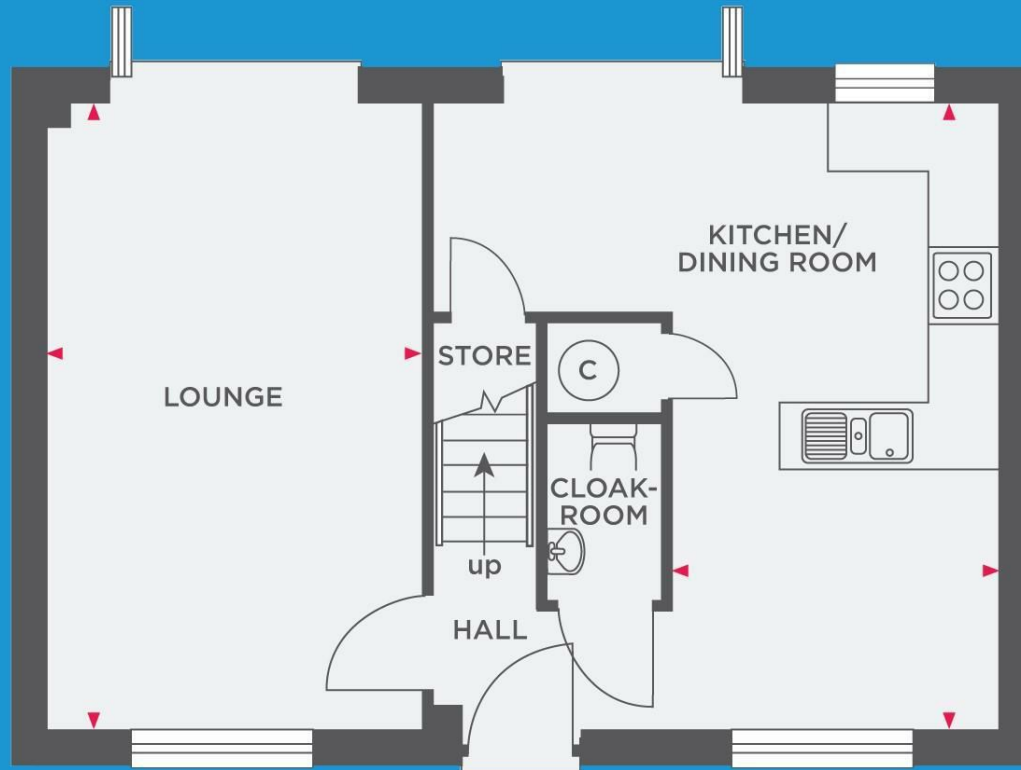

## Location Map

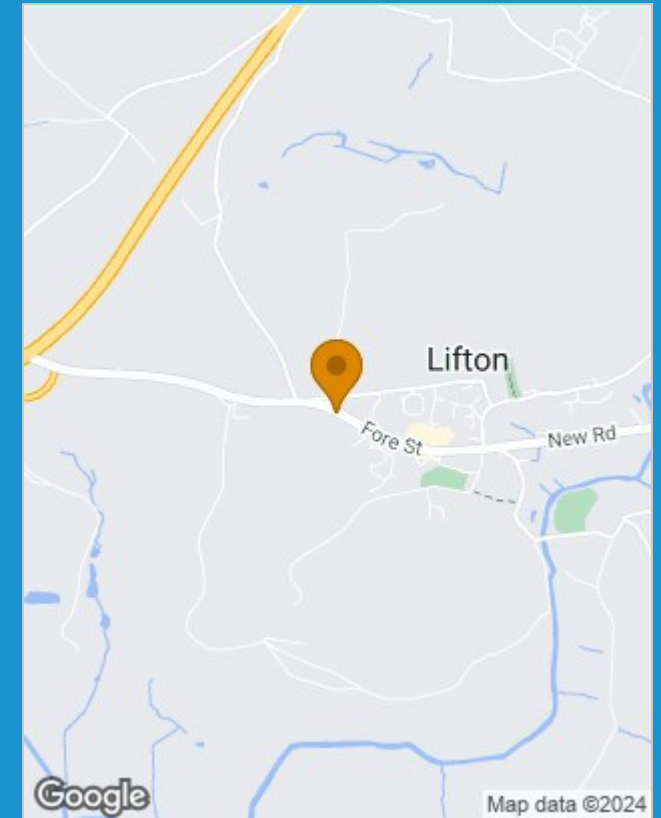

## Energy Performance Graph

Energy Efficiency Rating		Current	Potential
Very energy efficient - lower running costs			
(92 plus) A			
(81-91) B			
(69-80) C			
(55-68) D			
(39-54) E			
(21-38) F			
(1-20) G			
Not energy efficient - higher running costs			
England & Wales		EU Directive	2002/91/EC

## Viewing

Please contact our View Property Launceston Office on 01566 706706 if you wish to arrange a viewing appointment for this property or require further information.

The particulars are set out as a general outline only for the guidance of intended purchasers or lessees, and do not constitute, any part of a contract. Nothing in these particulars shall be deemed to be a statement that the property is in good structural condition or otherwise nor that any of the services, appliances, equipment or facilities are in good working order. Purchasers should satisfy themselves of this prior to purchasing.

Office 1 Unit 3 Scarne Industrial Estate, Launceston, Cornwall, PL15 9HS  
 Tel: 01566 706706 Email: sales@viewproperty.org.uk www.viewproperty.org.uk