



49-50 New Road
Chippenham, SN15 1HL

GOODMAN WARREN BECK

49-50 New Road, Chippenham, SN15 1HL

An exciting opportunity to acquire a freehold commercial property, in a prime location, which has been granted planning permission, for change of use to residential. The premises are in a prominent position in Chippenham town centre and within walking distance of the main line railway station. This ground floor shop/office comprises of an open plan reception area, spacious rear office, with a kitchenette and WC to its rear. The property also benefits from a private car park, with two large storage buildings, which have been granted planning consent to develop into, two spacious, one bedroom apartments, with parking.

PLANNING PERMISSION

Planning consent has been granted, to develop the office space, into a two bed apartment and to develop the outbuildings into two spacious, one bed apartments with parking.

Planning Application No - PL/2022/03918 -
PL/2023/03837

ACCOMMODATION

Open plan reception area
Office
Kitchenette
Cloakroom
Car park for 4/5 vehicles
Large storage building

SERVICES

Gas
Water
Electric

TERMS

Freehold

GOODMAN WARREN BECK

64 Market Place

Chippenham, Wiltshire SN15 3HG

Tel 01249 444449 | Fax 01249 448989

Email info@goodmanwb.co.uk

£249,950

ENERGY PERFORMANCE GRAPHS

Energy Efficiency Rating		Current	Potential
Very energy efficient - lower running costs			
(92 plus) A			
(81-91) B			
(69-80) C			
(55-68) D			
(39-54) E			
(21-38) F			
(1-20) G			
Not energy efficient - higher running costs			
England & Wales	EU Directive 2002/91/EC		

Council Tax Band:

Tenure: Freehold

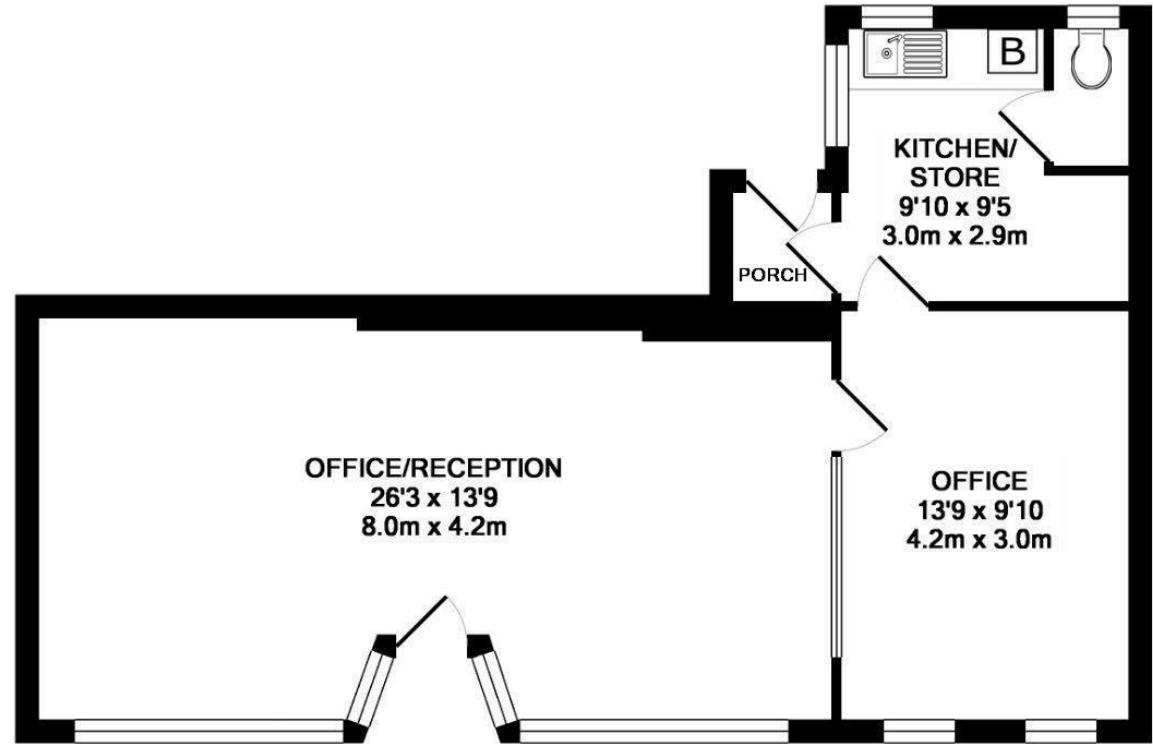

TOTAL APPROX. FLOOR AREA 579 SQ.FT. (53.8 SQ.M.)

The floor plan is provided in good faith and believed to be accurate, but location and sizes of rooms, doors and windows are provided for guidance only and as such should not be relied upon. If any aspect of the plan is important to you, please contact our office.
Made with Metropix ©2016

DISCLAIMER: These particulars, whilst believed to be accurate are set out as a general outline only for guidance and do not constitute any part of an offer or contract. Intending purchasers should not rely on them as statements of representation of fact, but must satisfy themselves by inspection or otherwise as to their accuracy. No person in this firm's employment has the authority to make or give any representation or warranty in respect to this property. We have not carried out a detailed survey not tested the services, appliances and specific fittings. All measurements and distances are approximate only. Room sizes should not be relied upon for carpets and furnishings. References to the tenure of the property are based on information supplied by the seller. The agent has not had sight of the title documents. A buyer is advised to obtain verification from their solicitor. Your home is at risk if you do not keep up repayments on a mortgage or other load secured on it. Floor plans (not to scale, for illustrative purposes only)

