

34 Elizabeth Place, Chippenham, SN15 3UP

GOODMAN WARREN BECK

64 Market Place
 Chippenham, Wiltshire SN15 3HG
 Tel 01249 444449 | Fax 01249 448989
 Email info@goodmanwb.co.uk

£136,950

A modern well presented first floor maisonette ideally situated in a cul-de-sac on the popular Pewsham development offering easy access to a wide range of amenities. The accommodation offers an entrance hall with stairs upto the first floor opening into an open plan sitting/dining room, an inner hall with doors to the kitchen with a range of fitted units and built-in oven and hob, double bedroom with built-in wardrobe and bathroom with over bath shower. Other benefits include uPVC double glazing, electric heating and an allocated parking space.

Situation

The property is situated in a quiet cul-de-sac on the Pewsham development within walking distance of the town centre and its many amenities. The development boasts local shops, a doctors surgery, junior school, public house and community centre. Chippenham mainline rail station is close by, as well as M4 J.17 c. 5 miles providing swift commuting links to Swindon, Bath and Bristol.

Accommodation Comprising:

Entrance Hall

uPVC entrance door into entrance lobby with laminate flooring. Stairs to first floor.

Sitting Room

Two uPVC double glazed windows to front. Night storage heater. Television and telephone point. Access to boarded loft space. Door to:

Inner Hall

Wood laminate flooring. Cupboard housing hot water tank and immersion heater. Doors to:

Kitchen

uPVC double glazed window to rear. Range of drawer and cupboard base units and matching wall mounted cupboards. Rolled edge work surfaces with matching upstands, tiled splash backs and inset single bowl single drainer stainless steel sink unit. Built-in electric oven and hob. Free standing under counter fridge and freezer. Space and plumbing for washing machine. Tiled floor.

Bedroom

uPVC double glazed window to rear. Built-in double wardrobe.

Bathroom

Panelled bath with mixer tap and shower attachment over. Pedestal wash basin. Close coupled WC. Tiling to principal areas. Tiled floor. Wall mounted electric fan heater. Extractor.

Outside

Parking

One allocated parking space.

Directions

From the town centre proceed up The Causeway then right at the roundabout. At the next roundabout turn left onto Pewsham Way then at the third roundabout take a left into King Henry Drive. Take the third right into Elizabeth Place where the property will be found on the right hand side.

ENERGY PERFORMANCE GRAPHS

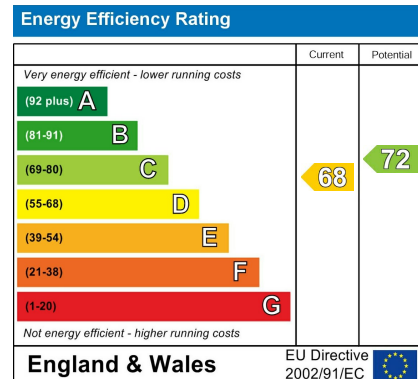

Council Tax Band: A

Tenure: Leasehold

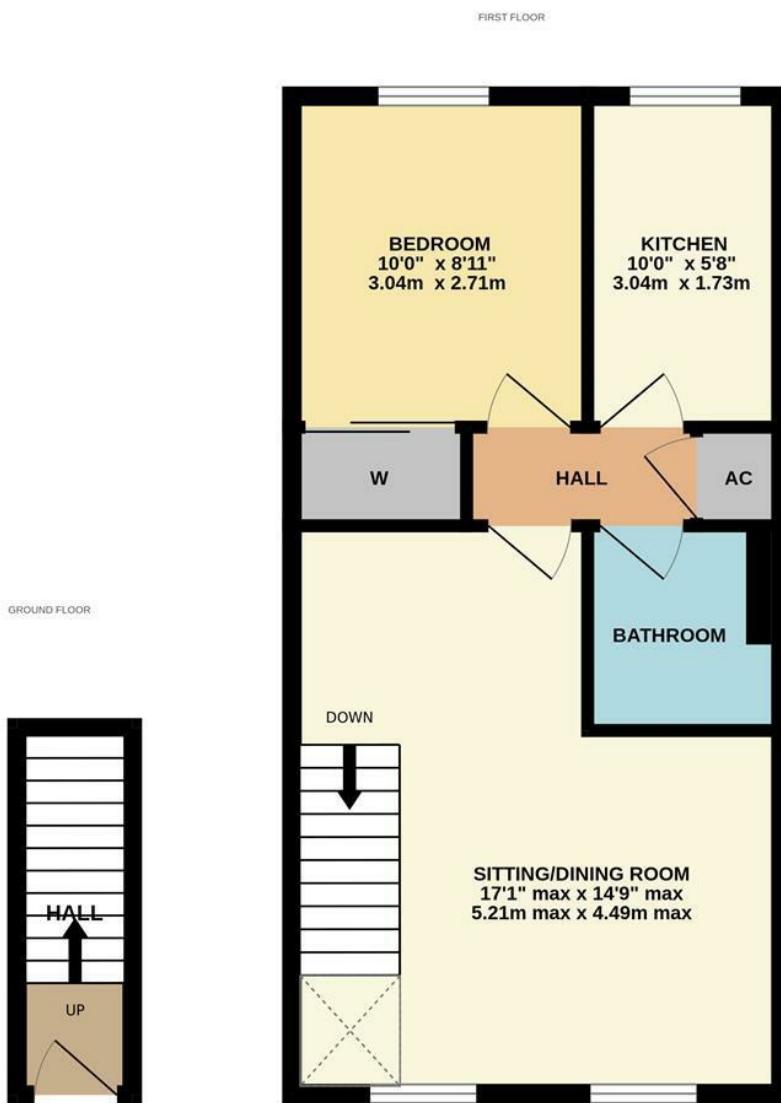

Whilst every attempt has been made to ensure the accuracy of the floorplan contained here, measurements of doors, windows, rooms and any other items are approximate and no responsibility is taken for any error, omission or mis-statement. This plan is for illustrative purposes only and should be used as such by any prospective purchaser. The services, systems and appliances shown have not been tested and no guarantee as to their operability or efficiency can be given.
 Made with Metropix ©2024

DISCLAIMER: These particulars, whilst believed to be accurate are set out as a general outline only for guidance and do not constitute any part of an offer or contract. Intending purchasers should not rely on them as statements of representation of fact, but must satisfy themselves by inspection or otherwise as to their accuracy. No person in this firm's employment has the authority to make or give any representation or warranty in respect to this property. We have not carried out a detailed survey not tested the services, appliances and specific fittings. All measurements and distances are approximate only. Room sizes should not be relied upon for carpets and furnishings. References to the tenure of the property are based on information supplied by the seller. The agent has not had sight of the title documents. A buyer is advised to obtain verification from their solicitor. Your home is at risk if you do not keep up repayments on a mortgage or other load secured on it. Floor plans (not to scale, for illustrative purposes only)