

Flat 6, Barley Court

Turk Street, Alton, Hampshire, GU34 1FP

Price £240,000

wpr



Flat 6, Barley Court

Turk Street, Alton, Hampshire GU34 1FP

Price £240,000 Leasehold

- High Street 0.25 mile
- Maltings & Sainsburys nearby
- Alton Station 0.7 mile (less on foot)
- Waterloo min. 67 minutes

A 1st floor 2 double bedroom apartment with allocated secure parking in a convenient location just South of the town centre.

- Living/dining room
- Kitchen with appliances
- Bathroom & en-suite shower room
- Reception hall with storage cupboards
- 2 double bedrooms
- Private glass balcony with elevated views
- Allocated parking & bike store
- Chain-free sale

DESCRIPTION

The property benefits from two double bedrooms with the master having an en-suite shower room and built in wardrobes. The bright and spacious living/dining room opens to a separate kitchen complete with appliances.

Further benefits include a private glass balcony, gas central heating, two generous storage cupboards and lift access to all floors.



LOCATION

Barley Court is handily placed for not only the town centre but also the station via shortcut footpaths. Nearby Windmill Hill has country walks leading to the South Downs National Park with Worldham golf course lying just to the South of Alton. The individual and multiple High Street shops are complemented by Waitrose, M&S, Sainsbury's, Aldi and Lidl stores with the town retaining weekly and specialist open air market events, historic celebrations such as the annual Victorian Cricket Match and a museum, library and gallery. There are primary schools, two senior schools, Alton School (ex-Convent) and Alton College for further education. Churches, fitness and dance studios, bars and restaurants and a sports centre further complement the town's facilities.

DIRECTIONS

From the M&S store at the western end of High Street, Alton, proceed along Drayman's Way, the town's inner relief road travelling ahead at the Sainsbury's mini-roundabout. At the following mini-roundabout, turn right into Lower Turk Street and then immediately right again onto Turk Street where Barley Court is on the right.

COUNCIL TAX

Band B - East Hampshire District Council

SERVICES

All mains services

NB

Please contact us for service charge details.



78 High Street, Alton, Hampshire, GU34 1EN
t: 01420 87379 e: alton@wpr.co.uk

VIEWING

Strictly by prior appointment with Warren Powell-Richards



Approximate Area = 661 sq ft / 61 sq m

For identification only - Not to scale

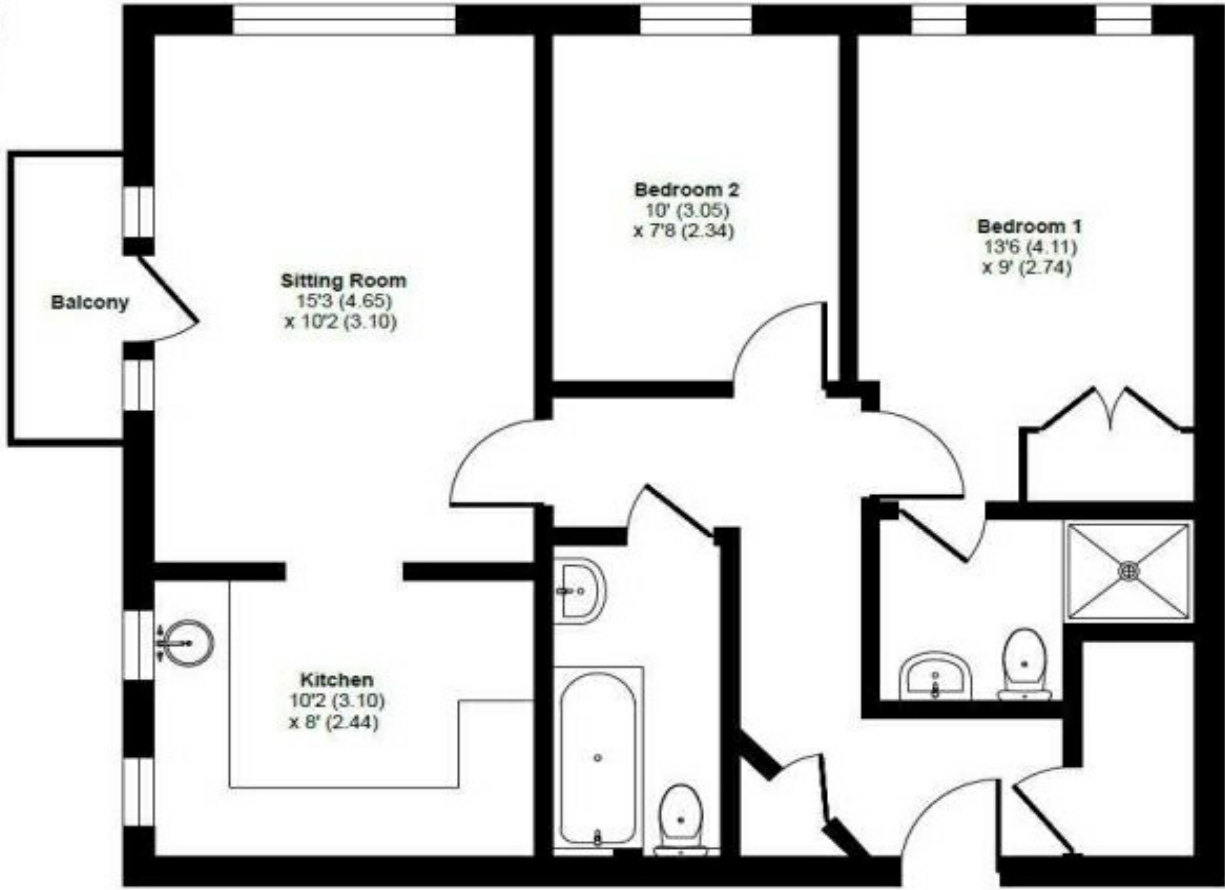

FIRST FLOOR

Energy Efficiency Rating		Current	Potential
Very energy efficient - lower running costs	A (92+)		
B (81-91)		81	81
C (69-80)			
D (55-68)			
E (39-54)			
F (21-38)			
Not energy efficient - higher running costs	G (1-20)		

England & Wales EU Directive 2002/91/EC

www.epcau.com

Office Locations: Alton • Farnham • Godalming • Grayshott • Haslemere • London

Property details are a general outline and do not constitute any part of an offer or contract. Services, equipment, fittings or central heating systems have not been tested and no warranty is given or implied that these are in working order. Buyers are advised to obtain verification from their solicitor or surveyor. Fittings and fixtures are not included unless specifically described. Measurements, distances and areas are approximate and for guidance only. This material is protected by laws of copyright.