



**Norbury Avenue, Watford WD24 4PJ**



Only 0.6 miles to Watford Junction this fantastic four bedroom town house is the perfect family home and is ideal for commuters. This delightful home is presented to the market in good condition and offers excellent living accommodation throughout. Upon entrance you will find a porch, single garage, downstairs WC and a modern kitchen / diner that provides access to the private rear garden. The first floor consists of a bright and spacious lounge and a large double bedroom with an en suite. Located on the top floor is three good sized bedrooms of which the main master bedroom has its own en suite and there is also a family size bathroom. Further benefits include off street parking, double glazing, gas central heating and a south facing garden. Location is perfect with stations nearby. Local shops, schools, bus stops and all other amenities close by. Major road links such as the M1, M25 and A41 all within easy access from the property. To avoid missing out call us today to arrange your viewing appointment.



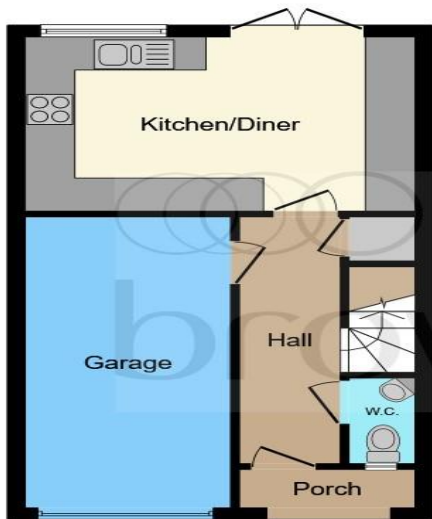

**Ground Floor**

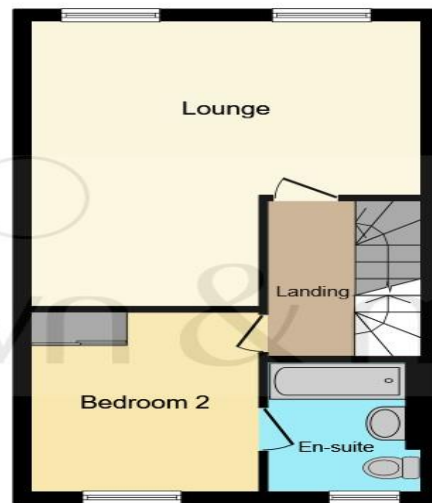

**First Floor**

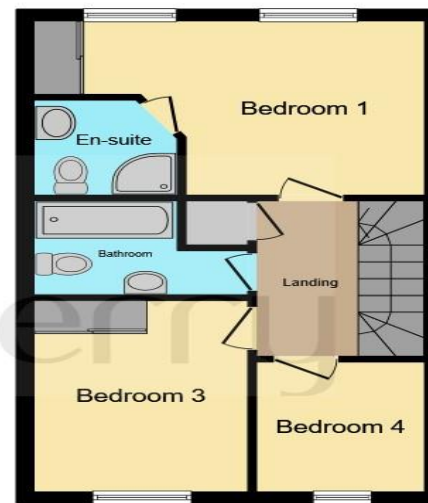

**Second Floor**

**Entrance**

**Downstairs Wc**

4' 10" x 2' 11" ( 1.47m x 0.89m )

**Garage**

17' 1" x 8' 1" ( 5.21m x 2.46m )

**Kitchen**

15' 5" x 10' 2" ( 4.70m x 3.10m )

**Lounge**

16' 11" to max x 15' 5" to max ( 5.16m to max x 4.70m to max )

**Bedroom One**

10' 7" x 9' ( 3.23m x 2.74m )

**En Suite**

7' 5" x 6' 2" ( 2.26m x 1.88m )

**Bedroom Two**

7' 6" x 6' 7" ( 2.29m x 2.01m )

**Bedroom Three**

13' 3" x 10' 3" ( 4.04m x 3.12m )

**En Suite**

5' 7" x 5' 7" ( 1.70m x 1.70m )

**Bedroom Four**

11' 2" x 8' 7" ( 3.40m x 2.62m )

**Bathroom**

8' 3" x 5' 7" ( 2.51m x 1.70m )

**Rear Garden**

This plan is for illustration purposes only and may not be representative of the property. Plan not to scale.

Powered by [audioagent.com](http://audioagent.com)

welcome to

## Norbury Avenue, Watford

- Four Bedroom Town House
- Family Bathroom, 2 En Suites, Downstairs WC
- Single Garage
- Private Rear Garden
- Excellent Living Accommodation Throughout

Tenure: Freehold EPC Rating: Awaiting

Offers In Excess Of:

**£520,000**

*"...Located on Norbury Avenue is this beautiful four bedroom town house that is offered to the market CHAIN FREE. Don't miss out and call us today to book your viewing..."*



Please note the marker reflects the postcode not the actual property

check out more properties at [brownandmerry.co.uk](http://brownandmerry.co.uk)



Property Ref:  
WAF103762 - 0004

1. MONEY LAUNDERING REGULATIONS Intending purchasers will be asked to produce identification documentation at a later stage and we would ask for your co-operation in order that there is no delay in agreeing the sale. 2. These particulars do not constitute part or all of an offer or contract. 3. The measurements indicated are supplied for guidance only and as such must be considered incorrect. Potential buyers are advised to recheck measurements before committing to any expense. 4. We have not tested any apparatus, equipment, fixtures or services and it is in the buyers interest to check the working condition of any appliances. 5. Where an EPC, or a Home Report (Scotland only) is held for this property, it is available for inspection at the branch by appointment. If you require a printed version of a Home Report, you will need to pay a reasonable production charge reflecting printing and other costs. 6. We are not able to offer an opinion either written or verbal on the content of these reports and this must be obtained from your legal representative. 7. Whilst we take care in preparing these reports, a buyer should ensure that his/her legal representative confirms as soon as possible all matters relating to title including the extent and boundaries of the property and other important matters before exchange of contracts.



**01923 248861**



[watford@brownandmerry.co.uk](mailto:watford@brownandmerry.co.uk)



104 The Parade, WATFORD, Hertfordshire,  
WD17 1AW



**[brownandmerry.co.uk](http://brownandmerry.co.uk)**