



**Caractacus Cottage View, Watford, WD18 6JW**

**welcome to**

**Caractacus Cottage View, Watford**

This delightful property located at Caractacus Cottage View is the perfect first time purchase / investment. Don't miss out on this lovely one bedroom apartment, Call us today to organise your viewing.



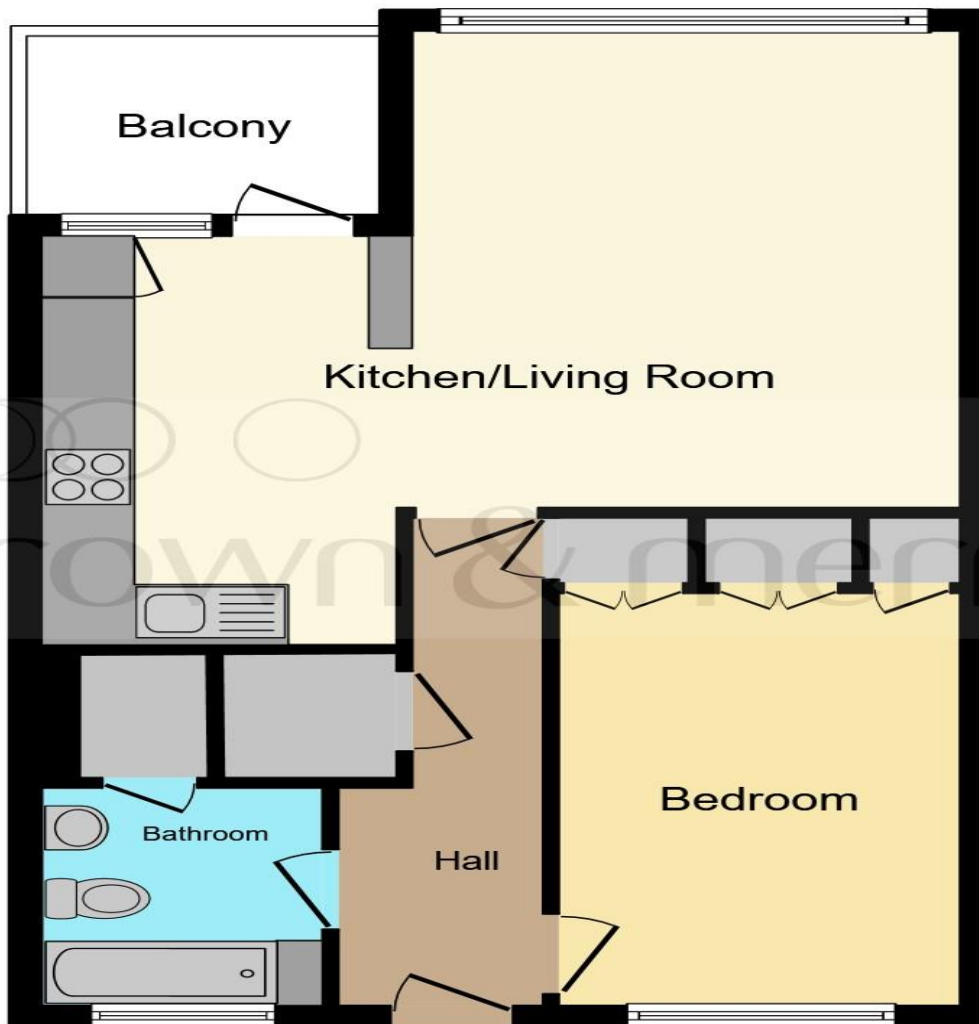

**Entrance**

**Kitchen / Living Room**

15' 7" x 11' 8" ( 4.75m x 3.56m )

**Bedroom One**

13' 11" x 8' 8" ( 4.24m x 2.64m )

**Bathroom**

6' 7" x 6' ( 2.01m x 1.83m )

**Balcony**

This plan is for illustration purposes only and may not be representative of the property. Plan not to scale.

Powered by [audioagent.com](http://audioagent.com)

welcome to

## Caractacus Cottage View, Watford

- One Bedroom Apartment
- Second Floor
- Excellent Living Accommodation Throughout
- Parking
- Balcony

Tenure: Leasehold EPC Rating: C

This is a Leasehold property with details as follows; Term of Lease 125 years from 01 Nov 1993. Should you require further information please contact the branch. Please Note additional fees could be incurred for items such as Leasehold packs.

Guide price

**£200,000 – £220,000**



Please note the marker reflects the postcode not the actual property

**view this property online** [browandmerry.co.uk/Property/WAF103646](https://www.browandmerry.co.uk/Property/WAF103646)



Property Ref:  
WAF103646 - 0004

1. MONEY LAUNDERING REGULATIONS Intending purchasers will be asked to produce identification documentation at a later stage and we would ask for your co-operation in order that there is no delay in agreeing the sale. 2. These particulars do not constitute part or all of an offer or contract. 3. The measurements indicated are supplied for guidance only and as such must be considered incorrect. Potential buyers are advised to recheck measurements before committing to any expense. 4. We have not tested any apparatus, equipment, fixtures or services and it is in the buyers interest to check the working condition of any appliances. 5. Where an EPC, or a Home Report (Scotland only) is held for this property, it is available for inspection at the branch by appointment. If you require a printed version of a Home Report, you will need to pay a reasonable production charge reflecting printing and other costs. 6. We are not able to offer an opinion either written or verbal on the content of these reports and this must be obtained from your legal representative. 7. Whilst we take care in preparing these reports, a buyer should ensure that his/her legal representative confirms as soon as possible all matters relating to title including the extent and boundaries of the property and other important matters before exchange of contracts.

Brown & Merry is a trading name of Sequence (UK) Limited which is registered in England and Wales under company number 4268443, Registered Office is Cumbria House, 16-20 Hockliffe Street, Leighton Buzzard, Bedfordshire, LU7 1GN. VAT Registration Number is 500 2481 05.

  
brown & merry



**01923 248861**



watford@brownandmerry.co.uk



104 The Parade, WATFORD, Hertfordshire,  
WD17 1AW



**[brownandmerry.co.uk](https://www.browandmerry.co.uk)**