



Connells

Napleton Road  
Faversham





This deceptively spacious, end of terrace, Victorian house is situated just a short walk from the town centre and in the conservation area of Faversham. Conveniently located, this property is moments' walk away from the centre of Faversham's market town and main line train station with regular high speed services to London.

The property offers a large bay fronted lounge with decorative fire place, opening to a separate dining room and two fantastic cellar rooms that offer plenty of potential for two further reception rooms. They could also work as a study area, children play area or cinema room.

There is galley style kitchen with a range of modern units and space for appliances. Situated off the kitchen is a utility area with plumbing for washing machine and rear access to the garden. The rear garden provides a lovely outside space with flower beds and lawn, it is part-walled with side access to the front of the property via a really useful covered alley.



Upstairs the property has a well presented and very spacious bathroom, a good sized double bedroom with access to a single bedroom and an additional third double bedroom to the front of the property. This really is a charming Victorian style terrace that must be viewed to appreciate the versatility and space of the accommodation on offer.

## ACCOMMODATION

### Entrance Porch

Door to front, access to lounge

### Lounge

14' 6" x 11' 4" ( 4.42m x 3.45m )

Exposed floorboards, feature fireplace, large bay window

### Dining Room

13' 6" x 14' 5" ( 4.11m x 4.39m )

Exposed floorboards, access to cellar and kitchen

### Kitchen

11' 2" x 6' 11" ( 3.40m x 2.11m )

Modern fitted kitchen with matching wall and base units, space and plumbing for appliances. Access to rear porch.

### Utility

Space and plumbing for washing machine.

### Cellar One

14' 7" x 10' 2" ( 4.45m x 3.10m )

### Cellar Two

15' 4" x 13' 9" ( 4.67m x 4.19m )

### Bedroom One

11' 8" x 10' ( 3.56m x 3.05m )

Access to dressing room / possible third bedroom, window

### Bedroom Three

12' 1" x 7' 8" ( 3.68m x 2.34m )

Currently used as dressing room, potential third bedroom, window

### Bedroom Two

13' 8" x 11' 4" ( 4.17m x 3.45m )

Double bedroom, window

### Bathroom

Bath, shower, WC, wash hand basin, partly tiled

### Outside

Garden space with lawn, flower beds, walled surrounds and gated side access via alley way to front.













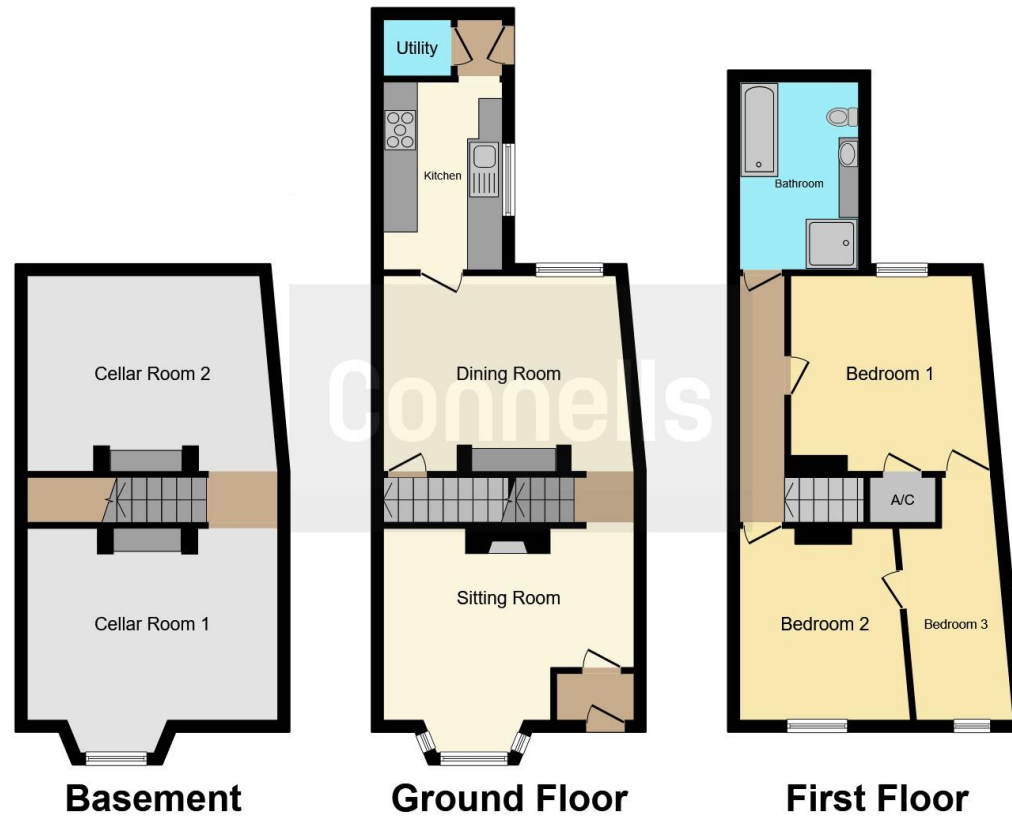

This floorplan is for illustrative purposes only and is not drawn to scale. Measurements, floor-areas, openings and orientations are approximate. They should not be relied upon for any purpose and do not form any part of an agreement. No liability is taken for any error or mis-statement. All parties must rely on their own inspections.

To view this property please contact Connells on

**T 01795 533544**  
**E faversham@connells.co.uk**

7 Market Place  
 FAVERSHAM ME13 7AG

**EPC Rating: E**

Tenure: Freehold

**view this property online [connells.co.uk/Property/FAV102581](http://connells.co.uk/Property/FAV102581)**



1. MONEY LAUNDERING REGULATIONS Intending purchasers will be asked to produce identification documentation at a later stage and we would ask for your co-operation in order that there will be no delay in agreeing the sale. 2. These particulars do not constitute part or all of an offer or contract. 3. The measurements indicated are supplied for guidance only and as such must be considered incorrect. Potential buyers are advised to recheck measurements before committing to any expense. 4. We have not tested any apparatus, equipment, fixtures, fittings or services and it is in the buyers interest to check the working condition of any appliances.

Connells Residential is registered in England and Wales under company number 1489613, Registered Office is Cumbria House, 16-20 Hockliffe Street, Leighton Buzzard, Bedfordshire, LU7 1GN. VAT Registration Number is 500 2481 05.

**See all our properties at [www.connells.co.uk](http://www.connells.co.uk) | [www.rightmove.co.uk](http://www.rightmove.co.uk) | [www.zoopla.co.uk](http://www.zoopla.co.uk)**

Property Ref: FAV102581 - 0006