

 3  2  1



Lynwood Crescent, *Sunningdale*

OSBORNE HEATH

A three bedroom home in a quiet cul-de-sac, with a large rear garden and no onward chain.

On the ground floor there is a living room, dining room, kitchen, pantry and a downstairs WC.

The first floor is the principal bedroom, two further bedrooms, modern shower room and a WC.

Outside the property has a front garden and side access to a large rear garden.

Lynwood Crescent is a small cul-de-sac in Sunningdale, close to Charters School, Holy Trinity Primary School and The Marist. The closest station is Sunningdale where trains run to London and Reading. Nearby points of interest include Ascot Racecourse, Coworth Park, Legoland, The Lexicon, Sunningdale Golf Club, Virginia Water Lake, Wentworth Club and Windsor Great Park. Sunningdale is also convenient for the M3, M4, M25 and Heathrow Airport.

EPC rating C. Council Tax band D.





APPROXIMATE FLOOR AREA
House - 97.10 sq m - 1045 sq ft
(Gross Internal Area)

O
H

NOT TO SCALE
This plan is for illustration purposes only

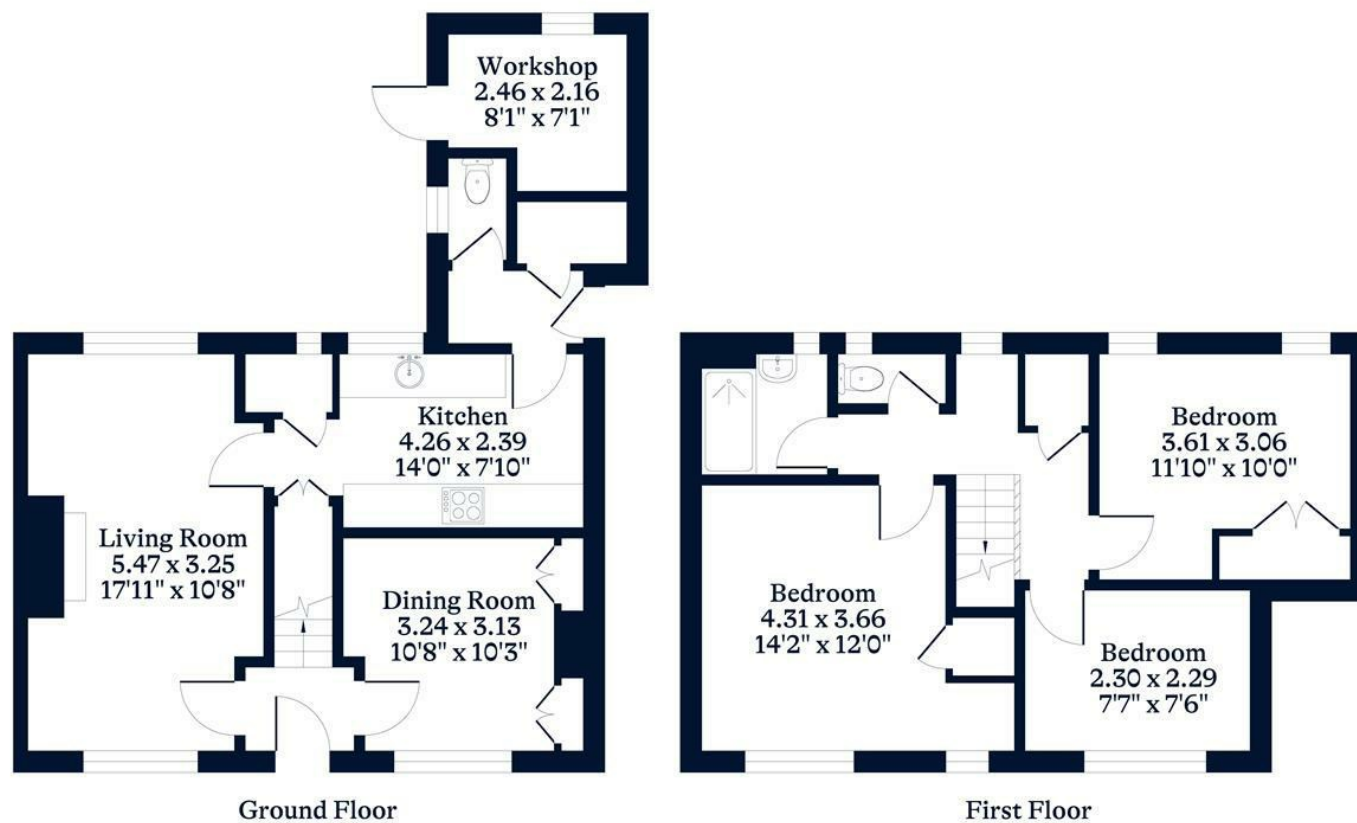

This plan is for layout guidance only. Not drawn to scale unless stated. Windows and door openings are approximate. Whilst every care is taken in the preparation of this plan, please check all dimensions, shapes and compass bearings before making any decisions reliant upon them.

OSBORNEHEATH.CO.UK