

🛏️ 2 🛋️ 2 🛁 2

O
|
H



North Road, *Ascot*

OSBORNE HEATH

A modernised two bedroom, two bathroom detached house with driveway parking and a south facing garden.

Downstairs there is an open-plan living, dining and kitchen area which leads out to the garden, storage and a downstairs WC.

Upstairs is the principal bedroom with built-in wardrobes and en suite shower room, second bedroom and a bathroom.

Outside is the driveway and side access leading to the newly landscaped south facing garden. The current owners have also added a summer house with power which is a great office or studio.

North Road is a small residential road in the village of Chavey Down, Ascot. Nearby are a number of popular schools including Ascot Heath Infant and Junior School, Charters, Ranelagh and St Joseph's. The nearest train stations are Ascot and Martins Heron where services run to London, Reading and Guildford. By road Ascot is convenient for the M3, M4, M25 and Heathrow Airport. Nearby points of interest include Ascot Racecourse, Coworth Park, Legoland, The Lexicon, Swinley Forest, Wentworth Club, Windsor Castle and Windsor Great Park.

EPC rating C. Council Tax band E.







APPROXIMATE FLOOR AREA
House - 64.80 sq m - 698 sq ft
Outbuilding - 10.12 sq m - 109 sq ft
Total - 74.92 sq m - 807 sq ft
(Gross Internal Area)

NOT TO SCALE
This plan is for illustration purposes only

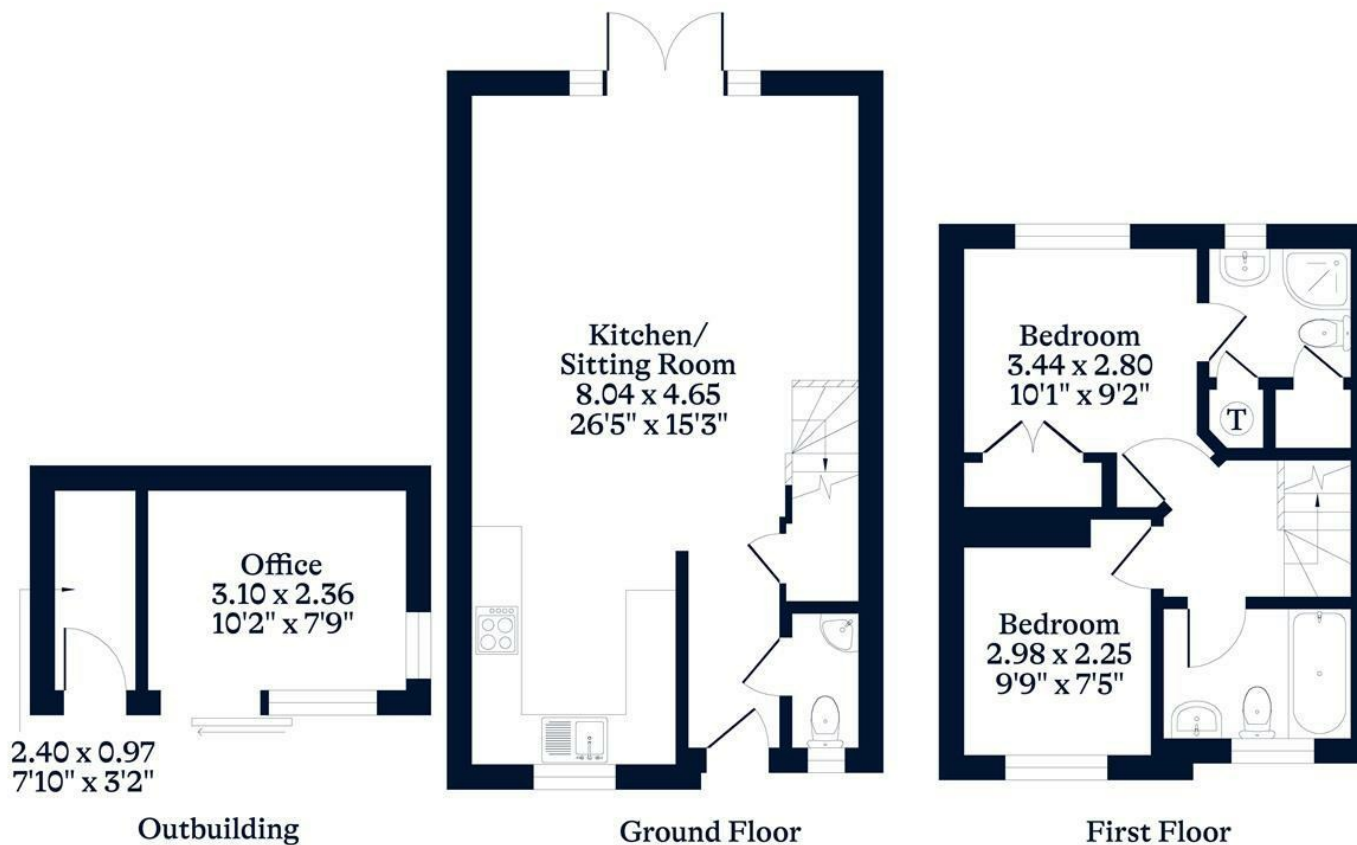

This plan is for layout guidance only. Not drawn to scale unless stated. Windows and door openings are approximate. Whilst every care is taken in the preparation of this plan, please check all dimensions, shapes and compass bearings before making any decisions reliant upon them.

OSBORNEHEATH.CO.UK