

44 Cathedral Green Court

Peterborough, PE1 4YS



Retirement
SECURITY



A second floor, two bedroom retirement apartment comprising entrance hall with storage, open plan living room/ kitchen, kitchen includes integrated oven and hob, living room with feature fireplace, master bedroom with built-in wardrobes, bathroom with level access walk-in shower, plus a second bedroom.

24hr Staff / Gated Parking / Guest Suite / Lift Access / Landscape Garden

£70,000

Leasehold - charges apply



Setting Standards for
Retirement Communities

resales@retirementsecurity.co.uk 0800 389 9384

Cathedral Green Court, Peterborough

SECOND FLOOR
615 sq.ft. (57.2 sq.m.) approx.

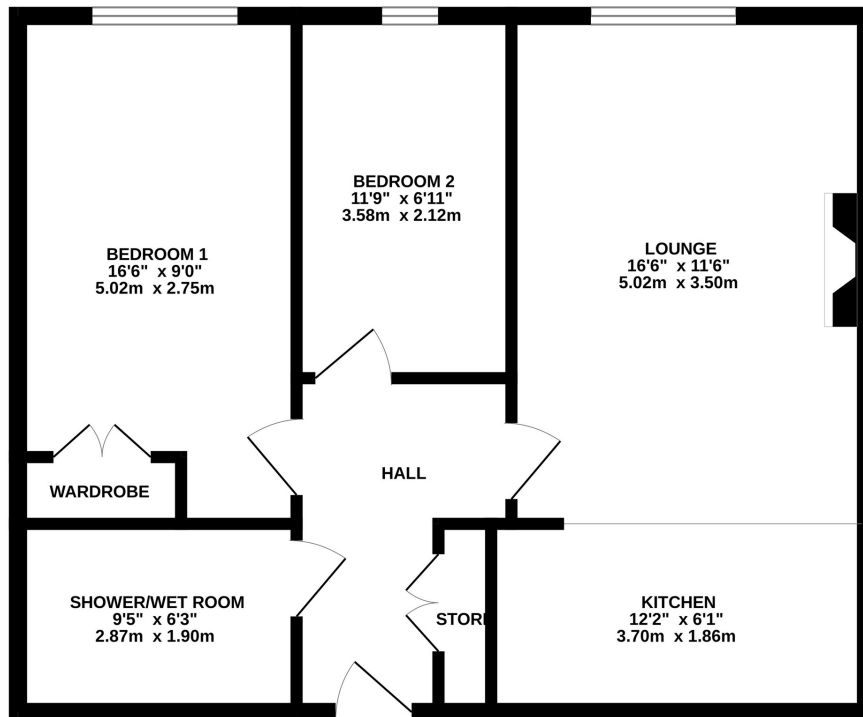

RETIREMENT APARTMENT 44 CATHEDRAL GREEN COURT
TOTAL FLOOR AREA : 615 sq.ft. (57.2 sq.m.) approx.
Made with Metropix ©2023

Key Facts

Lease:	125 years from 1st April 2000 (approx. 102 years remaining)
Service Charge:	£728.34 pcm (£167.16 pw) (reviewed annually, updated from 1st April)
Ground Rent:	None
Council Tax band:	C
Transfer Premium:	3% on sale
Age Criteria:	55+ years

Energy rating:

	Current	Potential
Very energy efficient - lower running costs		
(92+) A		
(81-91) B		
(69-80) C	76	78
(55-68) D		
(39-54) E		
(21-38) F		
(1-20) G		
Not energy efficient - higher running costs		

Cathedral Green Court

Cathedral Green Court is run by owners, for owners and comprises forty-three spacious one and two bedroom apartments. Amenities include owners' lounge, on-site dining, guest suite, landscaped gardens and owners' parking. The Court, with 24 hour on-site staff, offers owners the opportunity of retaining independence within an active social community. Located in the Cathedral City of Peterborough, The Court is less than a mile to the centre with bus stops approximately 5 minutes away.

These particulars do not form part of any offer or contract. Any areas, measurements or distances are approximate. The text, photographs and plans are for guidance only and are not necessarily comprehensive. Virtually furnished images may be used for marketing purposes. We have not tested any services, equipment or facilities.

resales@retirementsecurity.co.uk

0800 389 9384