



## Fair View, offers in excess of £210,000

- NO ONWARD CHAIN!
- GARAGE with rear lane access.
- ALL appliances, LOG BURNER & HOT TUB INCLUDED
- Council Tax Band - C
- Great road links to M4 and A470
- Close to local schools
- EPC Rating: C



 3  1  1



## About the property

Perfect for First Time Buyers & small families is this great-sized three bedroom semi-detached home in Beddau. Offered with NO ONWARD CHAIN and move-in ready, the property also benefits from a garage with rear access, front & rear gardens and all kitchen appliances, LOG BURNER and HOT TUB INCLUDED!

## Accommodation

### Entrance Hallway

Enter via front door to hallway. Access to lounge and Kitchen. Stairs leading to first floor and built in storage.

### Living/dining Room

Great size family room with uPVC window to front. French doors to rear leading to rear garden.

### Kitchen

Fitted with a range of wall and base units with work top over. Stainless steel sink and mixer tap, space for cooker with cooker hood over and integrated with two freezers, fridge and washing machine. UPVC Double glazed window to side and door to rear giving further access to the rear garden.

### Landing

Access to all bedrooms and family bathroom. Built in storage.

### Bedroom One



UPVC window to front.

### **Bedroom Two**

UPVC window to rear.

### **Bedroom Three**

UPVC window to rear.

### **Bathroom**

Fitted with a three piece suite comprising of bath with shower over, WC and wash basin, Obscure window to front.

### **Outside**

#### **Front**

To the front of the property is a walled front garden with path leading to the front of the property and side access to the rear

#### **Rear**

To the rear of the property is an enclosed garden with patio and decked area and benefits from garage with access from the rear lane and garden.

## Floorplan

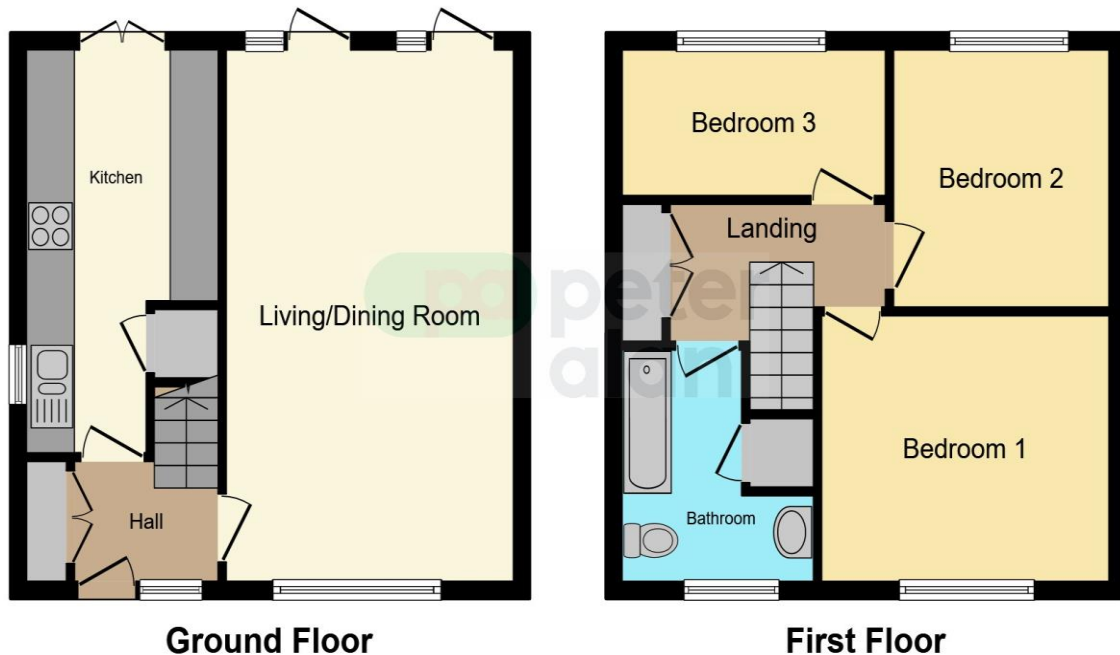

This floorplan is for illustrative purposes only and is not drawn to scale. Measurements, floor-areas, openings and orientations are approximate. They should not be relied upon for any purpose and do not form any part of an agreement. No liability is taken for any error or mis-statement. All parties must rely on their own inspections.

## Important Information

Note while we endeavour to make our sales details accurate and reliable, if there is any point which is of particular interest to you, please contact the office and we will be pleased to confirm the position for you. We have not personally tested any apparatus, equipment, fixtures, fittings or services and cannot verify they are in working order or fit for their purposes. Nothing in these particulars is intended to indicate that carpets or curtains, furnishings or fittings, electrical goods (whether wired or not), Gas fires or light fittings or any other fixtures not expressly included form part of the property offered for sale. This computer generated Floorplan, if applicable, is intended as a general guide to the layout and design of the property. It is not to scale and should not be relied upon for dimensions. Tenure: We cannot confirm the tenure of the property as we have not had access to the legal documents. The buyer is advised to obtain verification from their solicitor or surveyor.

Peter Alan Limited is registered in England and Wales under company number 2073153, Registered Office is Cumbria House, 16-20 Hockliffe Street, Leighton Buzzard, Bedfordshire, LU7 1GN. VAT Registration Number is 500 2481 05. For activities relating to regulated mortgages and non-investment insurance contracts, Peter Alan Limited is an appointed representative of Connells Limited which is authorised and regulated by the Financial Conduct Authority. Connells Limited's Financial Services Register number is 302221. Most buy-to-let