



## Landmark Place, offers in excess of £135,000

- Cash Buyers Only
- No Onwards Chain
- Current Rental Return £900pcm
- City Centre Location
- Lifts To All Floors
- Concierge Service
- Close To Local Amenities
- Walk Distance To Shops and Train Station
- EPC Rating: C







## About the property

This one bedroom apartment is the ideal investment right in the heart popular location of Cardiff's city centre. The vibrant city centre offers heaps of attractions, ample retail stores and a variety of restaurants to choose from. Approximate rental return of £900pcm

## Accommodation

### Communal Hall

Enter into communal hall. Concierge service. X2 lifts to all floors.

### Hall

Enter into apartment hallway. Access to call rooms. X2 single storage cupboards. One housing water tank, one offering additional storage.

### Lounge

15' 4" x 13' 1" ( 4.67m x 3.99m )

Floor to ceiling window. Open plan to kitchen.





## Bedroom One

111' 4" x 9' 11" ( 33.93m x 3.02m )

Floor to ceiling window. Built in double wardrobes.

## Bathroom

Fitted with a three piece suite comprising bath with shower over, WC and wash hand basin.

## Kitchen

9' 9" x 6' 2" ( 2.97m x 1.88m )

Fitted with a range of base and eye level units with worktops over. Built in oven, hot plate, hob and cooker hood. Integral fridge/freezer and washing machine.

## Floorplan

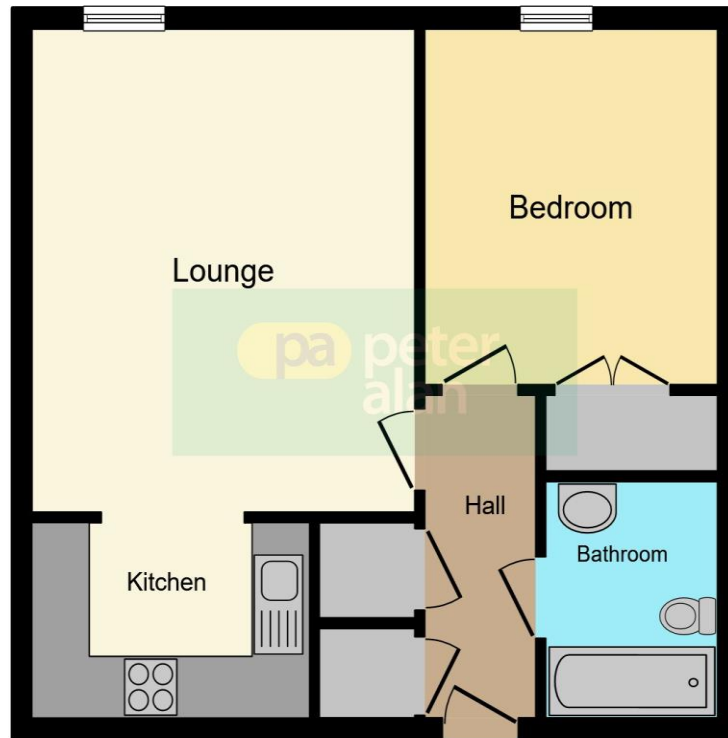

This floorplan is for illustrative purposes only and is not drawn to scale. Measurements, floor-areas, openings and orientations are approximate. They should not be relied upon for any purpose and do not form any part of an agreement. No liability is taken for any error or mis-statement. All parties must rely on their own inspections.

## Important Information

Note while we endeavour to make our sales details accurate and reliable, if there is any point which is of particular interest to you, please contact the office and we will be pleased to confirm the position for you. We have not personally tested any apparatus, equipment, fixtures, fittings or services and cannot verify they are in working order or fit for their purposes. Nothing in these particulars is intended to indicate that carpets or curtains, furnishings or fittings, electrical goods (whether wired or not). Gas fires or light fittings or any other fixtures not expressly included form part of the property offered for sale. This computer generated Floorplan, if applicable, is intended as a general guide to the layout and design of the property. It is not to scale and should not be relied upon for dimensions. Tenure: We cannot confirm the tenure of the property as we have not had access to the legal documents. The buyer is advised to obtain verification from their solicitor or surveyor.

Peter Alan Limited is registered in England and Wales under company number 2073153, Registered Office is Cumbria House, 16-20 Hockliffe Street, Leighton Buzzard, Bedfordshire, LU7 1GN. VAT Registration Number is 500 2481 05. For activities relating to regulated mortgages and non-investment insurance contracts, Peter Alan Limited is an appointed representative of Connells Limited which is authorised and regulated by the Financial Conduct Authority. Connells Limited's Financial Services Register number is 302221. Most buy-to-let